

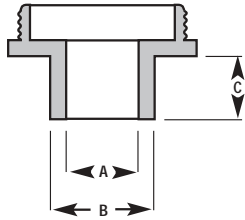

HEAVY-DUTY ROUTER ACCESSORIES



TEMPLATE GUIDE KIT - 9 PIECE

49-54-0700 Kit includes case, 7 template guides - 1 of each and 2 lock-nuts.



CATLOG NO.	PURPOSE	QTY PKG*	(A) INNER DIM.	(B) OUTER DIM.	(C) DISTANCE PAST BASE	W			D			WEIGHT (LBS.)
						x	x	x	x	x	x	
49-54-0710	Dovetail 1/4" + lock-nut	1	1/4"	5/16"	5/32"	5.6"	x	3.8"	x	.8"		0.15
49-54-0715	General Routing + lock-nut	1	9/32"	3/8"	5/16"	5.6"	x	3.8"	x	.8"		0.15
49-54-0720	Dovetail 1/2" & General Routing + lock-nut	1	11/32"	7/16"	5/32"	5.6"	x	3.8"	x	.8"		0.15
49-54-0725	General Routing + lock-nut	1	13/32"	1/2"	5/16"	5.6"	x	3.8"	x	.8"		0.15
49-54-0730	General Routing + lock-nut	1	17/32"	5/8"	9/16"	5.6"	x	3.8"	x	.8"		0.15
49-54-0735	Hinge Butt Routing + lock-nut	1	5/8"	51/64"	9/16"	5.6"	x	3.8"	x	.8"		0.15
49-54-0740	Lock Face Routing + lock-nut	1	21/32"	3/4"	9/16"	5.6"	x	3.8"	x	.8"		0.15
44-40-0170	Lock Nut For Template Guides	1	-	-	-	.3"	x	1.4"	x	1.4"		0.04

*Not available in Masterpacks

ROUTER EDGE GUIDE

49-54-1035



- Tough all-metal construction for strength and durability.
- Micro-fine adjustment dial ensures precise routing to within 1/128th.
- Innovative guide design provides maximum capacity and consistent accuracy.
- Extra-long mounting rods for maximum cut capacity (9" from board edge).
- Extra-wide, steel guide fence with auxiliary mounting holes enhanced control and maximum capacity.
- Large, comfortable set screws for comfort and convenience.

COLLET & NUT ASSEMBLIES

For Milwaukee Routers; No's. 5615, 5616, 5619 and 5625.

- 48-66-1015 1/4" Collet & nut assemblies
- 48-66-1020 1/2" Collet & nut assemblies



COLLETS FOR PREVIOUS MILWAUKEE ROUTERS 1.5 and 2.0 MAX. HP MODELS

For Milwaukee Routers; No's. 5610, 5620, 5650, 5660, 5670, 5680, 5681 and 5682.

- 48-66-0985 1/4" Collet
- 48-66-1000 3/8" Collet
- 48-66-1010 1/2" Collet

BODYGRIP BASE ASSEMBLY

48-10-5615 For all BodyGrip® units (5615 & 5616 series). Base includes BodyGrip® with adjustable handstrap, 2-1/2" center hole sub-base, two handles and motor lock lever.



D-HANDLE BASE ASSEMBLY

48-10-5619 For 1-3/4 max horsepower D-Handle units (5619). Base includes D-Handle, 2-1/2" center hole sub-base, one handle and motor lock lever.



BASE ASSEMBLY

48-10-5625 For 3-1/2 max horsepower fixed base unit (5625-20). Base includes two tactile grip, removable handles, 2-1/2" center hole sub-base and motor lock lever.



SUB-BASES

- Black**
- 49-54-1040* 6" dia., 1-3/16" Center hole sub-base
- 49-54-1045* 6" dia., 2-1/2" Center hole sub-base
*For use with 5615, 5616 and 5619
- Clear**
- 49-54-1025** 7" dia., 2-1/2" Center hole clear sub-base
- 49-54-1026** 7" dia., 1-3/16" Center hole clear sub-base
**For use with 5625



ROUTERSTATION™

48-55-5620

Durable router and accessory storage unit and/or replacement base for router case (48-55-5615). Permits router storage with installed bit and pre-set height adjustment. Fastens quickly to any flat surface. On-board collet wrench and router bit storage. (Patent pending.)



IMPACT RESISTANT CARRYING CASE

48-55-5615

Standard equipment for 5615-21 and 5616-21 Kits. Impact resistant carrying case with exclusive integral RouterStation™

- Case features on-board wrench and collet storage
- Removable base for convenient, reliable router storage



ABOVE-THE-TABLE DEPTH WRENCH

49-96-0370 3/8" Hex drive wrench for use with above-the-table depth adjustment system - all models.



COLLET WRENCH

49-96-0365 1-1/8" Forged collet wrench



DOOR AND JAMB BUTT TEMPLATE KIT

49-54-0101 Includes case, template, link rail assemblies, template nails, end gauges and hinge butt guide No. 49-54-0730 for use with MILWAUKEE Routers. Will mortise any 6'6", 6'8" or 7" door and any hinge size 2-1/2" to 5-1/2". Detailed instructions included. Additional template nails (12 per package) are available (No. 49-54-0600).

