



# HEAVY-DUTY SAWZALL® KIT

WORLD'S LONGEST LASTING RECIPROCATING SAWS



6519-22



10.0 AMP MOTOR  
1-1/8" BLADE STROKE

INCLUDES GEAR PROTECTING CLUTCH\*



- 1 QUIK-LOK BLADE CLAMP\* SYSTEM
- 2 POWERFUL 10.0 AMP MILWAUKEE-BUILT MOTOR
- 3 FULL WAVE SWITCH FOR SMOOTHER OPERATION
- 4 TRIGGER SPEED CONTROL FOR THE BEST OPERATOR CONTROL
- 5 QUIK-LOK® CORD
- 6 KEYLESS SHOE ADJUSTMENT LEVER
- 7 RUBBER BOOT FOR SUPERIOR GRIPPING
- 8 HEAVY-DUTY DOUBLE BEARING WOBBLE PLATE MECHANISM

- 1-1/8" Blade Stroke
- Exclusive Gear Protecting Clutch\*

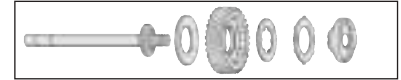

Unique gear clutch absorbs high impact forces caused by sudden blade lock-ups. Extends life of tool in extreme cutting applications.

- Shoe Release Lever\*  
Adjusts shoe without use of tools. Allows more efficient use of blade and depth-of-cut control.
- Pivot Shoe for Maximum Support Against Work Surface
- 0-2800 Strokes Per Minute With Trigger Speed Control
- Powerful 10.0 Amp Milwaukee-Built Motor
- 8' 3-Wire Quik-Lok® Cord  
Instant field repair and safe replacement.
- Easy Plunge Cutting With No Starting Hole
- Reverse the Blade for Cutting Upside Down in Confined Areas
- Textured Rubber Boot For Superior Gripping And Operator Comfort
- All Ball And Roller Bearings



- Heavy-Duty Steel Quik-Lok™ Blade Clamp System\*
  - Fast easy blade changes with no hex key to lose.
  - Blades may be clamped upside down.
  - Accepts standard 1/2" shank Sawzall blades.

\*Patented



Ideal for plunge cutting, pipe cutting and demolition into metal, wood, fiberglass, cast iron and many other materials.

**AVAILABLE CORDLESS**  
SEE PAGE 17 FOR 18V SAWZALL

## SPECIFICATIONS

CATALOG NUMBER	VOLTS AC ONLY	AMPS	LENGTH OF STROKE	STROKES PER MINUTE	OVERALL LENGTH	NET WGT. LBS.	SHIP. WGT. LBS.
6519-22	120	10.0	1-1/8"	0-2800	17.9"	7.0	11.3

STANDARD EQUIPMENT: FOR 6519-22 – 8' 3-Wire Quik-Lok Rubber Cord, Impact Resistant Carrying Case 48-55-1503, One Wood Cutting Sawzall Blade And One Metal Cutting Sawzall Blade.