

AERO-MOTIVE COMPANY

A Woodhead Industries, Inc. Subsidiary



## IMPORTANT SAFETY INSTRUCTIONS

Please read this manual carefully and follow its instructions. Improper use or failure to follow these instructions could result in serious injury, death or property damage. Operators should be instructed in the safe and proper use and maintenance of this product. Keep this manual for future reference.

The following safety precautions call attention to potentially dangerous conditions.

**DANGER:** Immediate hazards which **WILL** result in severe personal injury or death.

**WARNING:** Hazards or unsafe practices which **COULD** result in severe personal injury or death.

**CAUTION:** Hazards or unsafe practices which **MAY** result in *minor* personal injury or product or property damage.

**NOTE:** Instruct operators in the safe, proper use and maintenance. Keep this manual for future reference.

## INSTALLATION

**WARNING:** Failure to read, understand, and follow these instructions may result in hazards or unsafe practices **COULD** result in severe personal injury or death.

**CAUTION:** Operators need to be instructed on the safe, proper use and maintenance of this product. Keep this manual for future references. Hazards or unsafe practices **MAY** result in *minor* personal injury or product or property damage.

## MOUNTING

Bench Jib mounts directly to standard workbenches or stations. Mount base to bench with 3/8" bolts, (length to suit). Drill three holes in bench or station, on a 4" diameter, 120° apart. Base may be used as a template for hole locations. The bench clamp may do optional mounting. This eliminates drilling of mounting holes in bench. Bench Jib has a reach of 24" (610mm) on standard models. Optional torque arm may be used to absorb the tightening reaction of tool. The torque arm mounts to vertical column much the same way as the jib arm and manifold. Mount torque arm to vertical column before main jib arm is mounted. Adjust height to working position of power tool. Torque arm operates to within 6" of and up to 28" away from vertical column.

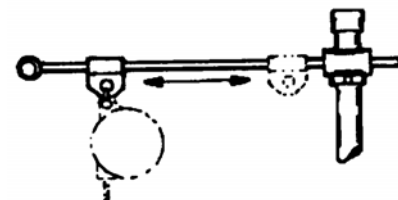
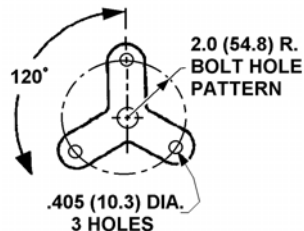
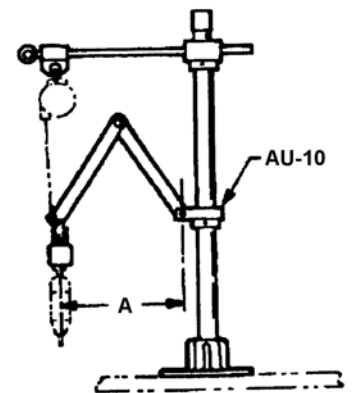

---

## **OPERATION**

### **TOOL BALANCER**

Attach top hook of balancer to slide hanger on jib arm for horizontal motion. For stationary applications, mount tool balancer to ring at end of jib arm. Clip power tool to tool clip of balancer and adjust balancer to proper tension with tool.

### **AIR SUPPLY**

**NOTE:** Before mounting base, when running hose through column, drill a 1" hole in the workbench.

Air hose is connected from the 1/4" NPT port on manifold to inlet port of power tool. Main air supply is connected to back of manifold at 1/2" NPT port. Main airline may also be connected directly to power tool. Air hose line can be run through ring at end of jib arm or attached to ring with a tie wrap. The hose may also be routed through vertical column. When using optional torque arm, tools are connected to the bottom of tool holder at the 1/4" NPT port. Air hose inlet is connected to the 1/4" NPT port on the side of tool holder.

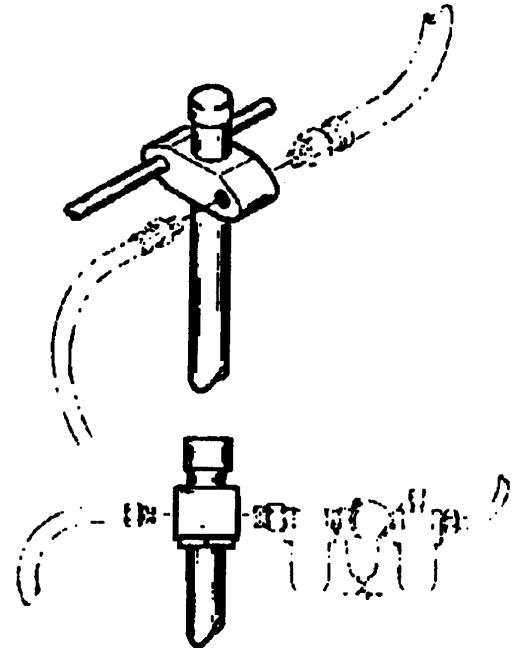

### **ADJUSTMENT**

Bench Jib unit may be adjusted up and down on vertical column by loosening set screw on front of manifold and loosening set screw on collar. Leaving set screw loose on manifold will allow jib arm to swing in a 360° rotation. Maximum height of jib arm is 46.2" (1174mm). Jib arm may be adjusted back and forth by loosening setscrew on bottom of manifold.

## **SERVICE**

### **LUBRICATION**

No additional lubrication is required.

### **PARTS REPLACEMENT**

All parts are replaceable in the field without special tools. Always remove balancer and shut off air supply before attempting to disassemble parts.

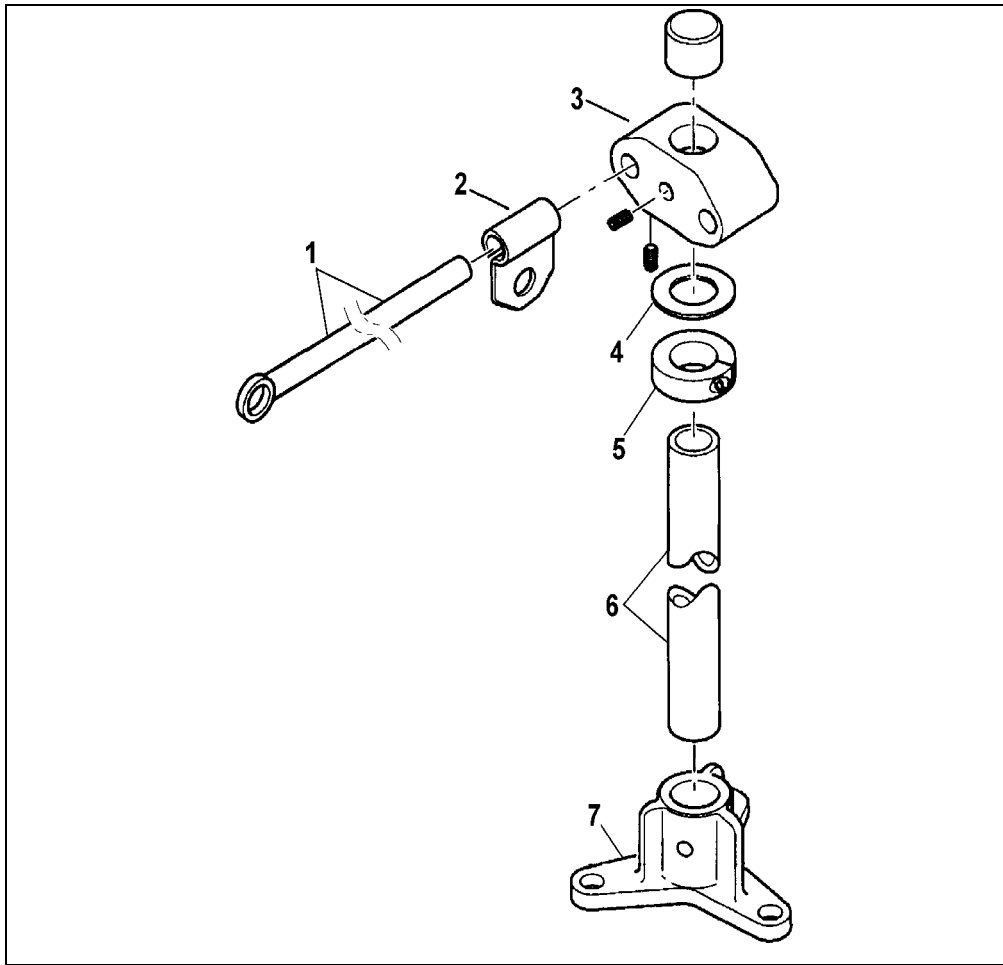

Reference Number	Part Number	Qty.	Description
1	BJ63	1	Arm; Jib
2	BJ64	1	Hanger; Slider
3	BJ62	1	Manifold & Screws
4	M83010018	1	Washer; Thrust
5	BJ66	1	Collar
6	BJ61	1	Column; Vertical
7	BJ60	1	Mounting Base & Screws

**Aero-Motive Company**

**W** A Woodhead Industries Inc. Subsidiary  
 PO Box 2678  
 Kalamazoo, MI 49003-2678  
 (616) 337-7700  
 (800)-999-8559  
 FAX: (800) 333-6119

**AKAPP Electro Industrie**

**W** A Woodhead Industries Inc. Subsidiary  
 Nijverheidsweg 14 Box 54  
 NL-3771 ME Barneveld  
 NL-3771 AB Barneveld  
 Holland  
 011-31-3420-14022  
 FAX: 011-31-3420-92384

**Aero-Motive (UK) Limited**

**W** A Woodhead Industries Inc. Subsidiary  
 Rassau Industrial Estate  
 Ebbw Vale Gwent NP3 5SD  
 United Kingdom  
 (0495) 350436  
 FAX: (0495) 350877

**Woodhead Asia PTE LTD**

**W** A Woodhead Industries Inc. Subsidiary  
 401 Commonwealth Drive #04-04  
 Haw Par Technocentre  
 Singapore 0314  
 (65) 479 6533  
 FAX: (65) 479 3588

**Woodhead Canada LTD.**

**W** A Woodhead Industries Inc. Subsidiary  
 1090 Brevik Place  
 Mississauga Ontario  
 L4W 3Y5 Canada  
 (905) 624-6518  
 FAX: (905) 624-9151