



Safety

Please read this manual carefully and follow its instructions. Improper use or failure to follow these instructions could result in serious injury, death or property damage. Operators should be instructed in the safe and proper use and maintenance of this product. Keep this manual for future reference.

The following safety precautions call attention to potentially dangerous conditions.

- | | |
|--|--|
| | WARNING: Warnings are used when hazards exist which could result in serious injury, death or property damage if proper precautions are not taken. |
| | CAUTION: Cautions are used as reminders of safety hazards which could result in personal injury or property damage if proper precautions are not taken. |

Installation

- A. Mounting. Reel may be mounted base up, base down, or in any position which allows main shaft to be horizontal. Reel should be mounted with centerline of drum in line with hose run.
- B. Installation of output hose. Insert hose between drum flanges, through hose clamp (8) and through slot in flange adjacent to hose clamp (8). Hose can then be connected to swivel (20). Allow for adequate slack between hose clamp and swivel so that all hose tension is removed from swivel and absorbed at the hose clamp.
- C. Installation of input hose. Input hose is installed at opposite end of main shaft from swivel.
- D. Secondary safety chain. A secondary safety chain should always be connected to reel and be properly secured to prevent reel from accidentally falling when mounted overhead.

Operation

- A. Spring tension. After hose is installed on reel and before permanent connections are made at free end of hose, pretension reel by pulling hose out far enough to allow one full wrap of hose to be thrown back over spool. Hold spool from turning while hose is placed back over spool. One set up turn has now been applied. Repeat until desired tension is reached. After tension is set, pull hose out completely to insure enough spring travel remains for operating. Failure to test in this manner can lead to spring damage.
- B. Ratchet lock. Optional ratchet lock (A) is of gravity type and is furnished with counterweight fastened to ratchet dog. When mounted on wall or with the base down, counterweight (52) is left attached. When mounted base up, counterweight must be removed.
- C. Hose guide. Optional four roller hose guide (71) should always be mounted so that hose pays off from spool in a straight line through the guide. Hose should not be bent around guide at sharp angles nor should the guide be used as a sheave.

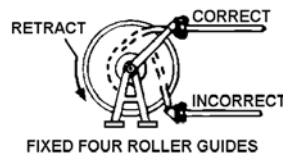

Service

CAUTION: Before attempting any service, always cut off all supply input and remove all spring tension.

- A. Main motor springs
1. If reel will not develop spring tension, it is possible a main spring(s) (11) has broken. To replace main spring(s), remove swivel (20) and collar (19). Remove bolts (25) and lift off end plate (15). Drive ring (14) may come off with end plate. Remove spacer (13).
 2. Drum and flange assembly (6) may now be removed exposing spring cups (48). Remove each spring and cup assembly as a single piece.
- CAUTION:** Never allow spring to be pulled by its center. Springs are riveted at the outer band and may be removed from cups as long as the rivet is intact. If rivet is broken, do not remove spring from the cup. Consult factory immediately.
3. Replace broken spring(s), apply a light coat of grease to spring, and reassemble by reversing the above, making sure all components are replaced in proper order. Be sure to apply spring tension to reel once it is completely assembled as described in "Spring tension".
- B. Swivel assembly. If leaks should develop in swivel (20), replace entire unit.

Replacement Parts

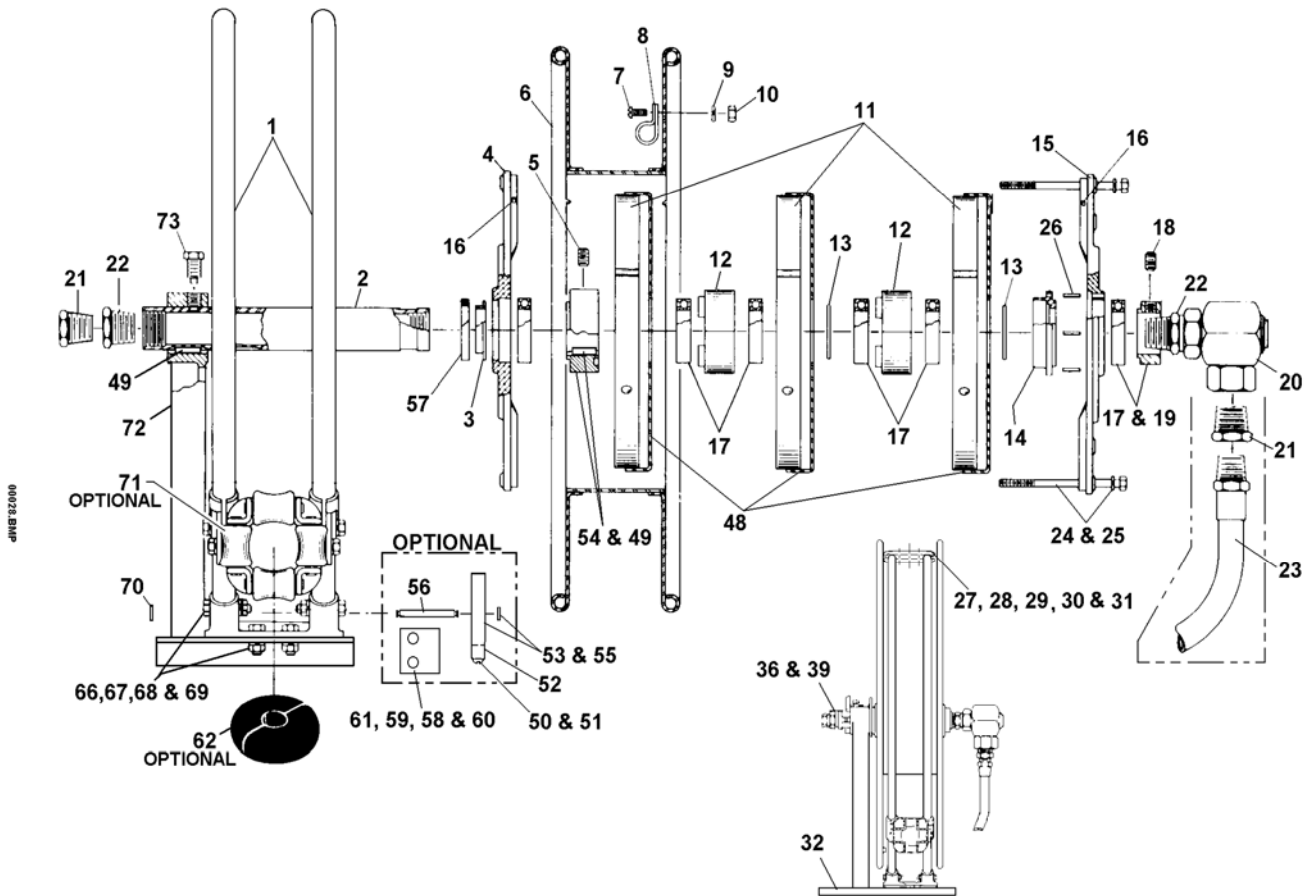

Reference Number	Part Number	Qty.	Description
1	1-R	1	Guide rail, 41832 -- 1100, D863
	2-R	1	Guide rail, 40729 -- 1200, D865, 866, 883
	3-R	1	Guide rail, 40729-1, 49285-3 -- 1400, D985
2	59480-3	1	Main shaft - 1200, 1400p; 3 spr -- D865=D985
	59480-5	1	Main shaft - 1200, 1400; 5 spr
	59480-7	1	Main shaft - 1100, 2 spr
	59480-8	1	Main shaft - 1100, 3 spr -- D863

	59480-9	1	Main shaft - 1100, 4 spr
3	42919	1	Bearing
4	40602-1	1	End plate
5	53-P-502	1	Set screw 3/8-16 x 1/2
6	42904-2	1	Drum and flange - 1142-xx-xxx
	42904-3	1	Drum and flange - 1143-xx-xxx
	42904-4	1	Drum and flange - 1163-xx-xxx
	42904-5	1	Drum and flange - 1164-xx-xxx
	42904-8	1	Drum and flange - 1142-xx-xxx-L
	42904-9	1	Drum and flange - 1143-xx-xxx-L
	42904-10	1	Drum and flange - 1163-xx-xxx-L -- D863
	42904-11	1	Drum and flange - 1164-xx-xxx-L
	40621-5	1	Drum and flange - 1253-xx-xxx
	40621-7	1	Drum and flange - 1255-xx-xxx
	40621-1	1	Drum and flange - 1253-xx-xxx-L -- D865
	40621-2	1	Drum and flange - 1255-xx-xxx-L
	40783-405	1	Drum and flange - 1443-xx-xxx
	40783-407	1	Drum and flange - 1445-xx-xxx
	40783-707	1	Drum and flange - 1475-xx-xxx
	40783-1	1	Drum and flange - 1443-xx-xxx-L -- D985
	40783-2	1	Drum and flange - 1445-xx-xxx-L
	40783-4	1	Drum and flange - 1475-xx-xxx-L
7	2-P-408	1	Screw, round head #10-24x1/2
8	C39810214	1	Clamp 1/4" ID hose
	C39810215	1	Clamp 3/8" ID hose
	C39810219	1	Clamp 1/2" ID hose
	C39810222	1	Clamp 3/4" ID hose
	C39810224	1	Clamp 1" ID hose
9	101-P-15	1	Lock washer #10
10	151-P-25	1	Nut, HEX #10-24
11 *	43782-105/205	AR	Main spring - xxxx-05-xxx -- D866
	43782-110/210	AR	Main spring - xxxx-10-xxx
	43782-110/210	AR	Main spring - xxxx-08-xxx -- D985, D883, D863
	43782-116/216	AR	Main spring - xxxx-16-xxx -- D865
	43782-117/217	AR	Main spring - xxxx-17-xxx
12	59741-1	AR	Rotating hub -- see Kit B
13	40119	AR	Spacer
14	40176	1	Drive ring
15	59490	1	End plate
16	230-P-105	2	Drive pin .094 x .375
17 *	40005	AR	Bearing -- see Kit B
18	11-P-19	1	Set screw 3/8-16x1/2
19	59479	1	Collar, lock
20 *	666-P-32	1	Swivel - xxxx-xx-002, 003, 004
	666-P-38	1	Swivel - xxxx-xx-006, 008 -- D863=D985
21	669-P-35	2	Reducer - xxxx-xx-002, 004, 1x1/2
	669-P-30	2	Reducer - xxxx-xx-003, 1x3/8
	669-P-54	2	Reducer - xxxx-xx-006, 1x3/4 -- D863=D866
	not required	--	xxxx-xx-008
22	669-P-10	2	Reducer - xxxx-xx-002, 1/2x1/4
	not required	--	on all other models
23	---	1	Hose assembly - optional - specify length & ID & consult factory
24	101-P-30	6	Lock washer 1/4 x .062
25	40143-29	6	Bolt - 2 spring models
	40143-32	6	Bolt - 3 spring models -- D863=D985
	40143-36	6	Bolt - 4 spring models
	40143-12	6	Bolt - 5 spring models
26	230-P-122	4	Drive pin .156x.625
27	35P14	2	Screw, 5/16-18x1-1/4 -- 1200, 1400 only -- D865=D085
28	101-P-14	2	Lock washer, 5/16 -- 1200, 1400 only -- D865=D985
29	151-P-75	2	Nut 5/16-18 - 1200, 1400 only -- D865=D985
30	61105	2	Spacer - 1200, 1400 only -- D865=D985
31	60793	2	Tie bar 4 inch
	60794	2	Tie bar 7 inch
32	H22110358	1	Stand weldment -- 1200
	H22110359	1	Stand weldment -- 1400

36	4026900001	1	Collar -- 1200,1400 only -- D865 = D985
39	00031P0030	1	Screw Hex Head 5/16 - 18 x 1 1/2 -- 1200,1400 only -- D865 = D985
48	40696	1/spr	Spring cup
49	40773-2	2	Key
50	101-P-30	1	Washer 1/4x.062 -- see Kit A - optional - 1200, 1400 only
51	2-P-506	1	Screw, round head 1/4-20x3/4 -- See Kit A optional -- 1100 only
	30-P-110	1	Screw 1/4-20x3/4 - See Kit A, hex head optional - 1200 only -- D865=D985
	30-P-122	1	Screw 1/4-20x1-1/4 optional -- 1400 only
52	40029	1	Weight - Kit A optional - 1100 only D863
	43276-1	1	Brass weight - Kit A optional - 1200, 1400 only -- D865=D985
53	42907-1	1	Brass ratchet - Kit A optional - 1100 only -- D863
	43987-1	1	Brass ratchet - Kit A optional - 1200, 1400 only -- D865=D985
54	40185-1	1	Nonrotating hub - standard rot
	40744-1	1	Nonrotating hub - Rev rot
55	580-P-95	1	Retaining ring - Kit A optional - 1100 only -- D863
	580-P-30	1	Retaining ring - Kit A optional - 1200, 1400 only -- D865=D985
56	40027	1	Ratchet pin - Kit A optional - 1100 only -- D863
	M24460099	1	Ratchet pin - Kit A optional - 1200, 1400 only -- D865=D985
57	42920	1	Seal
58	230-P-134	2	Sel-Lok pin - Kit A optional - 1200, 1400 only -- D865=D985
59	31-P-45	2	Screw 5/16-18x1 - Kit A optional hex head
60	101-P-14	2	Lock washer 5/16 - Kit A optional
61	M40570038	1	Block - Kit A - 1200, 1400 only -- D865=D985
62	ST-1	1	Hose stop - .430 - .750 OD - optional
	ST2	1	Hose stop - .750 - .875 OD - optional
	ST-3	1	Hose stop - 1.00 OD - optional
	ST-4	1	Hose stop - 1.25 OD - optional
	ST-5	1	Hose stop - 1.50 OD - optional
66	126-P-50	4	Flat washer 1/4
67	151-P-20	4	Nut 1/4-20
68	30-P-117	4	Screw, hex head 1/4-20 x 1
69	00101P0030	4	Lock washer 1/4 x .062
70	580-P-15	1	Retaining ring - Kit A optional - 1100 only -- D863
71	2-F	1	Roller guide - optional - Use 2FRE, 2FYE
72	H22110388	1	Stand - 1100-xx-xxx
	H22110388	1	Stand - 1100-xx-xxx-L -- D863
	59492	1	Stand - 1200-xx-xxx
	59494	1	Stand - 1200-xx-xxx-L -- D865=D883
	59889	1	Stand - 1400-xx-xxx
	59891	1	Stand - 1400-xx-xxx-L -- D985
73	40680	1	Screw, set
			SERVICE KITS
A	2-LA	1	Ratchet lock - 1100 - includes 50 through 53, 55, 56, 57 -- D863
	42906-1		
	2-LB	1	Ratchet lock - 1200, 1400 - includes 50 through 53, 55, 56, 57 -- D865=D985
	40712		
B	59744-1	1	Rotating hub assembly - includes one 12 and one 17 assembled

* Recommended spare parts

Aero-Motive Company

W A Woodhead Industries Inc. Subsidiary
 PO Box 2678
 Kalamazoo, MI 49003-2678
 USA
 (269) 337 7700 / (800) 999 8559
 FAX: (800) 333 6119
www.aeromotive.com
techhelp@aeromotive.com

Woodhead Connectivity LTD.

W A Woodhead Industries Inc. Subsidiary
 Factory No. 9
 Rassau Industrial Estate
 Ebbw Vale Gwent NP23 5SD
 United Kingdom
 44-1495-356300
 FAX: 44-1495-356301
sales@wdhd.co.uk

Woodhead Asia PTE LTD.

W A Woodhead Industries Inc. Subsidiary
 No. 4 Toh Tuck Link
 Level 3 Mezzanine
 Markono Logistics Bldg.
 Singapore 596226
 65-6-261-6533
 FAX: 65-6-261-3588
sales@wasia.com.sg

Woodhead Canada LTD.

W A Woodhead Industries Inc. Subsidiary
 1090 Brevik Place
 Mississauga Ontario
 L4W 3Y5 Canada
 (905) 624-1079
 FAX: (905) 624-9151
www.woodhead.ca