



IMPORTANT SAFETY INSTRUCTIONS

Please read this manual carefully and follow its instructions. Improper use or failure to follow these instructions could result in serious injury, death or property damage. Operators should be instructed in the safe and proper use and maintenance of this product. Keep this manual for future reference.

The following safety precautions call attention to potentially dangerous conditions.



DANGER: Immediate hazards which **WILL** result in severe personal injury or death.



WARNING: Hazards or unsafe practices which **COULD** result in severe personal injury or death.



CAUTION: Hazards or unsafe practices which **MAY** result in *minor* personal injury or product or property damage.

NOTE: Instruct operators in the safe, proper use and maintenance. Keep this manual for future reference.

INSTALLATION



WARNING: Failure to read, understand, and follow these instructions may result in hazards or unsafe practices **COULD** result in severe personal injury or death.



CAUTION: Operators need to be instructed on the safe, proper use and maintenance of this product. Keep this manual for future references. Hazards or unsafe practices **MAY** result in *minor* personal injury or product or property damage.

MOUNTING

Some reels come complete with hose and are set at proper tension, ready to install. The fixed base of the reel allows mounting in several different positions including base up, base down, or wall mounted. Here are general mounting requirements:

- Main-shaft must be horizontal.
- Centerline of the spool assembly must be in line with the hose pull out.
- When mounted overhead in base up position, add a secondary chain, bracket or other safety device to prevent reel from falling in case the mounting bolts are removed or become loosened from vibration.

SECONDARY SUPPORT CHAIN



DANGER: A secondary safety cable or chain is to be attached to all reels mounted overhead to prevent reel from falling. Immediate hazards **WILL** result in severe personal injury or death.

All reels mounted over head should have a secondary support chain to protect personnel in case of structure or mounting component failure. Attach one end of secondary support chain or cable to secondary support point on reel. Attach other end of secondary support chain or cable to a support component other than that which supports the reel. The chain or cable should be as short as possible allowing reel to drop no more than 6 to 12 inches if the primary connection is released. A secondary support is offered as an accessory item.

SUPPLY HOSE

Assemble supply hose to main shaft . **Do not** use rigid pipe at input connection.

ADJUSTMENT

RATCHET LOCK

The Ratchet Lock works with reel mounted in any position and needs no adjustment. To disable ratchet, remove screw and slide ratchet plate in pivoting motion to opposite side. Re-install screw in new position

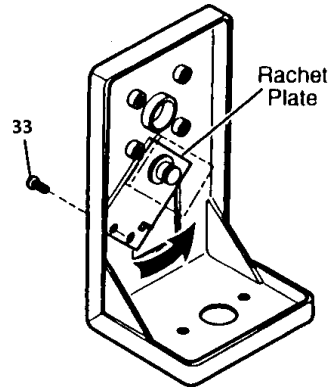

HOSE GUIDE ARM ADJUSTMENT

For maximum hose life, adjust guide arm so that the hose payout is in line with guide assembly. (See illustration below). To adjust the guide arm, remove three screws, and rotate guide arm 90 degrees to next group of mounting holes in stand assembly .

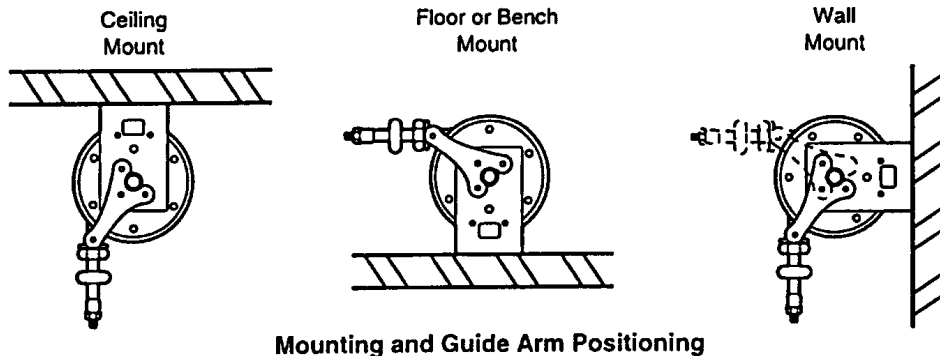

TENSION ADJUSTMENT

CAUTION: Failure to test for adequate spring revolutions can cause damage. Hazards or unsafe practices MAY result in *minor* personal injury or product or property damage.

NOTE: Pull hose out completely to insure enough spring revolution remain for operating. Always leave at least 1-2 turns between full extension and when the spring is wound tight (bottomed out). If entire hose assembly cannot be pulled out, decrease spring tension until full extension is possible.

Reels shipped with hose installed are pre-tensioned at the factory. Reels shipped without hose require pre-tensioning after hose is installed and *before* making final hose connections. To pre-tension hose reel, pull hose out far enough to allow one full wrap of hose to be looped back over drum assembly. Prevent drum from turning and loop hose back on drum. Repeat steps above until desired tension is achieved.

After tension is set, pull hose out completely to check spring travel. If full hose extension is not possible, remove pre-tension turns until full hose tension is possible. Failure to test in this manner may cause spring damage. Complete all hose connections.

SERVICE

WARNING: Before performing any service, always disconnect and lock out compressed air or fluid, & Remove all spring tension before attempting any service. Hazards or unsafe practices **COULD** result in severe personal injury or death.

HOSE INSTALLATION AND REPLACEMENT

NOTE: For M600 and H600, hose connects to external swivel, not the internal connection that is plugged. When replacing hose be sure all hose fittings and clamps are secure.

Remove all tension from reel (see Tension Adjustment). Remove ball stop and hose clamp from hose connection to swivel. Pull hose from barb fitting and from reel. Place new hose through roller guide, connect to swivel, wind on drum assembly, and re-tension reel. M600 and H600 reels often use crimped on hose fittings that require the hose and fitting be removed together.

MAINSRING, CUP & RATCHET ASSEMBLY REPLACEMENT

WARNING: Never, under any circumstances, remove spring from its spring pocket assembly. Replacement springs are assembled in a sealed assembly for safety and there is no need to remove them. Serious injury or death could result from removal of spring from its cartridge.

NOTE: Mainspring is completely self-contained and **safe** to handle.

If reel will not develop tension or retract hose, the main spring, cup, and ratchet assembly will need to be replaced. To replace main spring, cup and ratchet assembly, loosen set screw and drum assembly complete with main shaft from stand. Remove nuts and mainspring, cup and ratchet assembly from drum and replace. To reassemble, reverse above procedure. Align arrow on ratchet plate with notch on drum assembly.

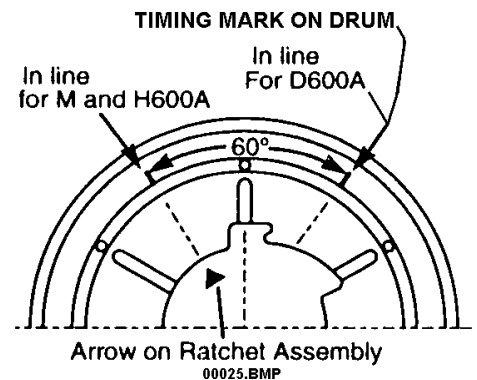

ORING REPLACEMENT

NOTE: For M600 and H600, replace entire swivel. O-rings are not repairable.

Loosen hose clamp and remove hose from fitting. Remove retaining ring, washer, nut and swivel. **Carefully** remove old O-Rings and discard. Clean all contamination from mainshaft and swivel. Install new O-Rings and apply light coat of commercial grease to main shaft and swivel. Remove all excess grease. Install swivel nut washer and retaining ring. Re-install hose to fitting and tighten clamp.

REPLACEMENT PARTS

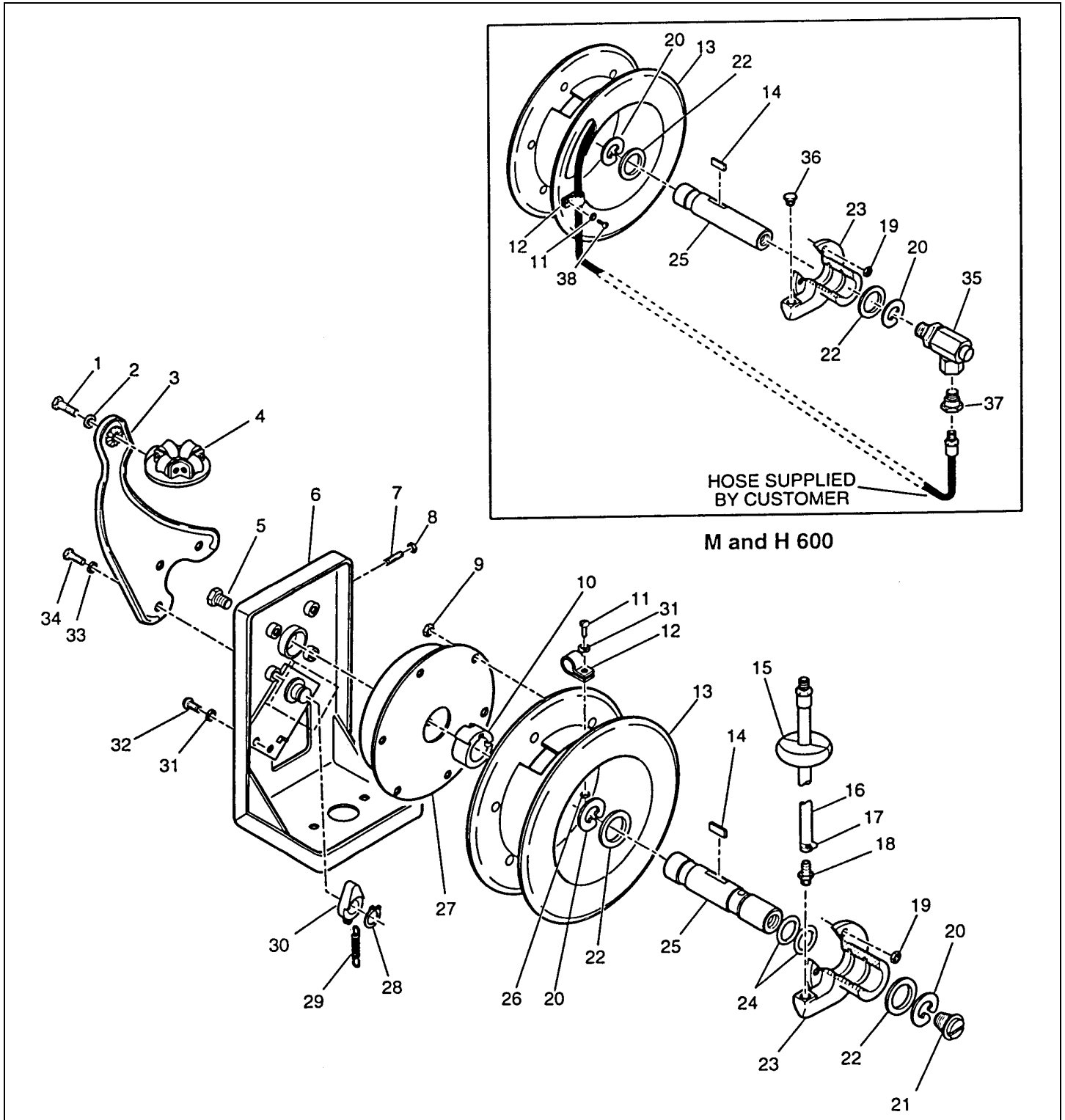

NOTE: M600 and H600, hose connects to external swivel #35, not internal connection that is plugged #36.

Reference Number	Part Number	Qty.	Description
1	00031P0025	1	Screw (5/16-19 x 1-1/4" hex)
2	00101P0014	1	Lock washer (5/16")
3	58784000YE	1	Guide arm
4	1FYE	1	Roller guide
5	00669P0041*	1	Reducer

6	58788000YE	1	Stand assembly	
7	4004500000	1	Set screw (5/16-19 x 3/8" RD. HD.)	
8	00151P0050	1	Jam nut (5/16-18)	
9	00160P0050	1	Lock nut (1/4-20)	
10	4031800003	1	Hub, spring	
11	00005P0110	1	Screw (1/4-20 x 3/8" RD. HD.)	
12	C39810213	1	Clamp for 1/4" ID hose	D620, D625
	C39810215	1	Clamp for 3/8" ID hose	D633
	C39810216	1	Clamp for M620	
	C39810219	1	Clamp for M630, H620	
13	58786000YE	1	Drum assembly	D600
	5906600000	1	Drum assembly	M600, H600
14	4077300007*	1	Key	
15	ST1	1	Hose stop (.43-.75" OD)	
	ST2	1	Hose stop (.75-.875" OD)	
16	H71180044	1	Hose assembly (3/8" ID x 35')	D633
	H71180045	1	Hose assembly (3/8" ID x 45')	D634
	H71180028	1	Hose assembly (1/4" ID x 50')	D625
17	00671P0010	1	Hose clamp	D600 only
18	00658P0035	1	Barb fitting	D634, D633
	00658P0049	1	Barb fitting	D625
19	00160P0050 *	1	Lock nut (10-24)	
20	00576P0046 *	2	Retaining ring	
21	00826P0301 *	1	Pipe plug	D600 only
22	4301000000 *	2	Washer	
23	M72420031 *	1	Swivel	
24	C47060120 *	2	O-ring	D600 only
25	M37700002 *	1	Main shaft	D600
	5906400000	1	Main shaft	M600
	M35660028	1	Main shaft	H620
26	00151P0025	1	Lock nut (1/4-20)	
27	5877100000	1	Main spring assembly	D600
	5877100005	1	Main spring assembly	M600, H600
28	00580P0050	1	Retaining ring	
29	C60610118	1	Ratchet spring	
30	5906100000	1	Ratchet lever	
31	00101P0015	1	Lock washer	
32	01137P0057	1	Screw (#10-24 x 1/2" Phil. HD.)	
33	00101P0030	3	Lock washer (1/4)	
34	00030P0111	3	Screw (1/4-20 x 5/8" hex)	
35	00666P0041	1	Swivel M600	
	B33130001	1	Swivel H600	
36	00827P0015	1	Pipe plug	M600, H600
37	00669P0033	1	Reducer	M620 only
38	00160P0050	1	Lock nut (1/4-20)	M600, H600
KIT	H26340003		Swivel Parts Kit;	D600A

includes asterisked (*) items

Aero-Motive Company

W A Woodhead Industries Inc. Subsidiary
PO Box 2678
Kalamazoo, MI 49003-2678
(616) 337 7700
(800) 999 8559
FAX: (800) 333 6119
www.aeromotive.com

AKAPP Electro Industrie

W A Woodhead Industries Inc. Subsidiary
Nijverheidsweg 14 Box 54
NL-3771 ME Barneveld
NL-3771 AB Barneveld
Holland
(31) 34 241 4022
FAX: (31) 34 249 2384
www.akapp.com

Woodhead Connectivity LTD.

W A Woodhead Industries Inc. Subsidiary
Factory No. 9
Rassau Industrial Estate
Ebbw Vale Gwent NP3 5SD
United Kingdom
(0495) 35 0436
FAX: (0495) 35 0877
sales@wdhd.co.uk

Woodhead Asia PTE LTD.

W A Woodhead Industries Inc. Subsidiary
401 Commonwealth Drive #04-04
Haw Par Technocentre
Singapore 0314
(65) 261 6533
FAX: (65) 479 3588
sales@wasia.com.sg

Woodhead Canada LTD.

W A Woodhead Industries Inc. Subsidiary
1090 Brevik Place
Mississauga Ontario
L4W 3Y5 Canada
(905) 624-6518
FAX: (905) 624-9151
www.woodhead.ca