

**STANLEY**

helps you do things right

**Stanley Hydraulic Tools**

Division of The Stanley Works  
3810 S.E. Naef Road  
Milwaukie, Oregon 97222  
Phone: 503/659-5660  
Telex: 360771

# PARTS LIST

**VO50**

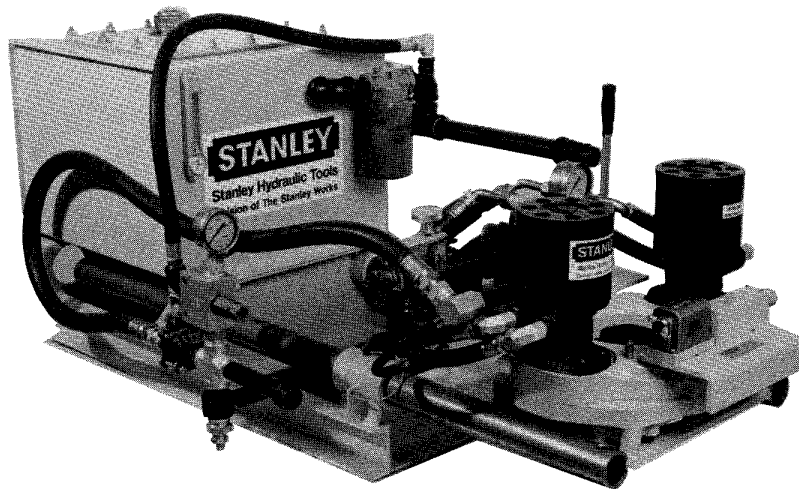

### SPECIFICATIONS

Weight (Dry) .....	370 lbs/168 kg
Length (Retracted) .....	51 in./129 cm
Length (Extended) .....	67 in./170cm
Width .....	30 in./76 cm
Height .....	23 in./58 cm
Torque .....	0-2400 lb ft/0-3264 N-m
Speed .....	5-30 rpm
Hydraulic Tank Capacity .....	22 gal./82.5 ltr

**MODEL VO50**

**HYDRAULIC  
VALVE OPERATOR**

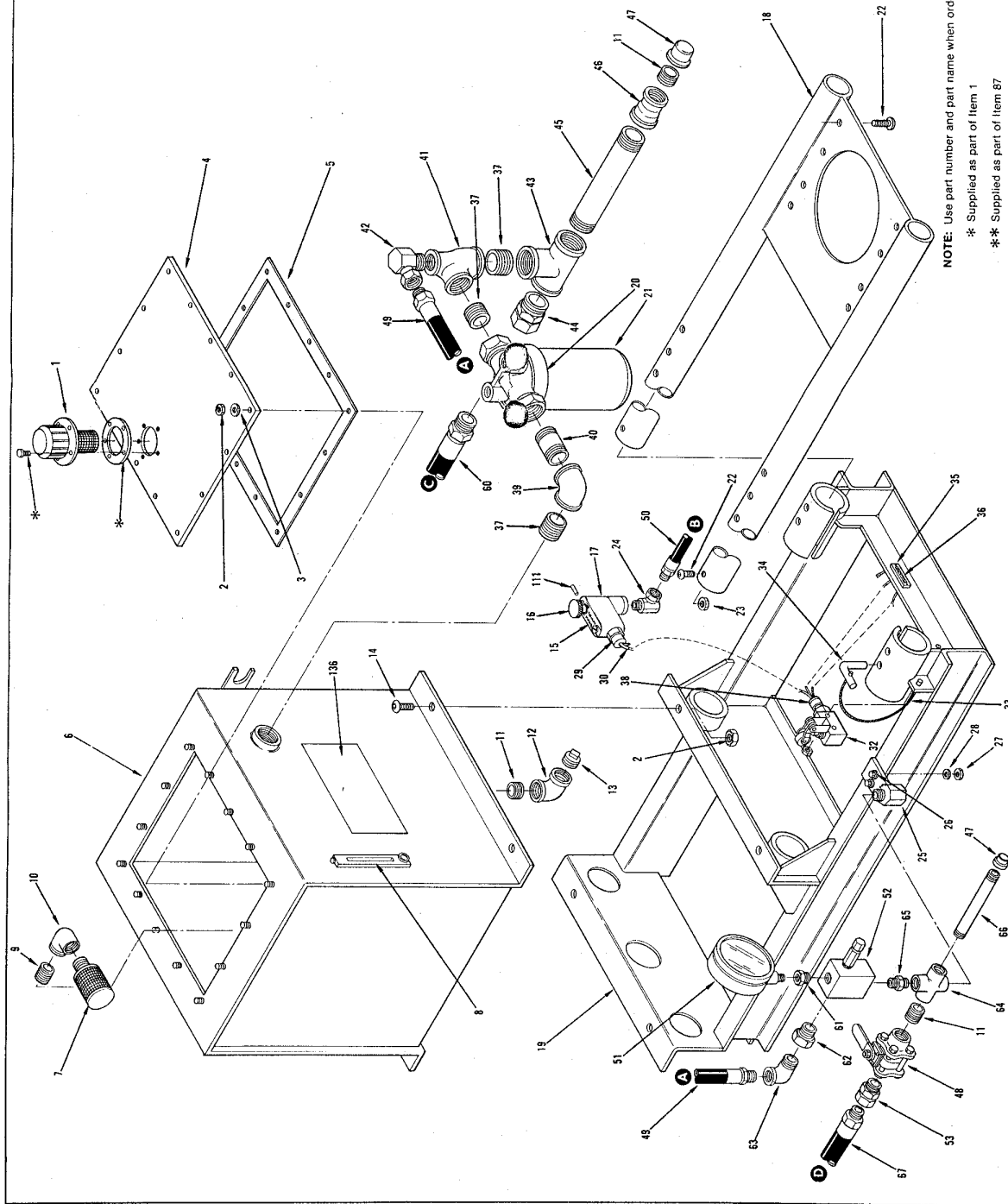

Item	Part No.	Qty.	Description
1	08729	1	Filter Cap and Breather Assy.
2	00147	19	Hex Nut, 3/8-16
3	04595	14	Flat Washer
4	08730	1	Tank Cover Plate
5	08731	1	Tank Gasket
6	08732	1	Tank Assembly
7	08733	1	Strainer
8	08734	1	Oil Level Gauge and Thermostat
9	08735	1	Close Nipple, 1-1/4
10	02066	1	Elbow, 1-1/4, 90°
11	04314	3	Close Nipple, 3/4"
12	02420	3	Elbow, 3/4", 90°
13	08736	1	Plug
14	08737	4	Button Hd. Cap Screw, 3/8-16 x 3/4
15	08738	1	Torque Control Decal
16	08657	1	Torque Control Knob
17	08739	1	Torque Control Assy.
18	08740	1	Sliding Base
19	08741	1	Frame Assy.
20	08742	1	Filler Assy.
21	08743	1	Filler Element
22	08744	10	Button Hd. Cap Screw, 1/2-13 x 1
23	08745	2	Hex Nut, 1/2-13
24	08746	1	Elbow
25	08747	1	High Pressure Hose Mounting Plate
26	02199	2	Hex Hd. Cap Screw, 1/4-20 x 1
27	00038	4	Lockwasher, 1/4
28	01298	4	Lockwasher, 1/4
29	08748	4	Cable Clamp
30	08749	1	Wire Loom
31	08750	1	Cable Clamp and Connector
32	08751	1	Micro Switch
33	08753	2	Pin Retaining Wire
34	08754	2	Slide Lock Pin
35	08755	1	Fuse Holder
36	08756	1	Fuse, 3 Amp, 12 Volt
37	05911	3	Nipple, 1", Close
38	08757	1	Cable Clamp
39	04288	1	Elbow, 1" x 3" Long
40	04291	1	Elbow, 90° Street w/Swivel
41	08758	1	Tee, 1"
42	08759	1	Swivel Adapter
43	05909	1	Nipple, 1" x 12" Long
44	08760	1	Reducer Coupling
45	08761	1	Cup, 3/4"
46	08762	2	Ball Valve
47	08763	1	Pressure Relief Hose
48	08764	1	Pressure Gauge
49	08765	1	Pressure Relief
50	08766	1	Swivel Adapter
51	08767	1	Drive Key
52	08768	1	Universal Socket
53	08769	1	Center Block
54	08770	2	Set Screw
55	08771	2	Socket Pin
56	08772	4	Universal Socket Pin
57	01607	2	Return Hose
58	08773	1	Pipe Bushing
59	08774	1	Pipe Bushing
60	08775	1	Elbow
61	08776	1	High Pressure Cross
62	08777	1	Hex Nipple
63	08778	1	High Pressure Nipple
64	08779	1	High Pressure Hose
65	02625	1	Elbow w/Swivel
66	08780	1	
67	08781	1	
68	08782	1	

NOTE: Use part number and part name when ordering.  
 # Supplied as part of Item 1  
 \*\* Supplied as part of Item 87

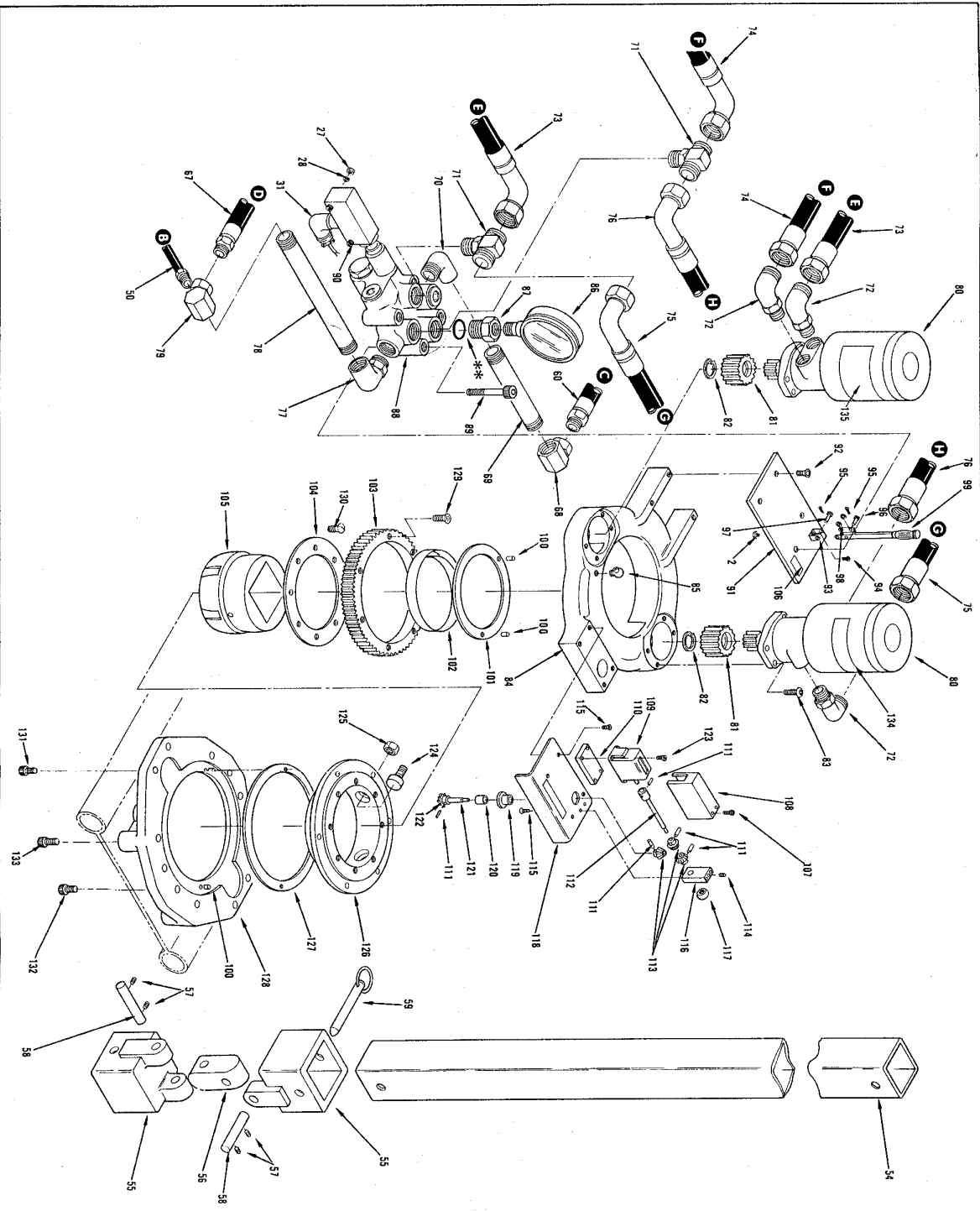

Item	Part No.	Qty.	Description
69	08783	1	Low Pressure Nipple
70	08784	1	Adjustable Elbow
71	08785	2	Adjustable Tee
72	08786	1	Adjustable Elbow
73	08787	1	Left Rear Motor Hose
74	08788	1	Left Front Motor Hose
75	08789	1	Right Front Motor Hose
76	08790	1	Right Rear Motor Hose
77	02148	1	Elbow, 90° Street
78	08791	1	High Pressure Nipple
79	08792	1	Elbow, 90° w/Swivel
80	08793	2	Motor
81	08794	2	Pinion Gear
82	08795	2	Retaining Ring
83	08796	8	Button Hd. Cap Screw
84	08797	1	Top Housing
85	08798	1	Grease Fitting
86	08799	1	Torque Gauge
87	08800	1	Bushing w/O-Ring
88	08801	1	Direction Control Valve
89	08802	4	Cap screw, 3/8-16 x 3-1/2 Hex Soc. Hd.
90	00208	2	Cap screw, 1/4-20 x 1-3/4 Hex Soc. Hd.
91	08803	1	Valve Mounting Plate
92	08804	3	Cap screw, 5/16-18 x 3/4 Hex Soc. Hd.
93	08805	1	Handle Base
94	08806	1	Cap screw, 3/8-16 x 3/4 Button Hd.
95	08807	2	Cotter Pin
96	08808	1	Pin
97	08809	1	Pin
98	02534	5	Flat Washer, 5/16
99	08810	1	Handle
100	08811	4	Dowel Pin, 1/4 x 3/8
101	08812	1	Upper Thrust Washer
102	08813	1	Gear Bushing
103	08814	1	Bull Gear
104	08815	1	Drive Knuckle Retaining Ring
105	08816	1	Drive Hub
106	08817	1	Direction Control Decal
107	08818	2	Machine Screw
108	08819	1	Counter Shroud
109	08820	1	Counter
110	08821	1	Counter Support Block
111	08822	6	Roll Pin, 3/32 x 5/8
112	08823	1	Counter Gear
113	08824	3	Counter Gear
114	08825	1	Detent Screw
115	00240	1	Machine Screw, 1/4-20 x 1/2 Flat Hd.
116	08826	6	Counter Shaft Support Block
117	08827	1	Knob
118	08828	1	Handle
119	08829	1	Shaft Bushing
120	08830	1	Shaft Spacer
121	08831	1	Counter Pinion Shaft
122	08832	1	Counter Pinion
123	08833	1	Machine Screw
124	08834	4	Drive Pin
125	08835	4	Hex Nut
126	08836	4	Gear Hub
127	08837	1	Lower Thrust Washer
128	08838	1	Bottom Housing
129	01525	6	Cap screw, 3/8-16 x 3/4 Soc. Hd.
130	08839	8	Cap screw, 5/16-18 x 1/2 Button Hd.
131	04723	1	Cap screw, 3/8-16 x 1 Soc. Hd.
132	06151	4	Cap screw, 3/8-16 x 1-1/4 Soc. Hd.
133	08840	6	Cap screw, 3/8-16 x 2-1/2 Soc. Hd.
134	08855	1	GPM Sticker
135	05152	1	Stanley Sticker, 2" x 4"
136	04650	1	Stanley Sticker, 12" x 6"

# MAINTENANCE INSTRUCTIONS

- Keep the side bars greased at all times to prevent rust and to ensure that the power head will slide easily.
- Lubricate the gear box with a soft automotive grease on a regular basis. Apply grease at each grease fitting.
- Check the oil level in the hydraulic tank by means of the sight gauge at the side of the tank. Add oil as necessary. Always keep the oil level at the **Full** mark on the gauge.
- Oil temperature should not exceed 140°F under prolonged or hard operation. If this temperature is exceeded, the hydraulic oil will break down and damage the hydraulic pump. If excessive temperature is encountered, consult Stanley Hydraulic Tools or an authorized Stanley Dealer.
- Change the filter at the top of the hydraulic tank once each year.
- Change the hydraulic oil every two years. A drain plug is provided at the bottom of the tank as shown in figure 3.
- The two hydraulic motors are lubricated by the hydraulic oil and, therefore, do not need additional lubrication.



**Stanley Hydraulic Tools**  
Division of The Stanley Works  
3810 S.E. Naef Road  
Milwaukie, Oregon 97222  
Phone: 503/659-5660  
Telex: 360771