

ITEM/P/NQTYDESCRIPTION

11	HOSE ASSY
2385301	HOSE ASSY
3385421	NIPPLE, 1 IN. X 3/4 IN.
4384982	ELBOW, 90°
53853615	NIPPLE, 3/8 IN. X 3/8 IN.
6392181	MODIFIED FITTING
7384991	ADAPTOR, 90°
8385261	HOSE ASSY
9385201	HOSE ASSY
10385386	HOLLOW BOLT, 3/8 IN.
11385221	HOSE ASSY
12385251	HOSE ASSY
13385241	HOSE ASSY
14385181	HOSE ASSY
151	HOLLOW BOLT, 1/2 IN.
16383922	PORTING BLOCK
17385052	HOSE ASSY
18385151	HOSE ASSY
19?	NO ITEM
20385372	NIPPLE
21385231	HOSE ASSY
22385131	HOSE ASSY
23?	NO ITEM
24385351	HOSE ASSY
25385311	HOSE ASSY, S /N 32 & DOWN
	HOSE ASSY, S /N 33 & UP
26385392	HOLLOW BOLT, 1/4 IN.
27385331	HOSE ASSY, S/N 32 & DOWN
385331	HOSE ASSY, S/N 33 AND UP
28385461	IN-LINE FLOW CONTROL
29385321	HOSE ASSY, S/N 32 & DOWN
392231	HOSE ASSY, S/N 33 & UP
30385341	HOSE ASSY, S/N 32 & DOWN
385341	HOSE ASSY, S/N 33 & UP
31?	NO ITEM
32385281	HOSE ASSY
3339219	HOSE ASSY
34	N/A/NIPPLE (INCLUDED WITH FILLER (ITEM 183))
350160540	-ring
36384964	Nipple

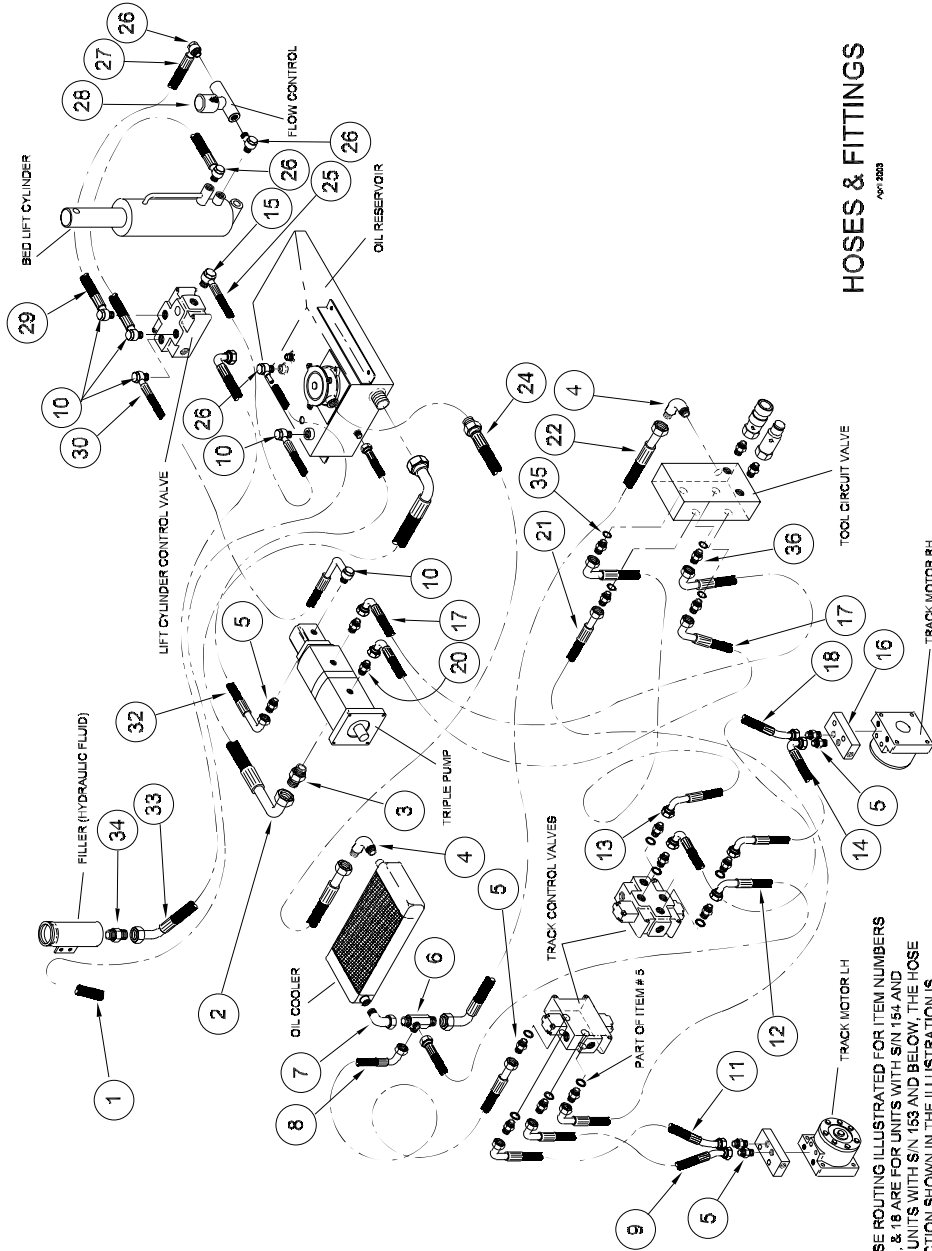

HOSES & FITTINGS

REV 2008

THE HOSE ROUTING ILLUSTRATED FOR ITEM NUMBERS 9, 11, 14, & 18 ARE FOR UNITS WITH S/N 154 AND ABOVE. UNITS WITH S/N 153 AND BELOW, THE HOSE CONNECTION SHOWN IN THE ILLUSTRATION IS REVERSED FROM WHAT IS ILLUSTRATED AT THE TRACK CONTROL VALVE END ONLY.