

STANLEY
 helps you do things right

Stanley Hydraulic Tools
 Division of The Stanley Works
 3810 S.E. Naef Road
 Milwaukie, Oregon 97267
 Phone: 503/659-5660
 Telex: 360771

PARTS LIST

**PR29 &
 PR30**

SPECIFICATIONS

	Aluminum	Epoxy
Weight	9 lbs/4 kg	9 lbs/4 kg
Flow Range	3-9 gpm/11-34 lpm	3-9 gpm/11-34 lpm
Porting	3/8" pipe	3/8" pipe
Dimensions	84 in/213 cm length	84 in/213 cm length
	PR29	PR30
* Pressure Range	1000-2000 psi 70-140 BAR	1000-1500 psi 70-105 BAR
System Type	O.C.	C.C.

* Pressure ratings are applicable to both epoxy and aluminum pruners.

U.S. Patent Number 3 476 015

**MODELS
 PR29 & PR30**

**HYDRAULIC
 INDUSTRIAL
 TREE PRUNER**

PR30 ALUMINUM AND EPOXY MODELS

Illus. Index No.	Part No.	Qty. Per Unit	PART NAME
1	01810	1	Valve Assembly
2	01991	1	Valve Handle
3	01030	1	Spring •
4	01809	1	Spool
5	00175	2	O-Ring, 1/2 x 5/8 x 1/16 (90 Duro) ⊙
6	01715	1	Guard, Trigger
7	01718	1	Trigger
8	01812	1	Screw
9	00160	2	Screw, 1/4-20 x 3/4 Oval Head
10	01534	2	Roll Pin, 1/8 x 1-1/4 •
11	02028	1	O-Ring, 1-5/8 x 1-3/4 x 1/16 ⊙
12	01254	1	Cylinder
13	00537	1	Cylinder Oil Tube
14	01253	1	Piston
15	01276	1	O-Ring, 1-5/8 x 1-13/16 x 3/32 ⊙
16			Not used on PR30 models
17			Not used on PR30 models
18	00018	1	O-Ring, 7/16 x 9/16 x 1/16 ⊙
19	01252	1	Cylinder End Bearing
20	02028	1	O-Ring, 1-5/8 x 1-3/4 x 1/16 ⊙
21	00574	1	O-Ring, 3/4 x 15/16 x 3/32 (90 Duro) ⊙
22	01815	1	Backup Ring, 3/32 x 3/4 ID ⊙
23	00542	1	Coupler Nut
24	00538	1	Piston Rod
25	00570	1	Piston Rod Connecting Pin •

Illus. Index No.	Part No.	Qty. Per Unit	PART NAME
26	00571	1	Retaining Ring •
27	00544	1	Link Bolt
28	00568	1	Nut, 3/8-24 hex •
29	00541	1	Coupler Sleeve
30	00573**	1	External Tube Assembly
	07290*	1	External Tube Assembly
31	00572**	1	Internal Tube Assembly
	04141*	1	Internal Tube Assembly
32	04487	1	Knife Bolt Washer
33	01211	1	O-Ring, 5/8 x 3/4 x 1/16 ⊙
34	00545	1	Slide Link Bolt
35	04144	1	Sleeve
36	04145	1	Linkage Hinge
37	00072	2	Roll Pin, 1/8 x 3/8 •
38	00549	2	Linkage Bar Shoulder Bolt
39	00656	2	Nut, 1/4-28 ESNA, Hex, Light, Thin •
40	00554	1	Linkage Bar
41	00550	1	Knife •
42	07233	1	Hook •
43	05267	1	Knife Bolt •
44	05268	1	Slotted Nut, 1/2-20 •
45	04143	1	Slide Head Assembly
46	00569	2	Screw, 5/16-18 x 1 Hex Head •
47	00283	2	Lockwasher, 5/16 med
48	01113**	2	Cap Washer
49	03793	1	GPM Sticker
50	00757	1	Roll Pin, 1/8 x 1 •

• Denotes part in Repair Kit

⊙ Denotes part in Seal Kit

REPAIR AND SEAL KIT DATA

NOTE: Seal Kit Included in Repair Kit

PR29 Repair Kit Part No. 04154

Part No.	Qty.	Description	Part No.	Qty.	Description
00072	2	Roll Pin	00656	2	Nut
01534	2	Roll Pin	01030	1	Spring
05268	1	Nut	Seal Kit Part No. 02039		
00550	1	Knife	00018	1	O-Ring
04127	1	Hook	00175	2	O-Ring
05267	1	Knife Bolt	00252	2	O-Ring
00568	1	Lock Nut	00560	1	O-Ring
00569	2	Screw	00574	1	O-Ring
00570	1	Connecting Pin	01211	1	O-Ring
00571	1	Retaining Ring	01815	1	Backup Ring
00757	1	Roll Pin			
07232	1	Techelp #52			

PR30 Repair Kit Part No. 04155

Part No.	Qty.	Description	Part No.	Qty.	Description
00072	2	Roll Pin	00656	2	Nut
01534	2	Roll Pin	01030	1	Spring
05268	1	Nut	Seal Kit Part No. 02041		
00550	1	Knife	00018	1	O-Ring
04127	1	Hook	00175	2	O-Ring
05267	1	Knife Bolt	02028	2	O-Ring
00568	1	Lock Nut	01276	1	O-Ring
00569	2	Screw	00574	1	O-Ring
00570	1	Connecting Pin	01211	1	O-Ring
00571	1	Retaining Ring	01815	1	Backup Ring
00757	1	Roll Pin	01262	1	O-Ring
07232	1	Techelp #52			

Part of item 31 on Aluminum Models Only.

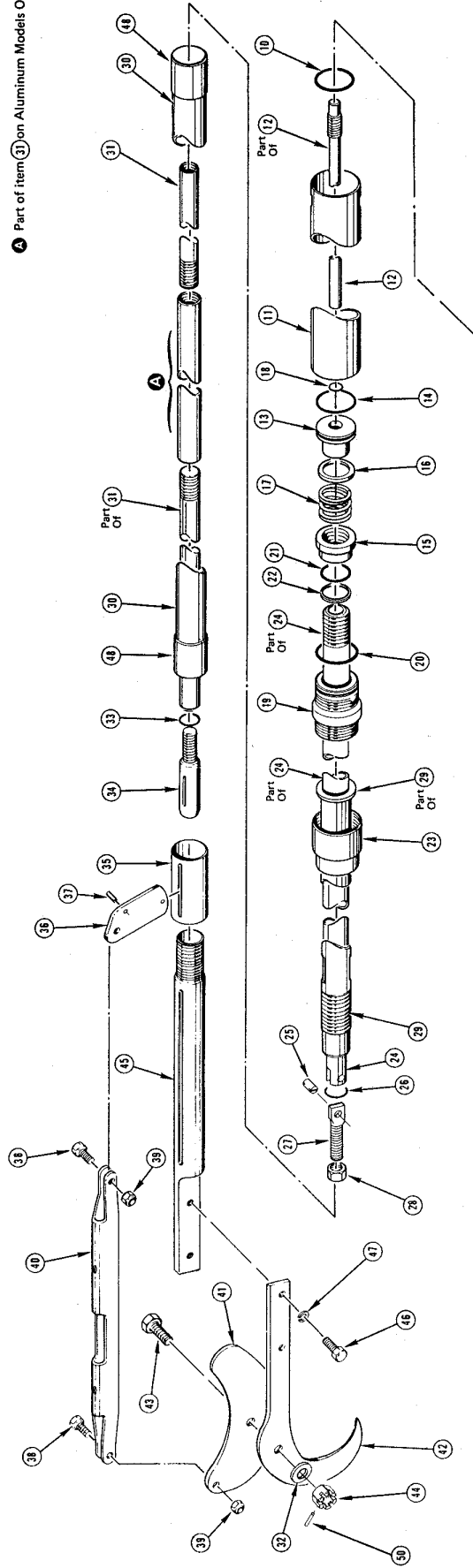

PR29 ALUMINUM AND EPOXY MODELS

NOTE: See Page 4 for Model PR30 Listing

Illus. Index No.	Part No.	Qty. Per Unit	Part Name	Part No.	Qty. Per Unit	Part Name
1	01808	1	Valve Assembly	00544	1	Link Bolt
2	01989	1	Valve Handle	00568	1	Nut, 3/8-24 Hex*
3	01030	1	Spring	00541	1	Coupler Sleeve
4	01809	1	Spool	07290*	1	External Tube Assembly**
5	00175	2	O-Ring, 1/2 x 5/8 x 1/16 (90 Duro)⊙	00573**	1	Internal Tube Assembly**
6	01715	1	Guard, Trigger	04141*	1	Internal Tube Assembly**
7	01812	1	Trigger	00572**	1	Knife Bolt Washer
8	01554	2	Screw, 1/4-20 x 3/4 Oval Head	01291	1	Slide Link Bolt
9	00162	2	Screw, 1/8 x 1-1/4*	00545	1	Slide Link Bolt
10	01554	2	O-Ring, 1-3/8 x 1-1/2 x 1/16⊙	04144	1	Sleeve
11	00252	1	Cylinder, Oil Tube	04145	1	Linkage Hinge
12	00537	1	Piston Assembly	00072	2	Roll Pin, 1/8 x 3/8*
13	00771	1	Cylinder Oil Tube	00549	2	Linkage Bar Shoulder Bolt*
14	00560	1	Piston	00656	2	Nut, 1/4-28 ESNA, Hex, Light, Thin*
15	00534	1	Piston Nut	00550	1	Linkage Bar
16	00535	1	Disc Valve	00550	1	Hook*
17	00539	1	Disc Valve Spring	00527	1	Knife Bolt**
18	00016	1	O-Ring, 7/16 x 9/16 x 1/16⊙	00541	1	Knife Bolt**
19	00533	1	Cylinder End Bearing	05069	1	Slotted Nut, 1/2-20*
20	00252	1	O-Ring, 1-3/8 x 1-1/2 x 1/16⊙	04143	1	Slide Head Assembly
21	01815	1	Back-up Ring, 3/4 x 15/16 x 3/32 (90 Duro)⊙	06659	2	Slide Head Assembly**
22	01815	1	Back-up Ring, 3/32 x 3/4 ID⊙	00569	2	Screw, 5/16-18 x 1 Hex Head*
23	00542	1	Coupler Nut	00283	2	Lockwasher, 5/16 Med
24	00538	1	Piston Rod	01113	2	Cap Washer**
25	00570	1	Piston Rod Connecting Pin*	00783	1	GPM Sticker
26	00571	1	Retaining Ring*	00757	1	Roll Pin, 1/8 x 1*

* Denotes Item Used on Epoxy Models Only.
 ** Denotes Item Used on Aluminum Models Only.
 *** Use in heavy-duty extended head

⊙ Denotes Part In Repair Kit
 ⊙ Denotes Part In Seal Kit