

STANLEY
helps you do things right

Stanley Hydraulic Tools
Division of The Stanley Works
3810 S.E. Naef Road
Milwaukie, Oregon 97267
Phone: 503/659-5660
Telex: 360771

PARTS LIST



IP14
10,000 PSI

SPECIFICATIONS

Weight	19 lbs (dry)/8.6 kg
Height	13-1/4 in./336.5 mm
Width	6-1/4 Dia./159 mm
Reservoir Capacity	1.5 Qt./1.4 l. tr.
Input Power	117 VAC
Output	10,000 psi/703 kg/cm ²

MODEL IP14
10,000 PSI

**HYDRAULIC
INTENSIFIER**
(ELECTRIC)

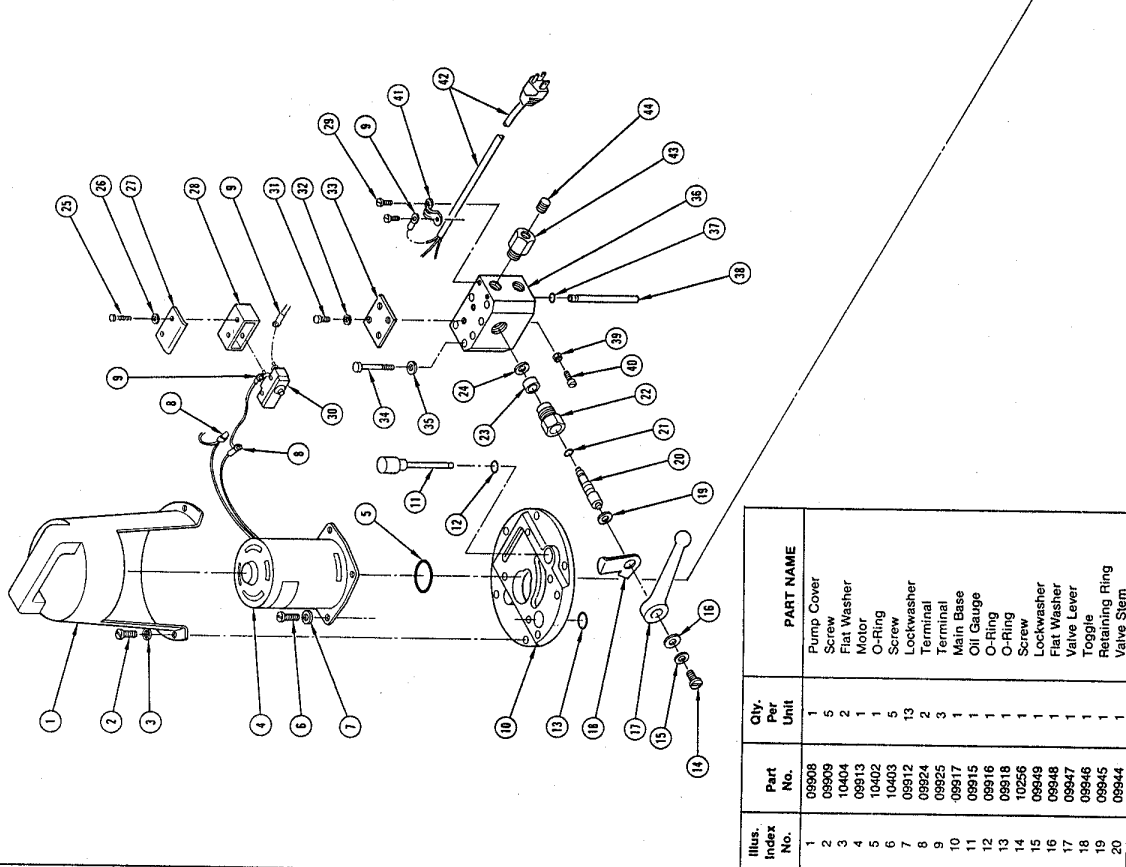
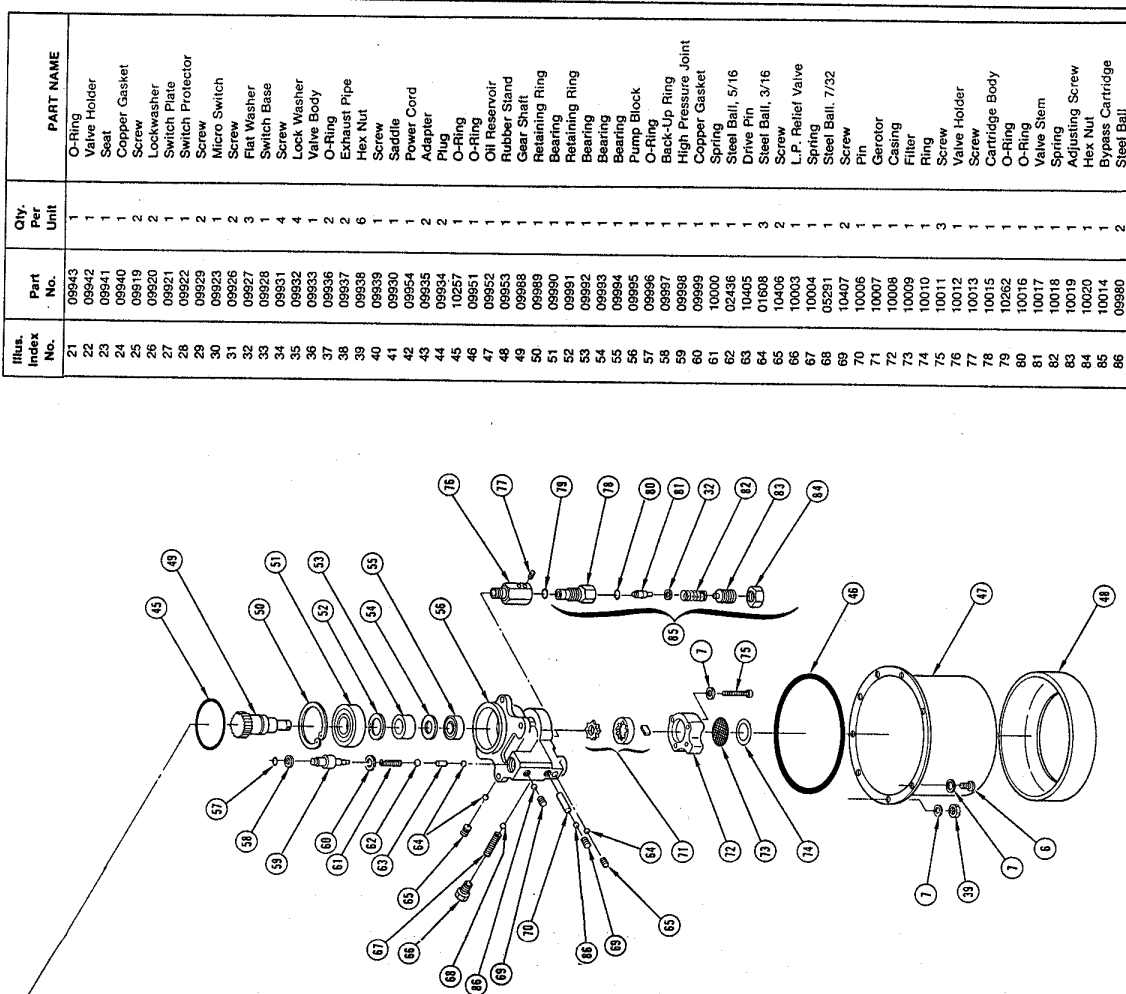

Illus. Index No.	Part No.	Qty. Per Unit	PART NAME
21	09943	1	O-Ring
22	09942	1	Valve Holder
23	09941	1	Seat
24	09940	1	Copper Gasket
25	09919	2	Screw
26	09920	2	Lockwasher
27	09921	1	Switch Plate
28	09922	1	Switch Protector
29	09923	2	Screw
30	09924	2	Micro Switch
31	09925	2	Screw
32	09927	3	Flat Washer
33	09928	1	Switch Base
34	09931	4	Screw
35	09932	4	Lock Washer
36	09933	1	Valve Body
37	09936	2	O-Ring
38	09937	2	Exhaust Pipe
39	09938	6	Hex Nut
40	09939	1	Saddle
41	09954	1	Power Cord
42	09955	2	Adapter
43	09934	2	Plug
44	09934	2	O-Ring
45	10257	1	O-Ring
46	09851	1	Oil Reservoir
47	09852	1	Rubber Stand
48	09853	1	Gear Shaft
49	09868	1	Retaining Ring
50	09869	1	Bearing
51	09890	1	Bearing
52	09891	1	Bearing
53	09892	1	Bearing
54	09893	1	Bearing
55	09894	1	Bearing
56	09895	1	Pump Block
57	09896	1	O-Ring
58	09897	1	Back-Up Ring
59	09898	1	High Pressure Joint
60	09899	1	Copper Gasket
61	10000	1	Spring
62	02436	1	Steel Ball, 5/16
63	10405	1	Drive Pin
64	01608	3	Steel Ball, 3/16
65	10406	2	Screw
66	10003	1	L.P. Pellet Valve
67	10004	1	Spring
68	05293	1	Steel Ball, 7/32
69	10407	2	Screw
70	10005	1	Pin
71	10007	1	Carotor
72	10008	1	Casing
73	10009	1	Filter
74	10010	1	Ring
75	10011	3	Screw
76	10012	1	Valve Holder
77	10013	1	Screw
78	10015	1	Cartridge Body
79	10252	1	O-Ring
80	10016	1	O-Ring
81	10017	1	Valve Stem
82	10018	1	Spring
83	10019	1	Adjusting Screw
84	10020	1	Hex Nut
85	10014	1	Bypass Cartridge
86	09980	2	Steel Ball

Illus. Index No.	Part No.	Qty. Per Unit	PART NAME
1	09908	1	Pump Cover
2	09909	5	Screw
3	10401	2	Flat Washer
4	09915	1	Motor
5	10402	1	O-Ring
6	10403	5	Screw
7	09912	13	Lockwasher
8	09924	2	Terminal
9	09925	3	Terminal
10	09917	1	Main Base
11	09915	1	Oil Gauge
12	09916	1	O-Ring
13	09918	1	O-Ring
14	10256	1	Screw
15	09949	1	Lockwasher
16	09948	1	Flat Washer
17	09947	1	Valve Lever
18	09946	1	Toggle
19	09945	1	Retaining Ring
20	09944	1	Valve Stem

NOTE: Use Part Number and Part Name When Ordering.

STANLEY®

helps you do things right

Stanley Hydraulic Tools

Division of The Stanley Works

3810 S.E. Naef Road

Milwaukie, Oregon 97267

Phone: 503/659-5660

Telex: 360771