

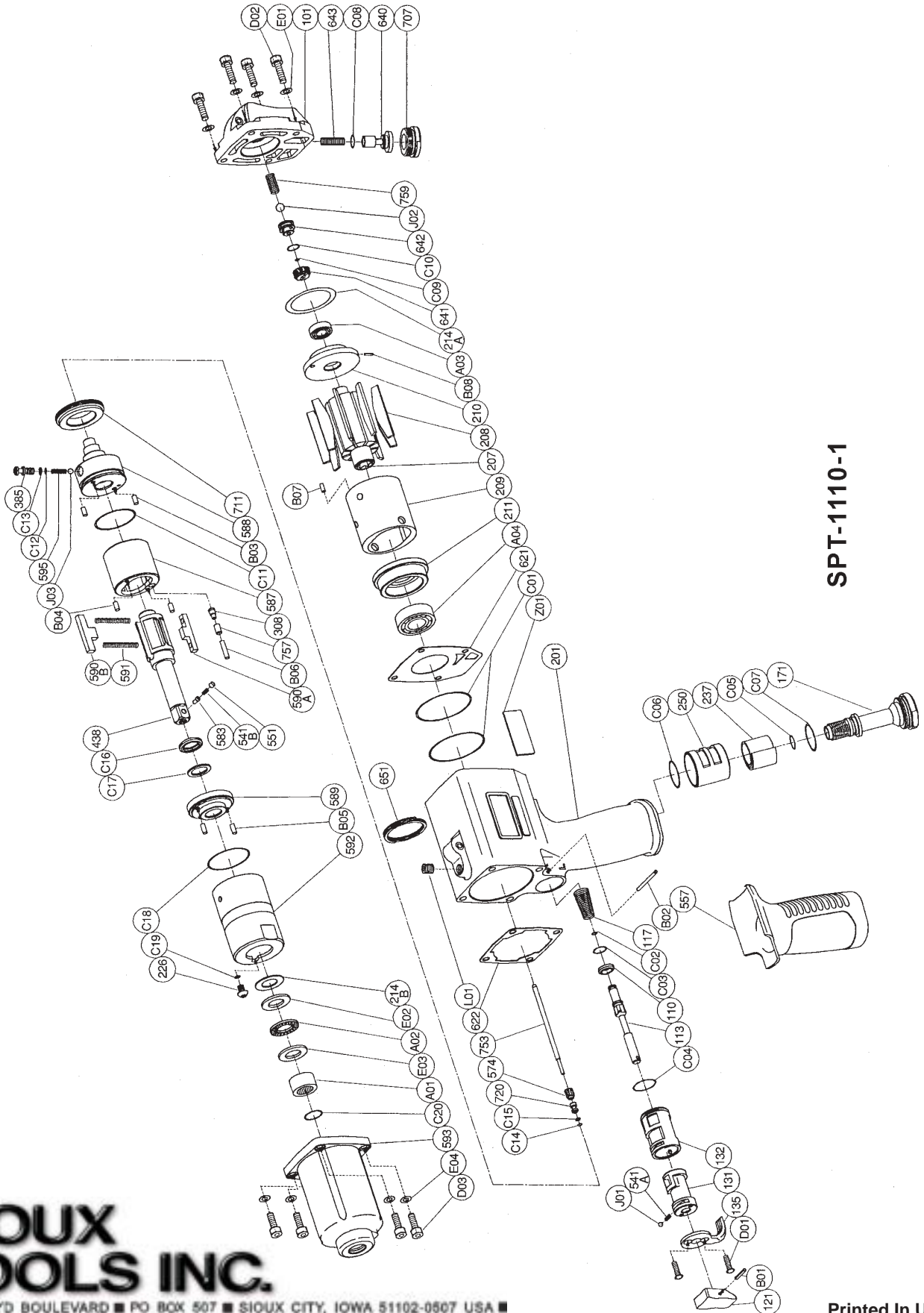

# PARTS LIST FOR PULSE TOOL SPT-1110-1 PISTOL, MTC, 1/2" SQ DRIVE

Form Z614  
Date 6-00/B  
Page 1 of 2



SPT-1110-1

**SIoux  
TOOLS INC.**

2901 FLOYD BOULEVARD ■ PO BOX 507 ■ SIOUX CITY, IOWA 51102-0507 USA ■

Printed In U.S.A.



# PARTS LIST FOR PULSE TOOL

## SPT-1110-1 PISTOL, MTC, 1/2" SQ DRIVE

**Fig. Part**  
**No. No. Description**  
 601305 Ass'y Housing (SPT-1110-1)

**Includes the following parts:**

110 601171 Throttle Valve  
 113 601158 Throttle Valve Rod  
 117 601020 Throttle Valve Spring  
 121 601108 Throttle Valve Lever  
 131 601159 Reverse Valve  
 132 601160 Reverse Valve Bushing  
 135 601172 Reverse Valve Lever  
 171 601173 Inlet Joint (PT)  
 171 601174 Inlet Joint (NPT)  
 201 601273 Housing  
 237 601166 Muffler Pad  
 250 601175 Exhaust Cover  
 541A 601104 Button Retainer Spring  
 B01 601087 Spring Pin  
 B02 601022 Grooved Pin  
 C01 601075 "O" Ring (2)\*  
 C02 601069 "O" Ring  
 C03 601050 "O" Ring  
 C04 601056 "O" Ring  
 C05 601054 "O" Ring  
 C06 601060 "O" Ring  
 C07 601060 "O" Ring  
 D01 601016 Cap Screw (2)\*  
 J01 601001 Ball

601304 Ass'y Housing Cover (SPT-1110-1)

**Includes the following parts:**

101 601272 Housing Cover  
 640 601269 Stop Valve  
 641 601209 Stop Valve Front Cover  
 642 601210 Stop Valve Rear Cover  
 643 601254 Stop Valve Spring (Black)  
 707 601270 Valve Cover  
 759 601215 Return Spring  
 C08 601048 "O" Ring  
 C09 601063 "O" Ring  
 C10 601077 "O" Ring  
 D02 601019 Cap Screw (4)\*  
 E01 601082 Plain Washer (4)\*  
 J02 601003 Ball

601306 Ass'y Oil Cylinder (SPT-1110-1)

**Includes the following parts:**

226 601094 Oil Plug  
 308 601247 Spacer  
 385 601261 Adjusting Screw  
 438 601276 Spindle (Includes figures 541B, 551, 583)  
 541B 601099 Button Retainer Spring  
 551 601100 Plug  
 574 601249 Bolt Holder  
 583 601101 Retainer Button  
 587 601169 Oil Cylinder  
 588 601277 Oil Cylinder Upper Plate  
 589 601278 Oil Cylinder Lower Plate  
 590A 601117 Spindle Blade

**Fig. Part**  
**No. No. Description**  
 590B 601118 Spindle Blade  
 591 601119 Blade Spring (2)\*  
 592 601279 Cylinder Case  
 595 601267 Torque Adjusting Spring  
 711 601097 Cylinder Cover  
 720 601184 Piston  
 757 601170 Needle  
 B03 601040 Needle Roller (2)\*  
 B04 601040 Needle Roller (2)\*  
 B05 601024 Grooved Pin (2)\*  
 B06 601043 Needle Roller  
 C11 601072 "O" Ring  
 C12 601049 "O" Ring  
 C13 601014 Back Up Ring  
 C14 601062 "O" Ring  
 C15 601015 Back Up Ring  
 C16 601047 "X" Ring  
 C17 601013 Back Up Ring  
 C18 601070 "O" Ring  
 C19 601064 "O" Ring  
 J03 601001 Ball

601307 Ass'y Front Case (SPT-1110-1)

**Includes the following parts:**

593 601280 Front Case  
 A01 601027 Needle Bearing  
 A02 601026 Thrust Ball Bearing  
 C20 601044 "O" Ring  
 D03 601019 Cap Screw (4)\*  
 E02 601091 Governor Valve Cover  
 E03 601091 Governor Valve Cover  
 E04 601082 Plain Washer (4)\*  
 L01 601079 Plug

**Common Parts:**

207 601274 Rotor  
 208 601163 Rotor Blade (Set of 9)  
 209 601164 Cylinder (Includes figure B07)  
 210 601165 Cylinder Upper Plate (B08)  
 211 601275 Cylinder Lower Plate  
 214A 601092 Adjusting Washer  
 214B 601246 Adjusting Washer (2)\*  
 557 601168 Protector  
 621 601194 Packing  
 622 601096 Packing  
 651 601093 Horizontal Hanger  
 753 601281 Piston Rod  
 A03 601006 Ball Bearing  
 A04 601008 Ball Bearing  
 B07 601086 Spring Pin  
 B08 601088 Spring Pin  
 Z01 601034 Name Plate (SPT-1110-1)

**Not Shown:**

601283 Wrench Hex 1.5MM  
 601284 Wrench Hex 4MM  
 601503 Warning Label

\*Order Quantity As Required

FURNISH CATALOG, SERIAL, AND MODEL NUMBER WHEN ORDERING PARTS

**SIoux TOOLS INC.**

2901 FLOYD BOULEVARD ■ PO BOX 507 ■ SIOUX CITY, IOWA 51102-0507 USA ■

Printed In U.S.A.