

# OPERATION INSTRUCTIONS and PARTS LIST for EMERGENCY STOP CONVERSION

This instruction sheet and parts list covers the operation and installation of the Emergency Stop Control for the FA5A winch. This sheet should be used in conjunction with the FA5A Parts, Operation and Maintenance Manual form MHD56087.

Operators should familiarize themselves with these features, operation and other safety procedures provided in the FA5A Parts, Operation and Maintenance Manual, form MHD56087.

## OPERATION

The emergency stop valve, when activated will shutoff air to the winch. This will stop ALL winch movement.

To resume operation the emergency condition will have to be corrected and the EMERGENCY STOP valve reset.

### To Activate

To activate the EMERGENCY STOP valve press the RED button down. Button will lock in the down position.

### To Reset

Twist the silver ring located below the RED button 'clockwise' this will release the RED button.

Winch is now ready to resume operation.

## OLD EMERGENCY STOP VALVE REMOVAL

Refer to Dwg. MHP1857.

1. Remove both hose end fitting's (5) from tee fitting (24).  
Remove tee fitting and discard.
2. Remove hose end fitting (5) from elbow fitting (25).
3. Remove (retain for assembly) capscrews (21), washers (22) and nuts (23).
4. Remove old bracket (1) and valve assembly, discard.

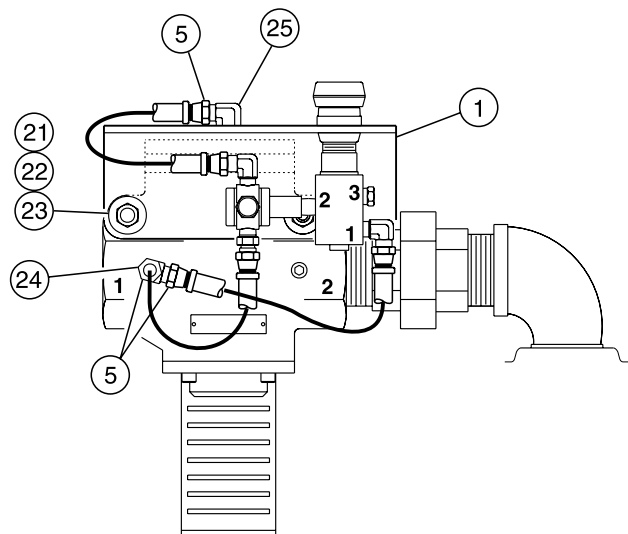

(Dwg. MHP1857)

## NEW EMERGENCY STOP VALVE INSTALLATION

Refer to Dwg. MHP1856.

1. Secure new bracket (1) and Emergency stop valve assembly to shutoff valve (26) using capscrews (21), washers (22) and nuts (23).
2. Connect one hose end fitting (5) to connector fitting (6) at port **2** on valve kit (3) and the other hose end fitting to elbow (25).
3. Screw elbow fitting (8) into port **1** in shutoff valve (26).
4. Attach one hose end fitting (5) onto elbow (8) and the other hose end fitting attach to connector fitting (6) at port **3** on valve kit.
5. There are two pieces of hose (7) in the kit. Use one piece to connect the hose ends connected to elbow (25) and connector in port **2** on valve kit. Use the other piece to connect the hose ends connected to elbow (8) and connector in port **3** on valve kit. Both of these hoses should make smooth curves with no kinks.

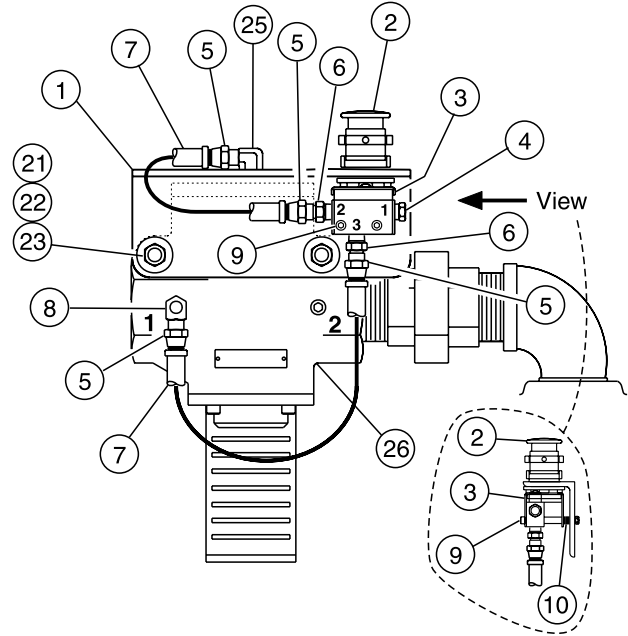

### NOTICE

- Capscrews (9) replace those in valve kit (3). Washers (10) are used as spacers to support valve.

(Dwg. MHP1856)

## EMERGENCY STOP CONVERSION KIT PARTS LIST

ITEM NO.	DESCRIPTION OF PART	QTY TOTAL	PART NUMBER	ITEM NO.	DESCRIPTION OF PART	QTY TOTAL	PART NUMBER
---	Conversion Kit	1	26337RETRO	6	Fitting, Connector	2	71048268
1	E-Stop Bracket	1	26353	7	Hose, Bulk	As Reqd.	50923-**
2	E-Stop Push Button	1	71351399	8	Fitting, Elbow	1	71098545
3	Valve Kit	1	71263420	9	Capscrew	2	71352454
4	Breather	1	51559	10	Washer	12	71352462
5	Fitting, Hose End	4	51029				

\*\* Order in even foot increments, i.e. 50923-02 = 2 feet (0.6 metres)