

INSTRUCTION SHEET

FA5A WINCH

ORIFICE PLATE INSTALLATION

This instruction sheet covers the Orifice Plate installation. This plate is used when the air flow is less than the recommended air flow. This sheet will give authorized service personnel the information needed to install the orifice plate.

This instruction sheet should be used in conjunction with the FA5A Parts, Operation and Maintenance Manual, form number MHD56087.

OPERATION

Orifice Plate

The orifice plate is used to restrict the air flow through the FA5A motor. This may be necessary in applications in which the winch does not receive the required amount of air to maintain pressure to the automatic disc brake.

NOTICE

- Installation of this kit will substantially decrease the performance (line speed) of the winch.

If the winch is used with an adequate air supply, then the orifice plate is not required and may be removed.

INSTALLATION

⚠ WARNING

- Never perform maintenance on the winch while it is supporting a load.
- Before performing maintenance, tag controls:
**DANGER - DO NOT OPERATE-
EQUIPMENT BEING REPAIRED**
- Turn off air system and depressurize air line before performing any maintenance.

Control Valve Removal

1. Remove air supply line.
2. Remove valve muffler (710) (if installed).
3. Remove air lines to shuttle valve (415).
4. Loosen capscrews (442) and remove valve assembly (400). Capscrews (442) cannot be removed without taking adapter (440) off valve body, this is not necessary.

5. Remove gasket (248) from adapter (440) and rotary valve housing (247).

Orifice Plate Installation

1. Place new gasket (248) onto valve housing.
2. Place orifice plate on the gasket, followed by the second gasket.

NOTICE

- The small center hole in the orifice plate must be positioned at the end of the control valve opposite the control handle.

3. Place valve assembly back on the valve housing and tighten capscrews (442).
4. Connect air lines to shuttle valve and tighten.
5. Connect muffler to valve exhaust (if necessary).
6. Attach air supply line to valve and tighten.

Brake Line Fitting Conversion

1. Remove brake air line at elbow fitting (801).
2. Remove elbow fitting (801) and discard.
3. Install new elbow fitting (801) and tighten (finish with fitting facing back towards upright).
4. Connect brake air line and tighten.

Testing

1. Turn on air to winch.
2. Operate winch in haul-in direction and verify proper operation.
3. Operate winch in pay-out direction and verify proper operation, including complete release of disc brake.

ORIFICE KIT ASSEMBLY DRAWING AND PARTS LIST

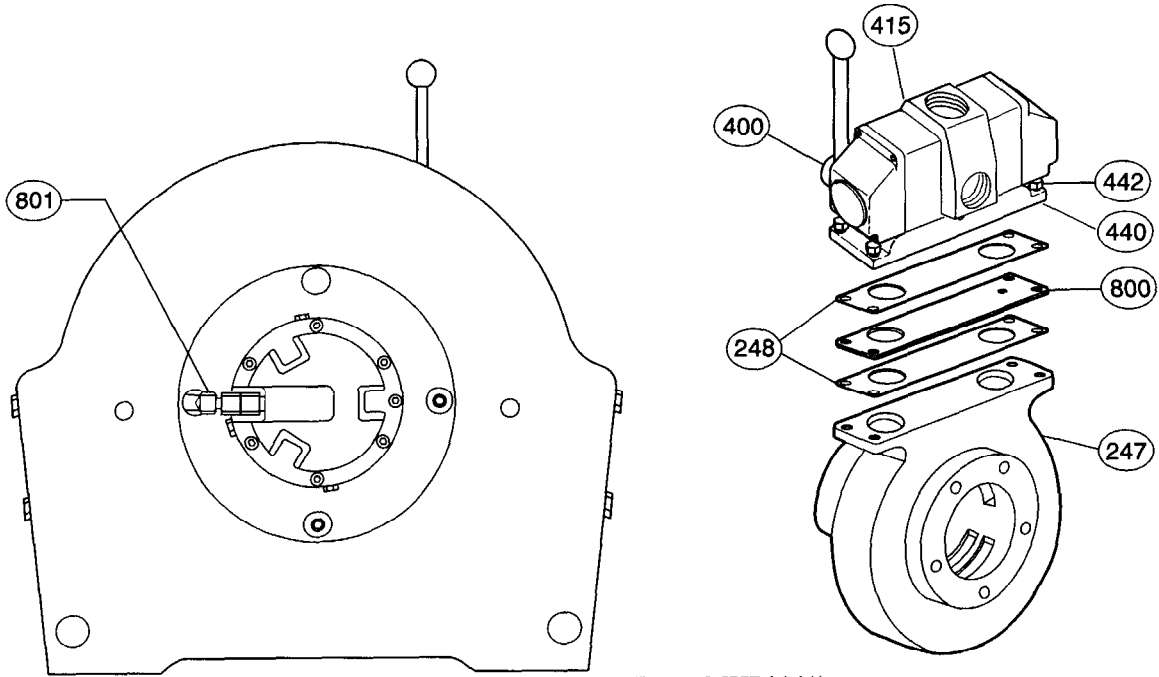

(Dwg. MHP1141)

| ITEM NO. | DESCRIPTION OF PART | QTY TOTAL | PART NUMBER |
|----------|---------------------|-----------|-------------|
| 248 | Gasket | 2 | K5B-547 |
| 800 | Orifice Plate | 1 | 25865 |
| 801 | Elbow Fitting | 1 | 71262299 |