

PARTS LIST

For

“PROMAXX™” Jackhammer

Models: JX35 & JX35S

INGERSOLL-RAND®

Designed and Built by Ingersoll-Rand Company
Roanoke, Va. 24019-5198 U.S.A.



**Certified ISO-9001 (ANSI/ASQC Q91)
Certification No. QSR-80**

Refer All Communications To The Nearest Address Listed On The Back Cover.



Warranty

Ingersoll-Rand, through its distributor, warrants that each item of equipment manufactured by it and delivered hereunder to the initial user to be free of defects in material and workmanship for a period of three (3) months from initial operation or six (6) months from the date of shipment to the initial user, whichever first occurs.

With respect to the following types of equipment, the warranty period enumerated will apply in lieu of the foregoing warranty period.

- A. Aftercoolers, Drill Mountings and Klemm Rotary Heads – The earlier of six (6) months from initial operation or nine (9) months from date of shipment to the initial user.
- B. Portable Compressors, Portable Generator Sets (GENSET), Portable Light Towers and Abrasive Blasting Equipment. The earlier of twelve (12) months from shipment to, or the accumulation of 2,000 hours of service by, the initial user.
- C. All Compressor Air Ends, GENSET Generators and Paving Breakers – The earlier of twenty-four (24) months from shipment to, or the accumulation of 4,000 hours of service by, the initial user. For Air Ends, the warranty against defects will include replacement of the complete Air End, provided the original Air End is returned assembled and unopened.
- D. Pavers, Milling Machines, Pedestrian Compactors (including baseplates, upright and walk behinds) and Rotary Drills – The earlier of (6) months from shipment to, or the accumulation of 1,000 hours of service by, the initial user.
- E. Jackhammers, Forklifts and Self-Propelled Compactors – The earlier of twelve (12) months from shipment to, or the accumulation of 1,000 hours of service by, the initial user.
- F. Downhole Drills – In lieu of the repair or replacement of defective parts Ingersoll-Rand may elect to

issue full or partial credit toward the purchase of a new part. The extent of credit issued will be determined by pro rating against the normal service life of the part in question.

- G. Spare Parts (excluding downhole drills) – Three (3) months from date of shipment.

Ingersoll-Rand will provide a new part or repaired part, at its election, in place of any part which is found upon its inspection to be defective in material and workmanship during the period prescribed above. Such part will be repaired or replaced without charge to the initial user during normal working hours at the place of business of an Ingersoll-Rand distributor authorized to sell the type equipment involved or other establishment authorized by Ingersoll-Rand. User must present proof of purchase and date at the time of exercising warranty.

This warranty does not apply to failures occurring as a result of abuse, misuse, negligent repairs, corrosion, erosion and normal wear and tear, alterations or modification made to the product without express written consent of Ingersoll-Rand; or failure to follow the recommended operating practices and maintenance procedures as provided in the product's operating and maintenance publications.

Accessories or equipment furnished by Ingersoll-Rand, but manufactured by others, including, but not limited to, engines, tires, batteries, engine electrical equipment, hydraulic transmissions, carriers, shall carry whatever warranty the manufacturers have conveyed to Ingersoll-Rand and which can be passed on to the initial user.

THIS WARRANTY IS IN LIEU OF ALL OTHER WARRANTIES (EXCEPT OF TITLE), EXPRESSED OR IMPLIED, AND THERE ARE NO WARRANTIES OF MERCHANTABILITY OR OF FITNESS FOR A PARTICULAR PURPOSE.

Limitation of Liability

THE REMEDIES OF THE USER SET FORTH UNDER PROVISIONS OF WARRANTY OUTLINED ABOVE ARE EXCLUSIVE AND THE TOTAL LIABILITY OF INGERSOLL-RAND OR ITS DISTRIBUTORS WITH RESPECT TO THIS SALE OR THE EQUIPMENT AND SERVICE FURNISHED HEREUNDER, IN CONNECTION WITH THE PERFORMANCE OR BREACH THEREOF, OR FROM THE SALE, DELIVERY, INSTALLATION, REPAIR OR TECHNICAL DIRECTION COVERED BY OR FURNISHED UNDER THIS SALE. WHETHER BASED ON CONTRACT, WARRANTY, NEGLIGENCE, INDEMNITY, STRICT LIABILITY OR OTHERWISE SHALL NOT EXCEED THE PURCHASE PRICE OF THE UNIT OF EQUIPMENT UPON WHICH SUCH LIABILITY IS BASED.

INGERSOLL-RAND, ITS SUPPLIER(S) AND ITS DISTRIBUTORS SHALL IN NO EVENT BE LIABLE TO THE USER, ANY SUCCESSORS IN INTEREST OR ANY BENE-

FICIARY OR ASSIGNEE RELATING TO THIS SALE FOR ANY CONSEQUENTIAL, INCIDENTAL, INDIRECT, SPECIAL OR PUNITIVE DAMAGES ARISING OUT OF THIS SALE OR ANY BREACH THEREOF, OR ANY DEFECTS IN, OR FAILURE OF, OR MALFUNCTION OF THE EQUIPMENT UNDER THIS SALE WHETHER BASED UPON LOSS OF USE, LOST PROFITS OR REVENUE, INTEREST, LOST GOODWILL, WORK STOPPAGE, IMPAIRMENT OF OTHER GOODS, LOSS BY REASON OF SHUTDOWN OR NON-OPERATION, INCREASED EXPENSES OF OPERATION OF THE EQUIPMENT, COST OF PURCHASE OF REPLACEMENT POWER OR CLAIMS OF USERS OR CUSTOMERS OF THE USER FOR SERVICE INTERRUPTION WHETHER OR NOT SUCH LOSS OR DAMAGE IS BASED ON CONTRACT, WARRANTY, NEGLIGENCE, INDEMNITY, STRICT LIABILITY OR OTHERWISE.



NOTE: THE VERTICAL BAR SHOWN TO THE LEFT OF TEXT DESIGNATES A REVISION HAS BEEN MADE SINCE THE PREVIOUS PRINTING.

ORDERING INSTRUCTIONS

When ordering service parts, please specify:

1. The **NAME** of each part as listed.
2. The **PART NUMBER** as listed or stamped on the part.
3. The **SERIAL NUMBER** of the equipment.

DO NOT use illustration numbers when ordering service parts. To save time, send all orders for parts to the nearest branch office or agent. IF IT IS NECESSARY TO SEND ANY PART OF THIS EQUIPMENT TO THE FACTORY, INQUIRE AT OUR NEAREST BRANCH OFFICE OR AGENT FOR SPECIAL INSTRUCTIONS.

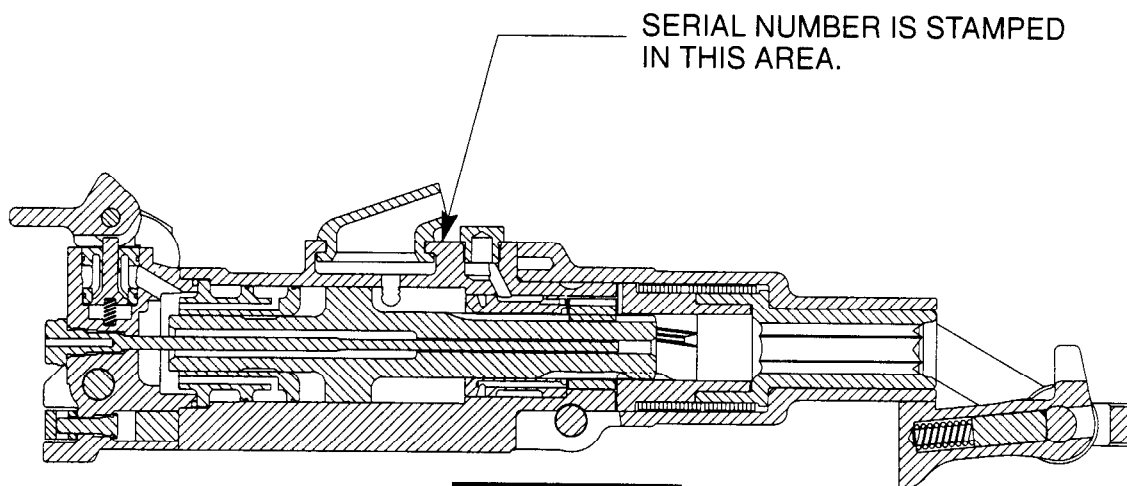

NOTICE

SAVE THESE INSTRUCTIONS. DO NOT DESTROY.

The use of repair parts other than those included within the Ingersoll-Rand[®] approved parts list may create hazardous conditions over which Ingersoll-Rand[®] Company has no control. Therefore Ingersoll-Rand[®] Company cannot be held responsible for equipment in which non-approved repair parts are installed.

All information, illustrations, and specifications in this manual are based on the latest information available at the time of publication. Product improvement is a continuing goal at Ingersoll-Rand[®]. Design and specifications are subject to change without notice or obligation.

When the life of the machine has expired, it is recommended that the machine be disassembled, degreased and parts be separated by material so that they can be recycled.

Each column includes the Parts List
Section Numbers applicable to the assembly.

NAME OF ASSEMBLY
Components of an assembly
are indented.

	Manual No.	Section No.
Introduction	PL6113	1
“PROMAXX™” Jackhammer Models JX35 & JX35S	PL6113	2
General Information	PL6113	3

Alphabetical Index

<u>Title</u>	<u>Page No.</u>
Introduction	1
Safety First	1
Safety Precautions	1

1. INTRODUCTION.

This parts list contains spare part numbers, general model information and important safety information for "PROMAXX™" Jackhammer Models JX35 & JX35S (hereafter referred to as jackhammer).

2. SAFETY FIRST.

SAFETY FIRST is the primary concern for the protection of both, personnel and the jackhammer during any phase of operation. All personnel must thoroughly understand all safety precautions before operating or doing any maintenance work on the jackhammer.

3. SAFETY PRECAUTIONS.

The Safety Precautions listed are intended to make all personnel aware of the hazards while working on or near a jackhammer. All personnel must use common sense and a good working practice while operating and maintaining the jackhammer. The safety precautions listed are of a general nature and cannot cover every possible situation:

a. Always wear approved hard hat, safety shoes, safety glasses, nose mask, and ear protection when near a jackhammer in operation. Failure to wear approved safety equipment could result in bodily injury.

b. Use only Ingersoll-Rand® replacement parts.

c. Prolonged exposure to excessive noise levels without the use of proper ear protection can result in permanent hearing loss.

d. Do not indulge in horseplay. Distractions can cause accidents.

e. Keep your hands off the throttle lever until it is time to start jackhammer operation.

f. Maintain a steady balance at all times.

g. Never put your face close to the jackhammer.

h. Never rest the jackhammer on your foot.

i. Never point the jackhammer at anyone.

j. Never start the jackhammer when it is lying on the ground.

k. Compressed air is dangerous. Never point an air hose at yourself or co-workers. Never blow your clothes free of dust with compressed air.

l. Never disconnect a pressurized air hose, before disconnecting a hose, shut-off the air at the compressor and bleed the jackhammer.

m. Do not operate the jackhammer without a drill steel locked in the fronthead. Hold the tool firmly against the work.

n. Always keep both hands on the handle while operating the jackhammer.

o. The operator must keep his legs and feet clear of the drill steel to prevent injury if the tool breaks. If a tool breaks, the jackhammer (with a piece of broken tool projecting from the fronthead) will suddenly drop to the ground.

p. Do not "ride" the jackhammer with one leg over the handle. The operator can be injured if the tool breaks while he is riding the jackhammer.

q. Know what is underneath the material you are about to drill. Be alert for any buried water, gas, sewer, telephone, or electric lines.

r. If you hit something, shut-off the jackhammer immediately and find out what it is. Use a shovel, not the jackhammer, to uncover the object carefully.

s. When using any solvent to clean parts, make sure that it meets current safety and health standards and that it is used in an area that is adequately ventilated.

REF. NO.	QTY	NAME OF PART	REMARKS	SHANK SIZE→					
				7/8 x 4-1/4	7/8 x 3-1/4	1 x 4-1/4	7/8 x 4-1/4	7/8 x 3-1/4	1 x 4-1/4
				JX35- STD 51992774	JX35- OPT-A 51992782	JX35- OPT-B 51992790	JX35S- STD 51992808	JX35S- OPT-A 51992816	JX35S- OPT-B 51992824
1	1	BACKHEAD		51730026	←	←	←	←	←
2	1	PLUG, PIPE		95033353	←	←	←	←	←
3	1	LEVER, THROTTLE		51776003	←	←	←	←	←
4	1	PIN, DOWEL		95795803	←	←	←	←	←
5	1	PIN		95098620	←	←	←	←	←
6	1	VALVE, THROTTLE		51730562	←	←	←	←	←
7	1	BODY, THROTTLE VALVE		51730554	←	←	←	←	←
8	1	SPRING, THROTTLE VALVE		51779775	←	←	←	←	←
9	2	O-RING		95097705	←	←	←	←	←
10	1	TUBE, SOLID BLOWER		51778801	←	←	←	←	←
11	1	O-RING		95086112	←	←	←	←	←
13	1	VALVE, BLOW AIR		51730570	←	←	←	←	←
14	1	O-RING		95676482	←	←	←	←	←
15	1	LEVER, BLOW AIR		51730588	←	←	←	←	←
16	1	PIN		95034005	←	←	←	←	←
17	1	CAP		51361798	←	←	←	←	←
18	1	NIPPLE, SEIVEL		51361863	←	←	←	←	←
19	1	O-RING		95086161	←	←	←	←	←
20	1	PLUG, PIPE		95033379	←	←	←	←	←
21	1	BOLT, HANDLE		51728178	←	←	←	←	←
22	1	GRIP, HANDLE		51716454	←	←	←	←	←
23	1	NUT, HANDLE BOLT		52087491	←	←	←	←	←
24	1	WASHER		51948016	←	←	←	←	←
25	1	CAPSCREW		95710489	←	←	←	←	←
26	1	WASHER		51948016	←	←	←	←	←
27	1	PLUG, BACKHEAD		51778520	←	←	←	←	←

“PROMAXX™” Jackhammer Models

JX35 & JX35S

REF. NO.	QTY	NAME OF PART	REMARKS	SHANK SIZE→					
				7/8 x 4-1/4 JX35- STD 51992774	7/8 x 3-1/4 JX35- OPT-A 51992782	1 x 4-1/4 JX35- OPT-B 51992790	7/8 x 4-1/4 JX35S- STD 51992808	7/8 x 3-1/4 JX35S- OPT-A 51992816	1 x 4-1/4 JX35S- OPT-B 51992824
28	1	HOUSING		51991784	←	←	←	←	←
30	1	O-RING		95086575	←	←	←	←	←
31	1	DEFLECTOR, EXHAUST		51729036	←	←	←	←	←
32	1	PLUG		51370203	←	←	←	←	←
33	3	PLUG		95077145	←	←	←	←	←
34	1	PLUG, HOUSING		51778538	←	←	←	←	←
35	1	BEARING, PISTON STEM		51990893	←	←	←	←	←
36	1	FILTER		51905156	←	←	←	←	←
37	1	NUT SPLINE	In Rotation kit (51994325)	51988962	←	←	←	←	←
57	3	PIN, SPLINE NUT		95675971	←	←	←	←	←
38	1	DISTRIBUTOR, AIR		51905024	←	←	←	←	←
39	2	O-RING, AIR DISTRIBUTOR		95097770	←	←	←	←	←
40	1	PISTON		51984136	←	←	←	←	←
41	1	FRONTHEAD		51727808	←	←	←	←	←
42	1	NUT RIFLE	In Rotation kit (51988962)	51984334	←	←	←	←	←
43	1	SPRING CLUTCH	In Rotation kit (51988962)	51715431	←	←	←	←	←
44	1	CHUCK	In Rotation kit (51988962)	51710853	51710861	51710846	51710853	51710861	51710846
45	1	LATCH	In Rotation kit (51900157)/51900165	51727840	51869055	51727840	51727840	51869055	51727840
46	1	PIN LATCH	In Rotation kit (51900157)/51900165	51716488	←	←	←	←	←
47	2	O-RING	In Rotation kit (51900157)/51900165	95676490	←	←	←	←	←
48	1	PIN	In Rotation kit (51900157)/51900165	95034005	←	←	←	←	←

"PROMAXX™" Jackhammer Models

JX35 & JX35S

REF. NO.	QTY	NAME OF PART	REMARKS	SHANK SIZE →					
				7/8 x 4-1/4	7/8 x 3-1/4	1 x 4-1/4	7/8 x 4-1/4	7/8 x 3-1/4	1 x 4-1/4
				JX35- STD 51992774	JX35- OPT-A 51992782	JX35- OPT-B 51992790	JX35S- STD 51992808	JX35S- OPT-A 51992816	JX35S- OPT-B 51992824
49	1	PIN	In Rotation kit (51900157)/51900165	95363412	←	←	←	←	←
50	1	SPRING PLUNGER	In Rotation kit (51900157)	51952836	←	←	←	←	←
51	1	CAPSCREW		51998268	←	←	←	←	←
52	1	WASHER		51948016	←	←	←	←	←
53	1	NUT		51999514	←	←	←	←	←
54		MUFFLER					51863397	←	←
55	1	STUD, IL FILL					51875128	←	←
56	1	O-RING, OIL FILL STUD					95097671	←	←
OPTIONS (Furnished only when specially ordered)			CPN						
	1	Option, Wet		51900116	←	←	←	←	←
	1	.TUBE, WATER	51900124						
	1	. O-RING	95097648						
	1	.PLUG	51900173						
	1	.PLUG	95077145						
	1	CONNECTION, WATER HOSE		50975549	←	←	←	←	←
60	1	.Stud, water	50028018						
61	1	.Rubber, water hose stem	50028059						
62	1	.Stem, water connection	50011008						
63	1	.Nut, water connection	50028042						
64	1	.Water, Valve	50028000						
80	1	D HANDLE		51900074	←	←	←	←	←
80	2	BOLT		95442554	←	←	←	←	←

“PROMAXX™” Jackhammer Models

JX35 & JX35S

REF. NO.	QTY	NAME OF PART	CPN	SHANK SIZE →					
				7/8 x 4-1/4 JX35- STD 51992774	7/8 x 3-1/4 JX35- OPT-A 51992782	1 x 4-1/4 JX35- OPT-B 51992790	7/8 x 4-1/4 JX35S- STD 51992808	7/8 x 3-1/4 JX35S- OPT-A 51992816	1 x 4-1/4 JX35S- OPT-B 51992824
80	2	WASHER		95064705	←	←	←	←	←
		KIT, ROTATION (7/8 in. hex x 3-1/4 in. long shank)(22mm hex x 83mm long shank)			51994317			51994317	
37	1	.Nut, spline	51988962						
42	1	.Nut, rifle	51984334						
43	1	.Spring, clutch	51715431						
44	1	.Chuck	51710861						
	3	.Pin spline nut	95675971						
		Kit, Rotation (7/8 in. hex x 4-1/4 in. long shank)(22mm hex x 108mm long shank)		51994309			51994309		
37	1	.Nut, spring	51988962						
42	1	.Nut, rifle	51984334						
43	1	.Spring, clutch	51715431						
44	1	.Chuck	51710853						
	3	.Pin, spline nut	95675971						
		KIT, ROTATION (1 in. hex x 4-1/4 in. long shank)				51994325			51994325
37	1	.Nut, spline	51988962						
42	1	.Nut, rifle	51984334						
43	1	.Spring, clutch	51715431						
44	1	.Chuck	51710846						
	3	.Pin, spline nut	95675971						
		KIT, LATCH (3-1/4 in.) [83mm] long shank			51900157			51900157	
45	1	.Latch	51869055						
46	1	.Pin, latch	51716488						
47	2	.O-Ring	95676490						

"PROMAXX™" Rockhammer Models

JX35 & JX35S

REF. NO.	QTY	NAME OF PART	CPN	SHANK SIZE →					
				7/8 x 4-1/4	7/8 x 3-1/4	1 x 4-1/4	7/8 x 4-1/4	7/8 x 3-1/4	1 x 4-1/4
		KIT, ROTATION (3-1/4 in.) [83mm] long shank (cont.)			51900157			51900157	
48	1	.Pin	95034005						
49	1	.Pin	95363412						
50	1	. Spring	51952836						
		KIT, ROTATION (4-1/4 in.) [108mm] long shank		51900165		51900165			51900165
45	1	.Latch	51727840						
46	1	.Pin, latch	51716488						
47	2	.O-Ring	95676490						
48	1	.Pin	95034005						
49	1	.Pin	95363412						
50	1	.Spring	51952836						
LUBRICATION (Furnished Only When Specially Ordered)									
	1 gal	Rock Drill Oil (Light)	51378701						
	5 gal	Rock Drill Oil (Light)	51378727						
	55 gal	Rock Drill Oil (Light)	51378743						
	1 gal	Rock Drill Oil (Medium)	51378693						
	5 gal	Rock Drill Oil (Medium)	51378719						
	55 gal	Rock Drill Oil (Medium)	51378735						
OPTIONS (Furnished only when specially ordered)									
70	2	Flex Handle		52084956	←	←	←	←	←
	1	Stud		51984326	←	←	←	←	←
	4	Washer		51948016	←	←	←	←	←
	1	Muffler		51863397	←	←	←	←	←
	1	Stud, oil fill		51875128	←	←	←	←	←

"PROMAXX™" Jackhammer Models

JX35 & JX35S

REF. NO.	QTY	NAME OF PART	SHANK SIZE → CPN	7/8 x 4-1/4	7/8 x 3-1/4	1 x 4-1/4	7/8 x 4-1/4	7/8 x 3-1/4	1 x 4-1/4
				JX35- STD 51992774	JX35- OPT-A 51992782	JX35- OPT-B 51992790	JX35S- STD 51992808	JX35S- OPT-A 51992816	JX35S- OPT-B 51992824
AVAILABLE KITS									
		Kit, tune up		51900132	←	←	←	←	←
4	1	.Pin, dowel	95795803						
6	1	.Valve, throttle	51730562						
8	1	.Spring, throttle valve	51779775						
9	2	.O-Ring	95097705						
11	1	.O-Ring	95086112						
13	1	.Valve blow air	51730570						
14	1	.O-Ring	95676482						
16	1	.Pin	95034005						
19	1	.O-Ring	95086161						
30	1	.O-Ring	95086575						
39	2	.O-Ring	95097770						

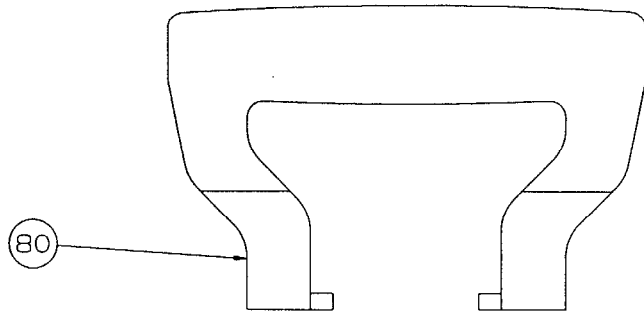

Open Center Grip Handle

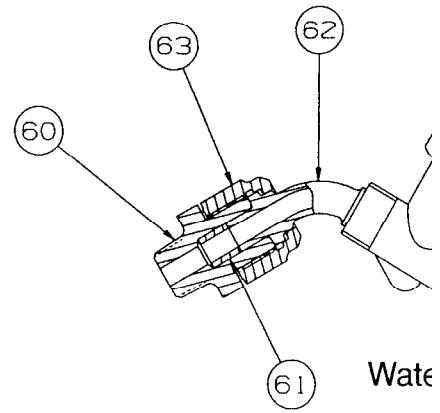

Water

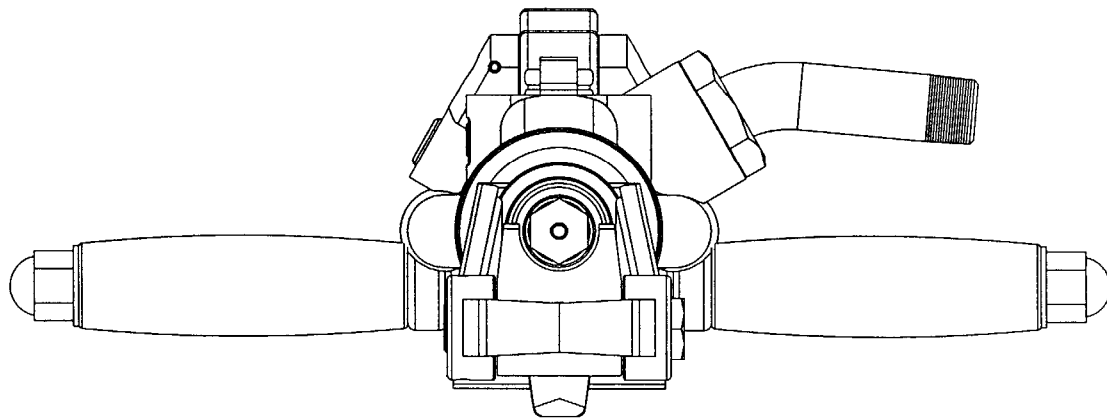
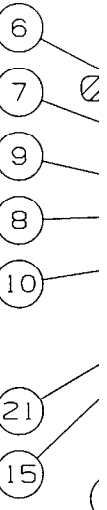
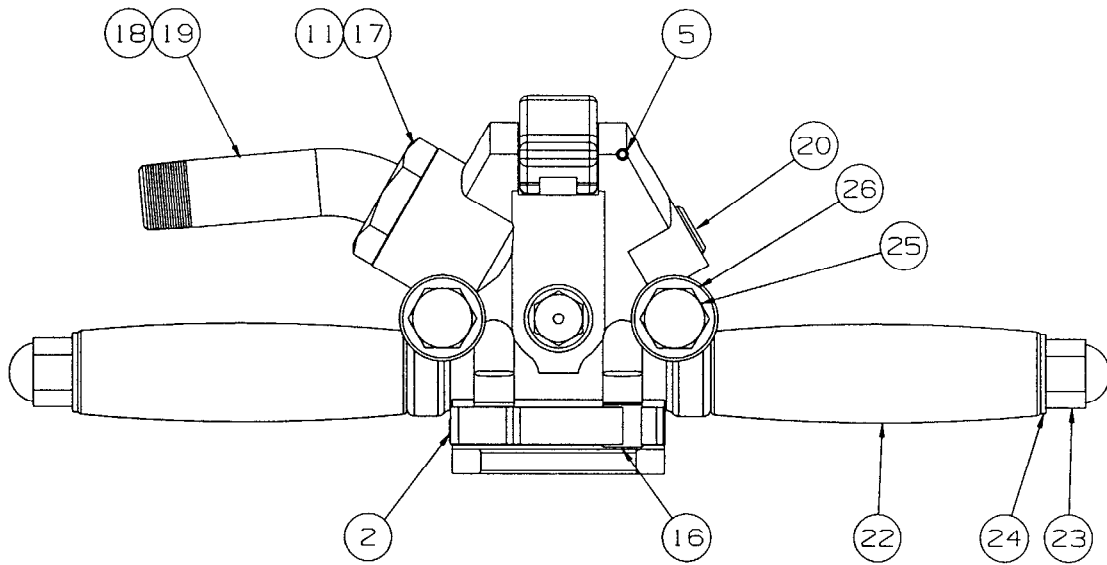

Optional Flex H

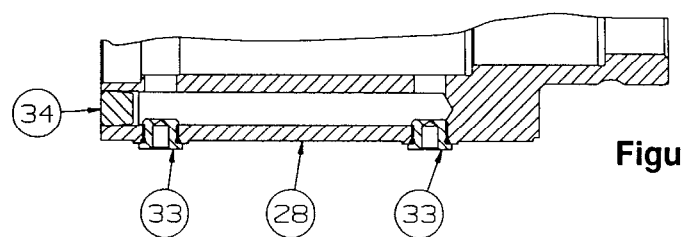
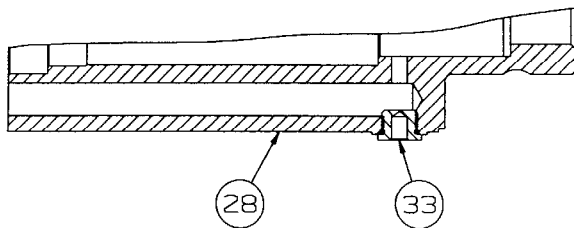
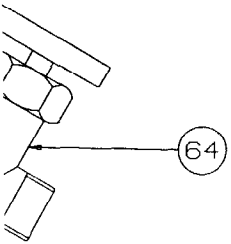
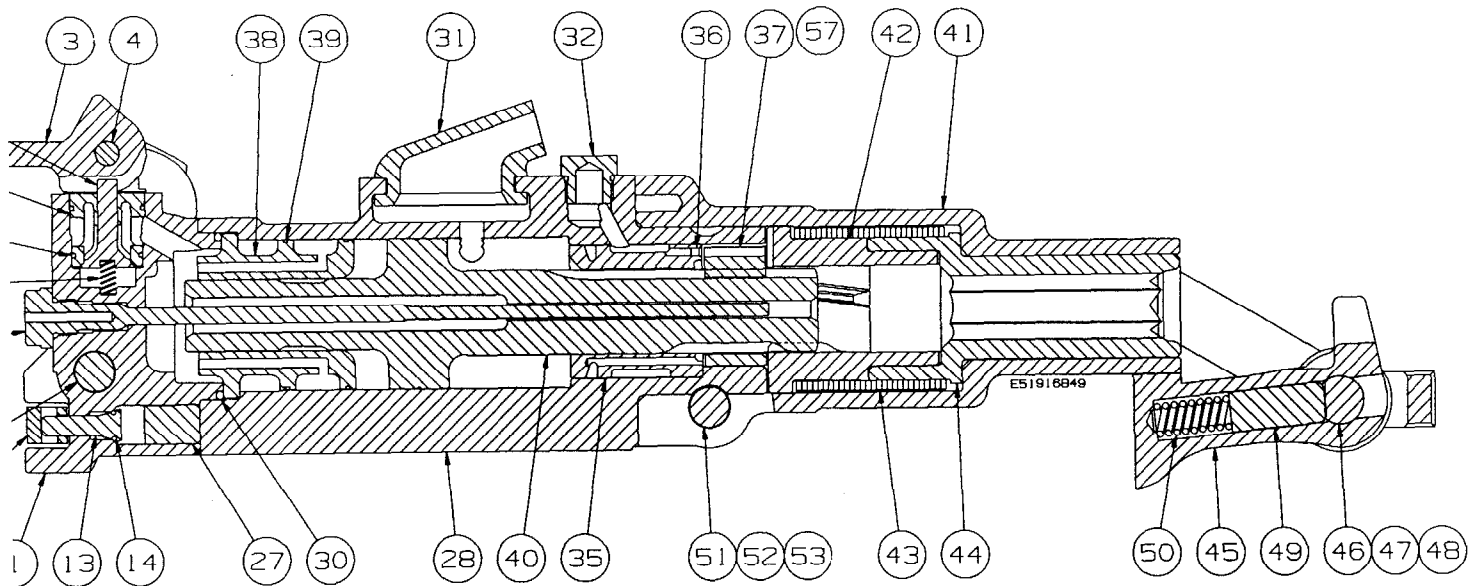

Figure 1.



Hose Connection



OIL FILL STUD O-RING-56 STUD-55 MUFFLER-54

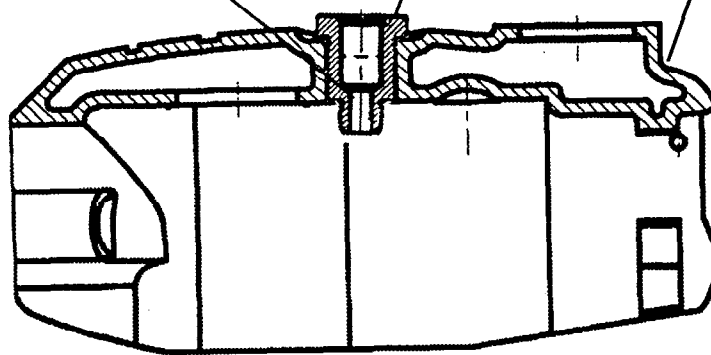

OPTIONAL MUFFLER



andle

PROMAXX™ Jackhammer Models JX35 & JX35S – Sectional Illustration
 (For Parts List, refer to Page 1 – 6)





GENERAL INFORMATION

June 29, 1996

1. GENERAL.

“PROMAXX™” Jackhamer Models JX35 & JX35S (jackhamer) are hand-held, light-duty, rotating bit, pneumatic rock drills with a detent control lever and a separate blow air control lever for independent operation of the blow air.

The jackhamer is capable of drilling 1-1/4 to 1-1/2 in. (32 to 38mm) diameter holes up to 10 ft. (3 m) deep in medium to hard rock. It is particularly suitable for construction work, medium industrial maintenance work, and for general utility work in quarries and mines.

2. STANDARD EQUIPMENT.

Each standard jackhamer is a complete unit ready to be put into service with proper lubrication. There are no extra parts or special fittings required.

The standard jackhamer has a chuck for a 7/8 in. Hex. x 4-1/4 in. long (22mm Hex. x 108mm long) jackhamer shank.

NOTICE**3. JACKHAMER COMBINATIONS.**

The following list shows the model and part numbers for all available jackhamer combinations:

a. Standard:**1. JX35-STD (51992774).**

This jackhamer includes a fronthead chuck and latch which accommodates a 7/8 in. Hex. x 4-1/4 in. (22mm x 108mm) long drill steel shank.

2. JX35S-STD (51992808).

This jackhamer includes a fronthead chuck and latch which accommodates a 7/8 in. Hex. x 4-1/4 in. (22mm x 108mm) long drill steel shank and also includes a muffler.

b. Optional:**1. JX35-OPT-A (51992782).**

This jackhamer includes a fronthead chuck and latch which accommodates a 7/8 in. Hex. x 3-1/4 in. (22mm Hex. x 83mm) long drill steel shank.

2. JX35-OPT-B (51992790).

This jackhamer includes a fronthead chuck and latch which accommodates a 1 in. Hex. x 4-1/4 in. (25mm Hex. x 108mm) long drill steel shank.

3. JX35S-OPT-A (51992816).

This jackhamer includes a fronthead chuck and latch which accommodates a 7/8 in. Hex. x 3-1/4 in. (22mm Hex. x 83mm) long drill steel shank and a muffler.

4. JX35S-OPT-B (51992824).

This jackhamer includes a fronthead chuck and latch which accommodates a 1 in. Hex. x 4-1/4 in. (25mm Hex. x 108mm) long drill steel shank and a muffler.

4. LUBRICATION.

A high-quality rock drill oil conforming to the physical and chemical properties outlined in the instruction manual must be added to the operating air supply to lubricate the moving parts of the jackhamer. The method of lubrica-

tion depends on actual operating conditions and customer preference:

a. For intermittent operation with an air-supply hose no longer than 50 ft. (15m), a compressor-mounted lubricator can be used.

b. For continuous operation during an eight hour shift, an Ingersoll-Rand® 35364322, or other constant feed lubricator, should be installed in the air supply line about 11.5 ft. (3.5m) from the jackhammer. The 35364322 has a capacity of 1 U.S. pint (0.47 L) and will be furnished when specially ordered.

c. The piston stem bearing (Figure 1, 35, Section 2) in the front end of the housing (Figure 1, 28, Section 2) must also be checked every eight hour shift if not sooner and oil level maintained. The oil fill plug (Figure 1, 32, Section 2) is located under the exhaust deflector on the jackhammer.

5. OPTIONAL EQUIPMENT

Optional equipment is only furnished when specially ordered. Refer to Section 2 for part numbers for the available options.

a. WET OPTION.

This option is used for dustless, wet drilling where minimum air consumption is required.

b. MUFFLER.

An add on muffler is available for the jackhammer without one.

The muffler assembly is used to reduce jackhammer noise without hindering performance. This assembly is available for jackhammers that do not have a muffler.

c. FLEX HANDLE.

This handle is used in place of the standard handle to reduce the amount of vibration that the operator encounters.

d. OPEN CENTER GRIP HANDLE.

This handle is mounted to the backhead end of the jackhammer and allows for ease of transportation as well as an optional operator handle.

NOTICE

Refer to IM6097, "Instruction Manual For "PROMAXX™" Jackhammer Models JX35 & JX35S" for maintenance instructions, and RM6113 "Maintenance and Repair For "PROMAXX™" Jackhammer Models JX35 & JX35S" for repair instructions.



Worldwide Ingersoll-Rand sales offices

U.S.A.

U.S. C&M OFFICES

Bathlehem, PA 18017-2293
1495 Valley Center Pkwy.
215/882-8800

Boston, MA 02125
33 Locust Street
617/288-8988

Casper, WY 82601
3273 N. I-25 Frontage Road
307/237-4259

Denver, CO 80207
5805 East 39th Ave.
303/399-1580

East Hanover, NJ 07936
98 Route #10
201/887-1212

Elkridge, MD 21227
5681 Main Street
410/796-3200

Gray, TN 37615
Suncrest Drive
615/477-3114

Houston, TX 77001
2210 McAllister
713/681-9221

Knoxville, TN 37922 (C&M)
112 Glenleigh Court
Suite #1
615/966-8800

Knoxville, TN 37912 (IRES)
4726 Clinton Hwy.
615/525-0404

Milwaukee, WI 53225
12311 West Silver Springs Dr.
414/461-7810

Nashville, TN 37229
310 S. Second St.
615/254-1811

New Castle, DE 19702
91 Christiana Road
302/324-9040

New Cumberland, PA 17070
Exit 15 on Rt. 83
4 miles south of Harrisburg
717/938-1441

New England
300 Turnpike Rd. -Route 9
Southboro, MA 01772
508/481-1350

Philadelphia
Route 309
Montgomeryville, PA 18936
215/855-9990

Phoenix, AZ 85007
820 N. 17th Ave.
602/258-6493

Pico Rivera, CA 90660
5211 Paramount Blvd.
310/948-3801

Portland, OR 97214
240 South East Clay Street
503/232-0151

Sacramento, CA 95836
1851 Bell Avenue
916/641-1994

San Leandro, CA 94577
1944 Marina Blvd.
510/357-9131

Scranton, PA 18505
605 Davis St.
717/346-3885

Seattle, WA 98168
11222 E. Marginal Way, S.
206/762-7400

U.S. C&M FACTORIES ROCK DRILLS

**Rotary blasthole deephole,
monitoring rigs**
Ingersoll-Rand Co.
Rotary Drill Division
2100 N. First St.
Garland, TX 75040
214/495-8181

**Downhole Drills and Bits; Pneumatic
and Hydraulic Crawler Drills; Anchor
Drills; Breakers and Jackhamers™.**
Ingersoll-Rand Co.
Rock Drill Division
7500 Shadwell Drive
Roanoke, VA 24019-5198
703/362-3321

COMPACTORS, PAVING MILLERS, ASPHALT PAVERS AND FORKLIFTS

Ingersoll-Rand Co.
Road Machinery Division
Ingersoll Drive
Shippensburg, PA 17257
717/532-9181

UNDERGROUND EQUIPMENT

**Roadheaders; drill jumbos, diesel-
powered production and utility equip-
ment (scoops, haul dumps, etc.)**
Contact Rock Drill Division
Roanoke, VA

Split Set rock stabilizers
Simmons - Rand Co.
Split Set Division
Suite 300
100 Thanet Circle
Princeton, NJ 08540-3662
609/921-8688

AIR COMPRESSORS

**Portable compressors, Generator
Sets and Light Plants**
Ingersoll-Rand Co.
Portable Compressor Division
P.O. Box 868
501 Sanford Ave.
Mocksville, NC 27028
704/634-3561

Small Compressor Plant
Ingersoll-Rand Co.
101 Industrial Drive
Campbellsville, KY 42718
502/465-3511

Centrifugal compressors (Centac)

Ingersoll-Rand Co.
Centrifugal Compressor Division
Route 45
Mayfield, KY 42066
502/247-8640

Reciprocating and rotary-screw compressors

Ingersoll-Rand Co.
Air Compressor Group
P.O. Box 1600
800A Beaty St.
Davidson, NC 28036
704/892-7100

PUMPS

Engineered centrifugal pumps

Ingersoll-Rand Co.
P.O. Box 486
Phillipsburg, NJ 08865
201/859-7000

Reciprocating pumps and standard centrifugal pumps

Ingersoll-Rand Co.
P.O. Box 656
Allentown, PA 18105
215/433-6411

Vertical turbine pumps

Ingersoll-Rand Co.
Vertical Turbine Pump Division
Hastings, NE 68901
402/463-1306

TOOLS, WINCHES

Ingersoll-Rand Co.
Power Tool Division
P.O. Box 1776
Liberty Corner, NJ 07938
201/647-6000

LIQUID/SOLID SEPARATORS

Ingersoll-Rand Co.
Impco Division
150 Burke St.
Nashua, NH 03061
603/882-2711

CANADA

Surface and underground equipment Tools and Industrial equipment

Ingersoll-Rand Canada Inc.
2360 Millrace Court
Mississauga, Ontario L5N1W2
(1)416/858-8480

Ingersoll-Rand Canada, Inc.
2250 Hymus Blvd
Dorval, Quebec H9P1J9
(1) 514/683-9157

MEXICO

All equipment

Ingersoll-Rand, S.A. de C.V.
Boulevard Centro
Industrial #11
Fracc. Industrial
Puente de Vigas
Tlalnepantla,
54090 Edo. de Mexico
Mexico
52 (5) 390-40-21
52 (5) 390-24-11

SOUTH AMERICA

USA, Miami, Florida
1 (305) 599-0500

Chile - Santiago
56 (2) 41-198

Colombia - Bogota
57 (1) 219-1406/1460

Venezuela - Caracas
58 (2) 239-9369

EUROPE

Austria - Vienna
43 (222) 83-05-250

Belgium - Brussels
32 (02) 216-99-95

France - Trappes
33 (3) 050-61-10

Germany - Ratingen
49 (2102) 48090

*Italy - Milano
39 (02) 950561

Netherlands - Zoeterwoude
31 (071) 452200

Norway - Oslo
47 (02) 39-15-26

Spain - Madrid
34 (9) 1-671-07-00

Sweden - Spanga
46 (08) 750-59-20

United Kingdom - London
44 (01) 584-5070

*Also for Bulgaria, Czechoslovakia,
Hungary, Poland, Rumania, USSR,
Yugoslavia.

AFRICA-MIDDLE EAST

Egypt - Cairo
(02)341-5190

South Africa - Alrode
27 (011) 864-3930

ASIA-PACIFIC

Australia-Melbourne
61-(3) 794-1611

Hong Kong
852 (5) 270183

India-Bombay
91 (22) 4936765

Japan - Tokyo
81 (3) 403-0841/7

Korea - Seoul
82 (2) 776-2541

New Zealand - Auckland
64 (9) 885096

Philippines - Manila
63 (2) 89-85-06/08

Singapore
(65) 8611555

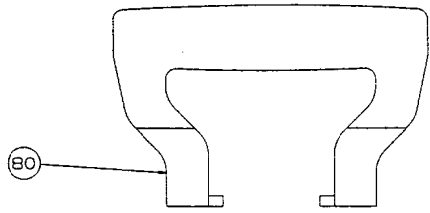

Open Center Grip Handle

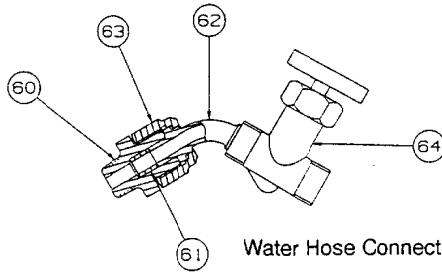

Water Hose Connection

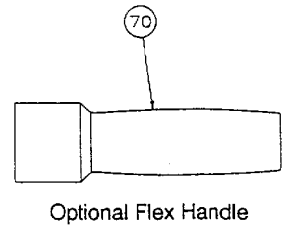
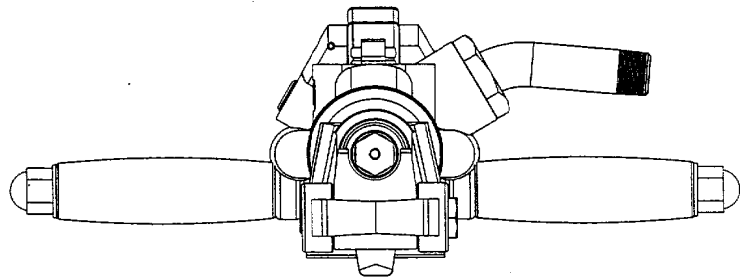
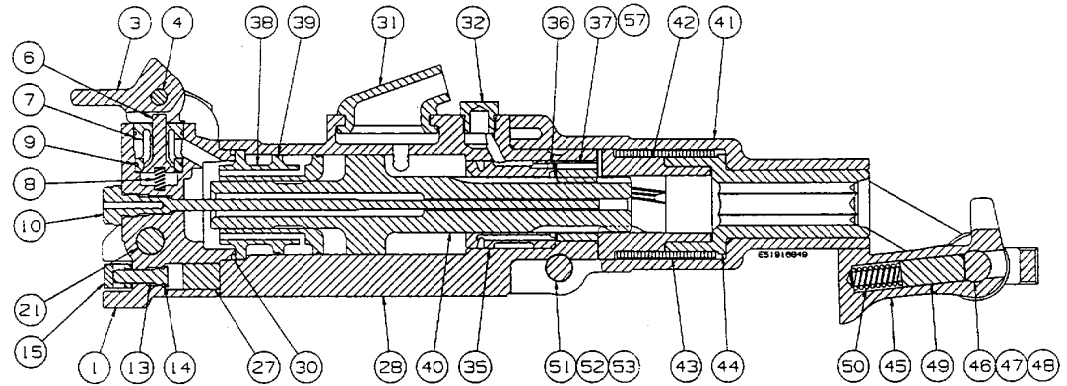
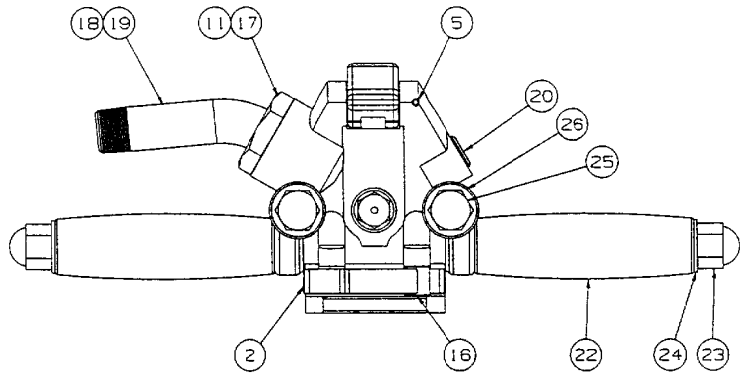

Optional Flex Handle

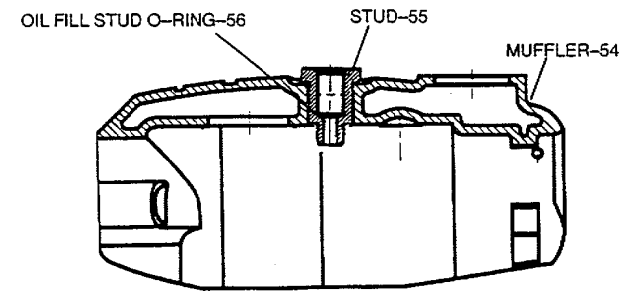

OPTIONAL MUFFLER

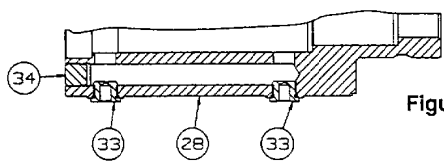
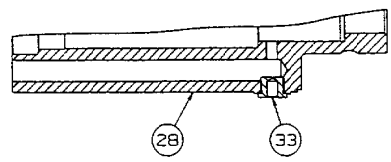

Figure 1. "PROMAXX"™ Jackhammer Models JX35 & JX35S – Sectional Illustration
(For Parts List, refer to Page 1 – 6)