

# INGERSOLL-RAND®

---

## PARTS LIST

**For Paving Breaker Models:  
PB35A, PB35AS, PB50A, PB50AS,  
(With/Without Flex Handles)**

Designed and Built by Ingersoll-Rand Company  
Roanoke, Va. 24019-5198 U.S.A.



Certified ISO-9001 (ANSI/ASQC Q91)  
Certification No. QSR-80



NOTE: THE VERTICAL BAR SHOWN TO THE LEFT OF TEXT DESIGNATES A REVISION HAS BEEN MADE SINCE THE PREVIOUS PRINTING.

<b>SAFETY</b> .....	<b>1-1</b>
<b>SECTIONAL ILLUSTRATION</b> .....	<b>2-1</b>
<b>PARTS LIST PAVING BREAKERS</b> .....	<b>2-2</b>
<b>GENERAL INFORMATION</b> .....	<b>3-1</b>

1. The **NAME** of each part as listed.
2. The **PART NUMBER** as listed or stamped on the part.
3. The **SERIAL NUMBER** of the equipment.

DO NOT use illustration numbers when ordering service parts. To save time, send all orders for parts to the nearest branch office or agent. IF IT IS NECESSARY TO SEND ANY PART OF THIS EQUIPMENT TO THE FACTORY, INQUIRE AT OUR NEAREST BRANCH OFFICE OR AGENT FOR SPECIAL INSTRUCTIONS.

SERIAL NUMBER IS STAMPED  
IN THIS AREA.

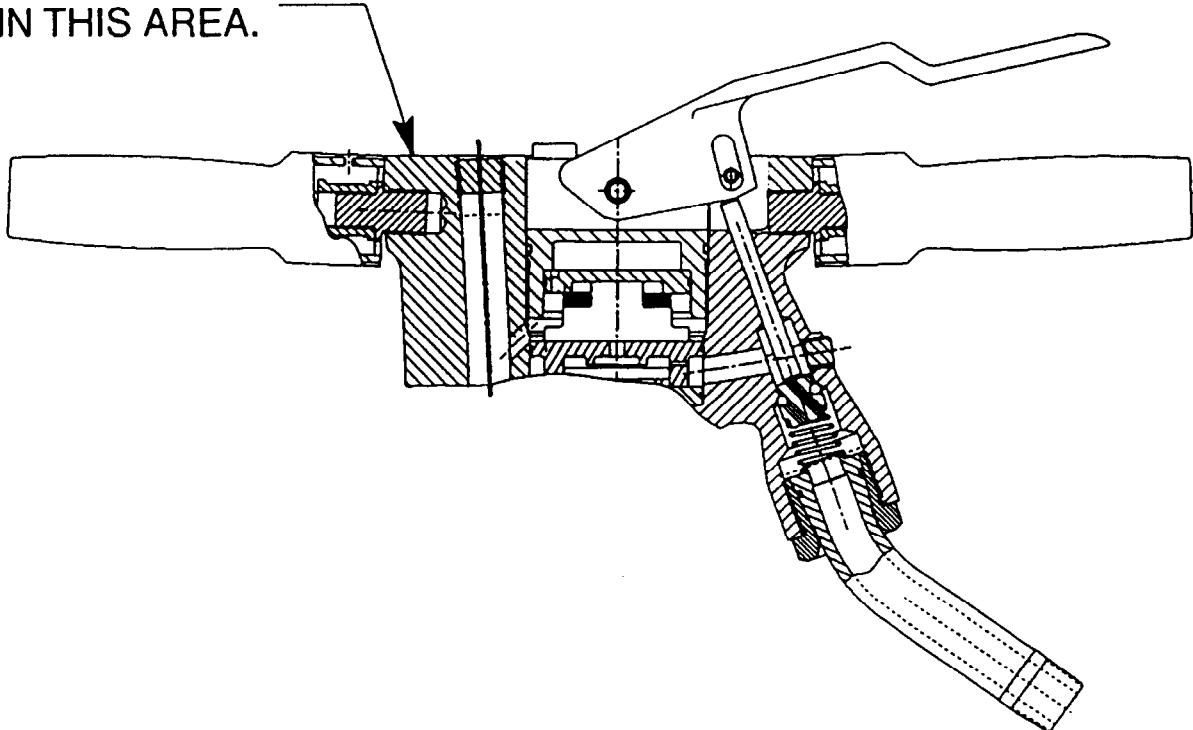

*When the life of the machine has expired, it is recommended that the machine be disassembled, degreased and parts be separated by material so that they can be recycled.*

## **NOTICE**

**SAVE THESE INSTRUCTIONS. DO NOT DESTROY.**

***The use of repair parts other than those included within the Ingersoll-Rand® approved parts list may create hazardous conditions over which Ingersoll-Rand® Company has no control. Therefore Ingersoll-Rand® Company cannot be held responsible for equipment in which non-approved repair parts are installed.***

***All information, illustrations, and specifications in this manual are based on the latest information available at the time of publication. Product improvement is a continuing goal at Ingersoll-Rand®. Design and specifications are subject to change without notice or obligation.***

***When the life of the machine has expired, it is recommended that the machine be disassembled, degreased and parts be separated by material so that they can be recycled.***

Alphabetical Index

<u>Title</u>	<u>Page No.</u>
Introduction .....	1
Safety Alert Symbol and Signal Words .....	1
Safety First .....	1
Safety Precautions .....	2

**NOTE:** THE VERTICAL BAR SHOWN TO THE LEFT OF TEXT DESIGNATES A REVISION HAS BEEN MADE SINCE THE PREVIOUS PRINTING.

**1. INTRODUCTION.**

This section contains important safety information for the Paving Breaker Models PB35A, PB35AS, PB50A & PB50AS.

**2. SAFETY FIRST.**

**SAFETY FIRST** is the primary concern for the protection of both, personnel and the paving breaker during any phase of operation. All personnel must thoroughly understand all safety precautions before operating or doing any maintenance work on the paving breaker.

**3. SAFETY PRECAUTIONS.**

The Safety Precautions listed are intended to make all personnel aware of the hazards while working on or near a paving breaker. All personnel must use common sense and a good working practice while operating and maintaining these paving breakers. The safety precautions listed are of a general nature and cannot cover every possible situation:

1. Always wear approved hard hat, safety shoes, safety glasses, nose mask, and ear protection when near a paving breaker in operation. Failure to wear approved safety equipment could result in bodily injury.

2. Use only Ingersoll-Rand® replacement parts.
3. Prolonged exposure to excessive noise levels without the use of proper ear protection can result in permanent hearing loss.
4. Do not indulge in horseplay. Distractions can cause accidents.
5. Keep your hands off the throttle lever until it is time to start breaker operation.
6. Maintain a steady balance at all times.
7. Never put your face close to the paving breaker.
8. Never rest the paving breaker on your foot.
9. Never point the paving breaker at anyone.
10. Never start the paving breaker when it is lying on the ground.
11. Compressed air is dangerous. Never point an air hose at yourself or co-workers. Never blow your clothes free of dust with compressed air.
12. Be sure all hose connections are tight. A loose hose not only causes leaks, but it

may come completely off the breaker, whip around, and injure the operator and others in the area. Attach safety cables to all hoses to prevent injury if a hose is accidentally broken.

13. Never disconnect a pressurized air hose. Before disconnecting a hose, shut-off the air at the compressor and bleed the paving breaker.

14. Do not operate the paving breaker without a paving breaker tool locked in the fronthead. Hold the tool firmly against the work.

15. Always keep both hands on the handle while operating the paving breaker.

16. The operator must keep his legs and feet clear of the paving breaker tool to prevent injury if the tool breaks. If a tool breaks, the paving breaker (with a piece of broken tool projecting from fronthead) will suddenly drop to the ground.

17. Do not "ride" the paving breaker with one leg over the handle. The operator can be injured if the tool breaks while he is riding the paving breaker.

18. Know what is underneath the material you are about to break. Be alert for any buried water, gas, sewer, telephone, or electric lines.

19. If you hit something, shut-off the paving breaker immediately and find out what it is. Use a shovel, not the paving breaker, to uncover the object carefully.

20. When using any solvent to clean parts, make sure that it meets current safety and health standards and that it is used in an area that is adequately ventilated.

#### 4. SAFETY ALERT SYMBOL AND SIGNAL WORDS.

 – This is the Safety Alert Symbol. When you see this symbol in this instruction manual, be alert to the presence of a hazard.

All personnel must understand the **DANGER, WARNING, CAUTION,** and **NOTICE** used throughout the text of this instruction manual. The **DANGER, WARNING, CAUTION,** and **NOTICE** are defined as follows:

#### **DANGER**

**DANGER IS USED TO INDICATE THE PRESENCE OF A HAZARD WHICH WILL CAUSE SEVERE PERSONAL INJURY OR DEATH IF THE WARNING IS IGNORED.**

#### **WARNING**

**WARNING IS USED TO INDICATE THE PRESENCE OF A HAZARD WHICH CAN CAUSE SEVERE INJURY OR DEATH IF THE WARNING IS IGNORED.**

#### **CAUTION**

**CAUTION IS USED TO INDICATE THE PRESENCE OF A HAZARD WHICH WILL OR CAN CAUSE PERSONAL INJURY, OR PROPERTY DAMAGE IF THE WARNING IS IGNORED.**

#### **NOTICE**

Notice is used to notify people of installation, operation, or maintenance information which is important but not hazard related.

By understanding what **DANGER**, **WARNING**, **CAUTION**, and **NOTICE** mean; and using good judgment and common sense; all personnel can avoid injuring themselves and/or damaging the paving breaker.

**5. SAFETY PRECAUTIONS.**

The Safety Precautions listed are intended

to make all personnel aware of the hazards while working on or near a paving breaker. All personnel must use common sense and a good working practice while operating and maintaining the paving breaker. The safety precautions listed are of a general nature and cannot cover every possible situation:

	<b>⚠ WARNING</b>
	Do not start the paving breaker while it is lying on the ground.

	<b>⚠ WARNING</b>
	Keep your hands off the throttle lever until it is time to start paving breaker operation.

	<b>⚠ CAUTION</b>
	Always wear gloves when operating this tool.

	<b>⚠ WARNING</b>
	Keep legs and feet clear of the paving breaker tool to prevent injury if the tool breaks.

	<b>⚠ WARNING</b>
	Always wear safety shoes when operating this tool.

	<b>⚠ WARNING</b>
	Do not ride the paving breaker with one leg over the handle.

	<b>⚠ CAUTION</b>
	Always wear nose mask when operating this tool.

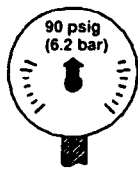
	<b>⚠ WARNING</b>
	Operate at 90-100 psig (6.2-6.9 bar) Maximum air pressure.

	<b>⚠ WARNING</b>
	Always wear approved hard hat when operating this tool.

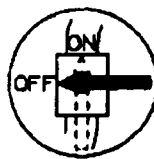
	<b>⚠ WARNING</b>
	Always turn off the air supply and bleed and disconnect the air supply hose before installing, removing or adjusting any accessory on this tool.

	<b>⚠ CAUTION</b>
	Always wear eye protection when operating this tool.

	<b>⚠ WARNING</b>
	Do not operate the paving breaker without a paving breaker tool locked in the fronthead. Hold the tool firmly against the work.

	<b>⚠ CAUTION</b>
	Always wear hearing protection when operating this tool.

	<b>⚠ WARNING</b>
	Know what is underneath the material you are about to break. Be alert for any buried water, gas, sewer, telephone, or electric lines.

	<b>⚠ WARNING</b>
	Never rest the paving breaker on your foot.

	<b>⚠ WARNING</b>
	Do not use damaged, frayed or deteriorated air hose and fittings.

	<b>⚠ WARNING</b>
	Always keep both hands on the handles while operating the paving breaker.

	<b>⚠ WARNING</b>
	Keep body stance balanced and firm. Do not overreach when operating this tool.

	<b>⚠ WARNING</b>
	Air powered tools can vibrate in use. Vibration, repetitive motions or uncomfortable positions may be harmful to your hands and arms. Stop using any tool if discomfort, tingling feeling or pain occurs. Seek medical advice before resuming use.





# PARTS LIST

Revision 5

February 20, 1997

PAVING B

PB35A, PB3

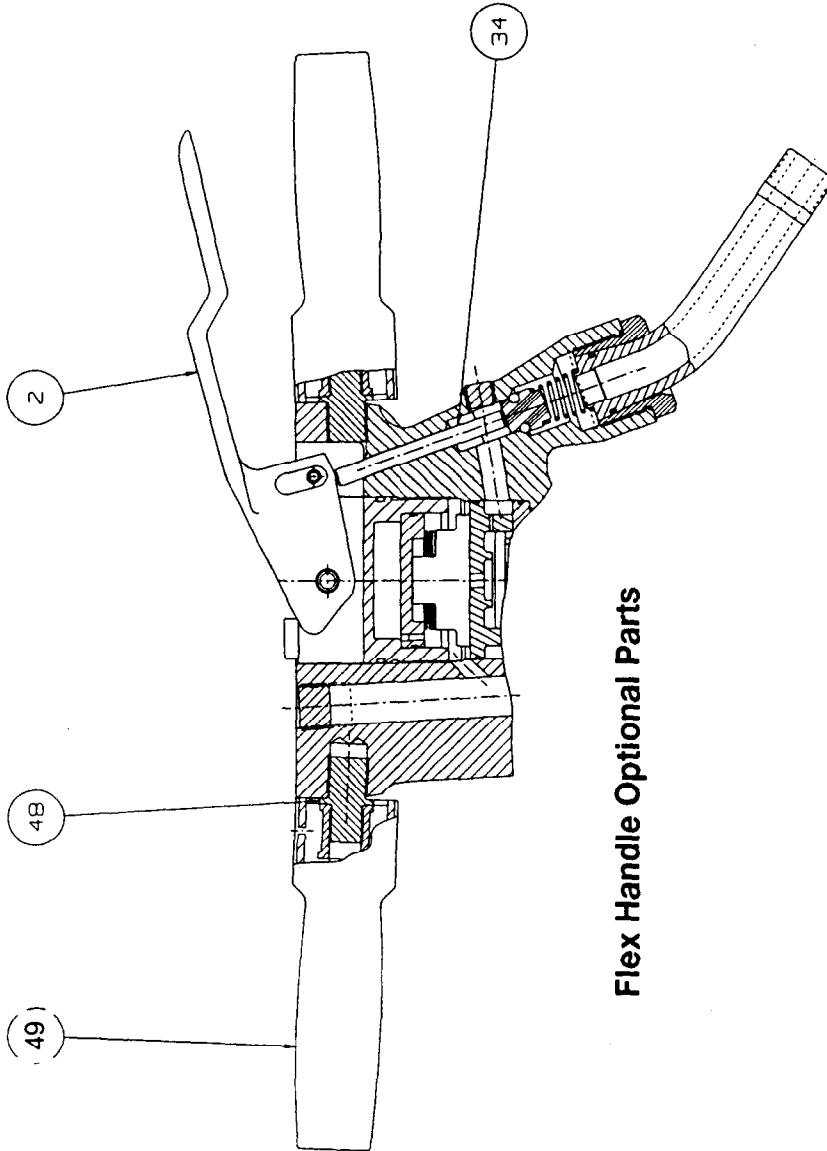

Flex Handle Optional Parts

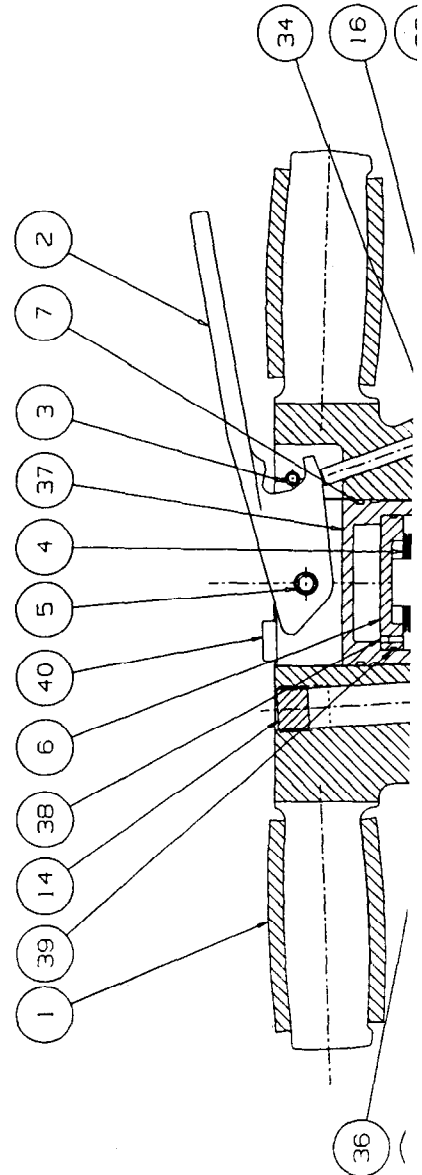

SECTION





BREAKER MODELS:

5AS, PB50A, PB50AS

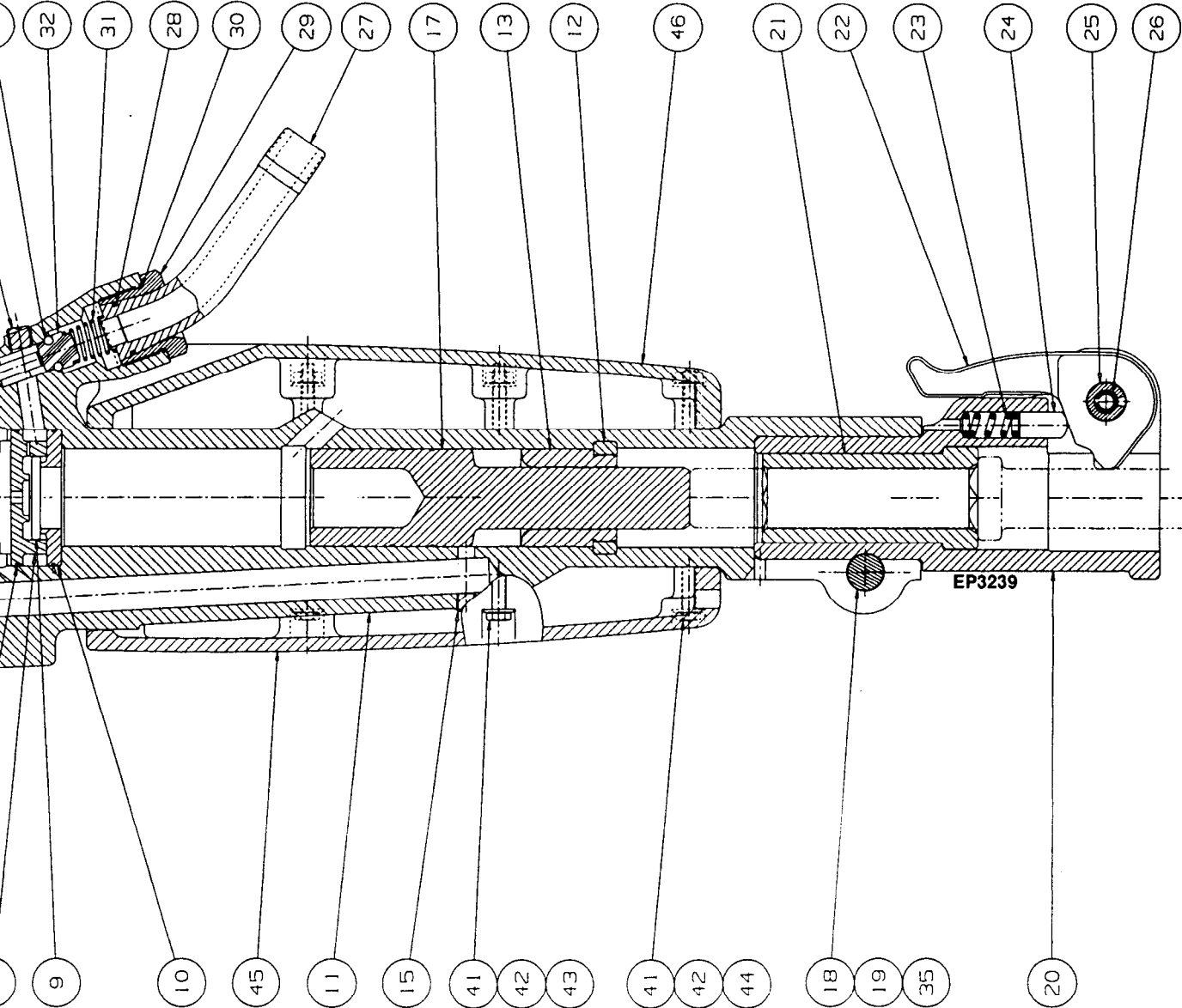

AL ILLUSTRATION

# PAVING BREAKER MODELS:

FLEX HANDLE – 52084936

FOR MODELS

PB50A-STD-F, PB50A-OPT-AF, PB50AS-STD-F, PB50AS-OPT-AF

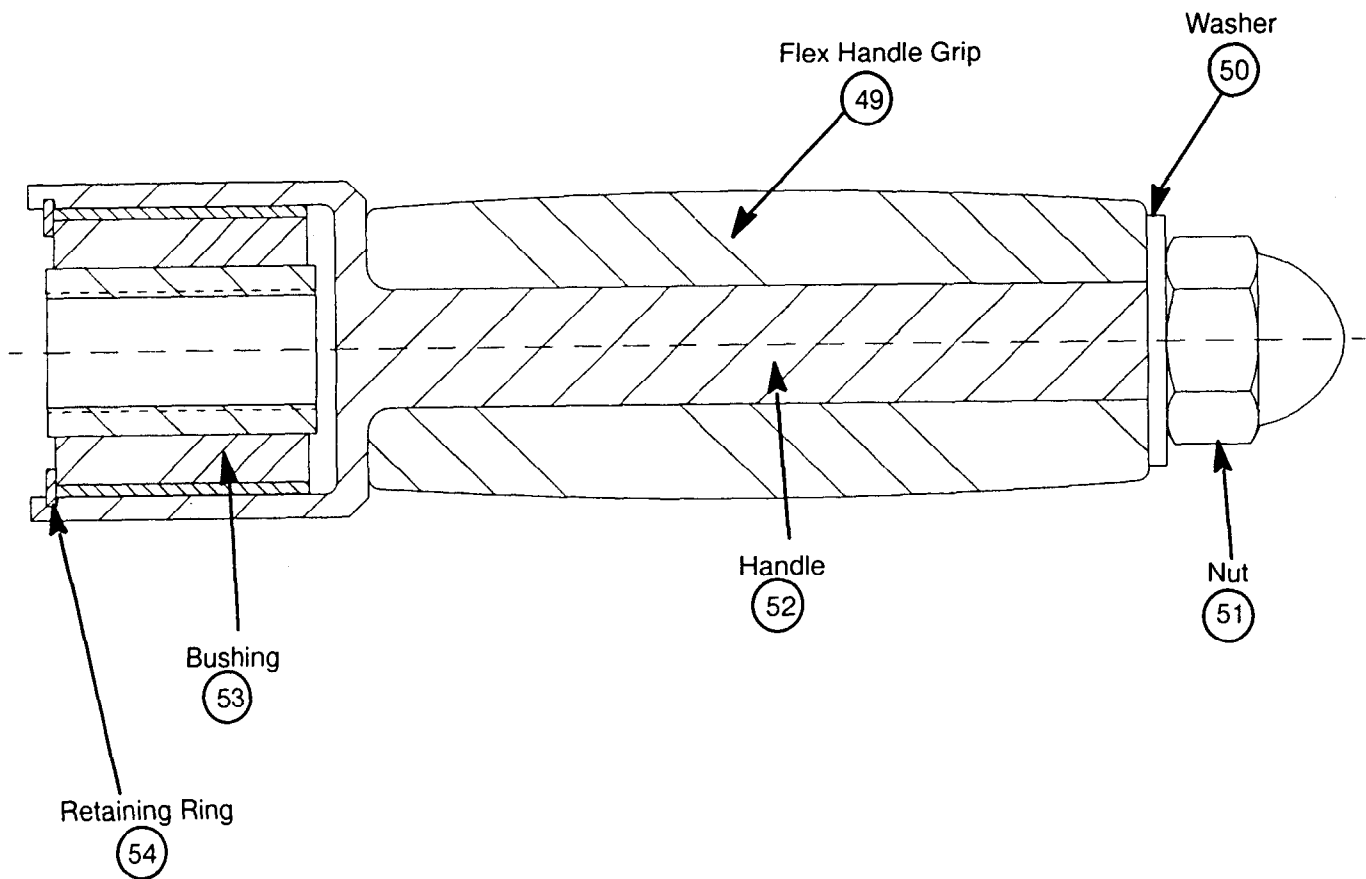

REF NO.	QTY	NAME OF PART	UNITED STATES		EUROPEAN COMMUNITIES		PB50A-STD 52085552	PB50A-OPT-A 52085560	PB50AS-STD 52085578	PB50A-OPT-A 520855
			PB35A 51296358	PB35AS 51357176	PB35A-OPT-A 51308609	PB35AS-OPT-A 51363687				
1	2	HANDLE SLEEVE	51299212	X	X	X	51952869	X	X	X
2	1	THROTTLE LEVER	51942175	X	X	X	X	X	X	X
3	1	ROLL PIN	95034005	X	X	X	X	X	X	X
4	3	WASHER	51293041	X	X	X	X	X	X	X
5	1	ROLL PIN	95098711	X	X	X	X	X	X	X
6	1	OILER PLATE	-	-	-	-	51900975	X	X	X
7	1	O-RING	-	-	-	-	95086211	X	X	X
8	1	VALVE CHEST	51291342	X	X	X	X	X	X	X
9	1	VALVE	NSS	X	X	X	X	X	X	X
10	1	VALVE COVER	51291359	X	X	X	X	X	X	X
11	1	BREAKER HOUSING	NSS	X	X	X	X	X	X	X
12	1	RETAINING BUSHING	NSS	X	X	X	X	X	X	X
13	1	PISTON SEAT	NSS	X	X	X	X	X	X	X
14	1	PIPE PLUG	95078655	X	X	X	X	X	X	X
15	1	PIPE PLUG	95033353	X	X	X	X	X	X	X
16	1	PIPE PLUG	95033361	X	X	X	X	X	X	X
17	1	PISTON	51376499	X	X	X	51381242	X	X	X
18	1	BOLT	95105482	X	X	X	51356947	X	X	X
19	1	NUT	95322541	X	X	X	95227112	X	X	X
20	1	FRONTHEAD	51919728	X	X	X	51917532	X	X	X
21	1	FRONTHEAD BUSHING	51291425	X	X	X	51306967	51307387	51306967	513073
22	1	STEEL RETAINING LEVER	NSS	X	X	X	X	X	X	X
23	1	SPRING	51952836	X	X	X	X	X	X	X
24	1	STEEL RET. LEVER PLUNGER	50019728	X	X	X	X	X	X	X
	1	ROLL PIN KIT	51792794	X	X	X	51792802	X	X	X
25	1	ROLL PIN	NSS	X	X	X	X	X	X	X
26	1	ROLL PIN	NSS	X	X	X	X	X	X	X
27	1	CONNECTION	51361855	X	X	X	51609295	X	X	X
28	1	O-RING	95086161	X	X	X	X	X	X	X
29	1	AIR CONNECTION CAP	51361798	X	X	X	X	X	X	X
30	1	O-RING	95086112	X	X	X	X	X	X	X
31	1	SPRING	50250539	X	X	X	X	X	X	X
	1	VALVE ASSEMBLY	51719615	X	X	X	X	X	X	X
32	1	VALVE	NSS	X	X	X	X	X	X	X
33	1	O-RING	NSS	X	X	X	X	X	X	X
34	1	THROTTLE PIN	51716975	X	X	X	X	X	X	X
35	1	WASHER	51948016	X	X	X	51369171	X	X	X

(For Sectional Illustration Refer To

NOTE: - BLANK  
X SAME AS THE NUMBER TO THE LEFT

**AVING BREAKERS**



PB50AS- OPT-A 085586	PB50AS- OPT-B 52085594	PB50A- STD-F 52085602	PB50A- OPT-AF 52085610	PB50AS- STD-F 52085628	PB50AS- OPT-AF 52085636	REMARKS
X	X	X	X	X	X	CONVERTER KIT (PB35A)
X	X	X	X	X	X	CONVERTER KIT (PB35A)
X	X	X	X	X	X	CONVERTER KIT (PB35A)
X	X	X	X	X	X	CONVERTER KIT (PB35A)
X	X	-	-	95064655	X	INC. IN MUFFLER KIT
X	X	-	-	95467924	X	INC. IN MUFFLER KIT
X	X	-	-	95838926	X	INC. IN MUFFLER KIT
X	X	-	-	95673992	X	INC. IN MUFFLER KIT
X	X	X	X	X	X	INC. IN MUFFLER KIT
X	X	X	X	X	X	INC. IN MUFFLER KIT
-	-	52084936	X	X	X	FLEX HANDLE OPTION
-	-	51913440	X	X	X	FLEX HANDLE OPTION
-	-	52084902	X	X	X	FLEX HANDLE OPTION
-	-	51948016	X	X	X	FLEX HANDLE OPTION
-	-	95914404	X	X	X	FLEX HANDLE OPTION
-	-	52082658	X	X	X	FLEX HANDLE OPTION
-	-	52091105	X	X	X	FLEX HANDLE OPTION
-	-	95955829	X	X	X	FLEX HANDLE OPTION
1307379	51716959	51307361	51307379	51307361	51307379	
X	X	X	X	X	X	
X	X	X	X	X	X	
X	X	X	X	X	X	
X	X	-	-	X	X	
-	-	-	-	-	-	
X	X	X	X	X	X	ROCK DRILL OIL (LIGHT)
X	X	X	X	X	X	ROCK DRILL OIL (LIGHT)
X	X	X	X	X	X	ROCK DRILL OIL (LIGHT)
X	X	X	X	X	X	ROCK DRILL OIL (MEDIUM)
X	X	X	X	X	X	ROCK DRILL OIL (MEDIUM)
X	X	X	X	X	X	ROCK DRILL OIL (MEDIUM)

er To Page 1)

NG BREAKERS



	PB50AS- OPT-B 52085594	PB50A- STD-F 52085602	PB50A- OPT-AF 52085610	PB50AS- STD-F 52085628	PB50AS- OPT-AF 52085636	REMARKS
	X	-	-	-	-	
	X	-	-	-	-	STANDARD FLEX HANDLE
	X	X	X	X	X	INC. IN TUNE-UP KIT
	X	X	X	X	X	INC. IN TUNE-UP KIT
	X	X	X	X	X	INC. IN TUNE-UP KIT
	X	X	X	X	X	CONVERTER KIT (PB35A)
	X	X	X	X	X	INC. IN TUNE-UP KIT CONVERTER KIT (PB35A)
	X	X	X	X	X	
	X	X	X	X	X	INC. IN TUNE-UP KIT
	X	X	X	X	X	
	X	X	X	X	X	NOT SOLD SEPARATELY
	X	X	X	X	X	NOT SOLD SEPARATELY
	X	X	X	X	X	NOT SOLD SEPARATELY
	X	X	X	X	X	
	X	X	X	X	X	
	X	X	X	X	X	
	51727105	51381242	X	X	X	
	X	X	X	X	X	
	X	X	X	X	X	
	51716959	51917532	X	X	X	
7	-	51306967	51307387	51306967	51307387	
	X	X	X	X	X	INC. STEEL RETAINER KIT
	X	X	X	X	X	INC. STEEL RETAINER KIT
	X	X	X	X	X	INC. STEEL RETAINER KIT
	X	X	X	X	X	INC. STEEL RETAINER KIT
	X	X	X	X	X	NOT SOLD SEPARATELY
	X	X	X	X	X	NOT SOLD SEPARATELY
	X	X	X	X	X	
	X	X	X	X	X	INC. IN TUNE-UP KIT
	X	X	X	X	X	
	X	X	X	X	X	INC. IN TUNE-UP KIT
	X	X	X	X	X	INC. IN TUNE-UP KIT
	X	X	X	X	X	INC. IN TUNE-UP KIT
	X	X	X	X	X	NOT SOLD SEPARATELY
	X	X	X	X	X	INC. IN TUNE-UP KIT
	X	51716983	X	X	X	STD. INC. IN TUNE-UP KIT FLEX HANDLE INC. IN TUNE- UP KIT
	X	X	X	X	X	

			UNITED STATES		EUROPEAN COMMUNITIES				
REF NO.	QTY	NAME OF PART	PB35A 51296358	PB35AS 51357176	PB35A- OPT-A 51308609	PB35AS- OPT-A 51363687	PB50A- STD 52085552	PB50A- OPT-A 52085560	PB50AS- STD 52085578
37	1	HOUSING PLUG	51291375	X	X	X	51900736	X	X
38	1	FILTER	-	-	-	-	51905156	X	X
39	1	O-RING	-	-	-	-	95097754	X	X
40	1	OILER FILL PLUG	-	-	-	-	51919173	X	X
41	16	WASHER	-	95064655	-	95064655	-	-	95064655
42	8	NUT	-	95467924	-	95467924	-	-	95467924
43	6	SCREW	-	95838926	-	95838926	-	-	95838926
44	2	SCREW	-	95673992	-	95673992	-	-	95673992
45	1	RIGHT SIDE MUFFLER	NSS	X	X	X	X	X	X
46	1	LEFT SIDE MUFFLER	NSS	X	X	X	X	X	X
47	2	FLEX HANDLE	-	-	-	-	-	-	-
48	2	FLEX HANDLE STUD	-	-	-	-	-	-	-
49	1	HANDLE GRIP	-	-	-	-	-	-	-
50	1	WASHER	-	-	-	-	-	-	-
51	1	NUT	-	-	-	-	-	-	-
52	1	HANDLE	-	-	-	-	-	-	-
53	1	BUSHING	-	-	-	-	-	-	-
54	1	RETAINING RING	-	-	-	-	-	-	-
		<b>OPTIONS</b>							
	1	FRONTHEAD ASSEMBLY	51303956	X	51304137	X	51307361	51307379	51307361
		LUBRICATOR	35364322	X	X	X	X	X	X
		<b>AVAILABLE KITS (Furnished only when specially ordered)</b>							
	1	TUNE-UP KIT	51310498	X	X	X	X	X	X
	1	STEEL RETAINER KIT	51310506	X	X	X	51358281	X	X
	1	MUFFLER KIT	-	51362648	-	X	-	-	X
		CONVERTER KIT PB35A CAN BE CONVERTED TO USE THE NEW STYLE OILER USING THIS OIL KIT	51955573	X	X	X	-	-	-
		<b>LUBRICATION (Furnished only when specially ordered)</b>							
		1 gal	51378701	X	X	X	X	X	X
		5 gal	51378727	X	X	X	X	X	X
		55 gal	51378743	X	X	X	X	X	X
		1 gal	51378693	X	X	X	X	X	X
		5 gal	51378719	X	X	X	X	X	X
		55 gal	51378735	X	X	X	X	X	X

(For Sectional Illustration Re

NOTE: - BLANK  
X SAME AS THE NUMBER TO THE LEFT



**NOTE:** THE VERTICAL BAR SHOWN TO THE LEFT OF TEXT DESIGNATES A REVISION HAS BEEN MADE SINCE THE PREVIOUS PRINTING.

### GENERAL.

Paving Breaker Models PB35A, PB35AS; PB50A, PB50AS (paving breakers) are (in consecutive order) light-duty, medium-duty, both paving breakers provide maximum performance at minimum cost. They are designed for general paving breaker work where their size and weight range are necessary. With the two-piece design (breaker housing and fronthed) the paving breakers are easier to disassemble and reassemble.

### STANDARD EQUIPMENT.

Each paving breaker is a complete unit ready to be put into service with proper lubrication. There are no extra parts or special fittings required.

The paving breakers can be ordered either with or without a muffler by designating PB35A, PB50A or for the non-muffled or PB35AS, PB50AS or for the muffled version.

### OPTIONAL EQUIPMENT.

Each optional paving breaker is the same as the standard paving breaker, but with added features. The optional equipped paving breaker combinations vary from: different fronthed bushings (for different size paving breaker shanks), flex handles (except the PB35A/AS) for less vibration, and mufflers (for noise reduction). The fol-

lowing "PAVING BREAKER COMBINATIONS" lists the combinations available for the paving breakers.

### # **NOTICE**

### PAVING BREAKER COMBINATIONS FOR PB35A & PB35AS.

The following lists the model and part number for all PB35A & PB35AS Paving Breakers combinations:

**NOTE:** The PB35 series breakers Do Not have a built oil reservoir. They are lubricated by using a constant feed air line lubricator.

#### 1) Standard:

a. **PB35A-STD (51296358).** This paving breaker includes a fronthed bushing which accommodates a 1 in. Hex. x 4-1/4 in. long (25mm Hex. x 108mm long) paving breaker shank.

b. **PB35AS-STD (51357176).** This paving breaker includes a fronthed bushing which accommodates a 1 in. Hex. x 4-1/4 in. long (25mm Hex. x 108mm long) paving breaker shank, and also includes a muffler.

#### 2) Optional:

a. **PB35A-OPT-A (51308609).** This paving breaker includes a fronthed bushing which accommodates a 1 in. Hex. x 4-1/4 in. long (25mm Hex. x 108mm long) paving breaker shank.

**NOTICE:** This paving breaker is for European customers.

b. **PB35AS-OPT-A (51363687)**. This paving breaker includes a fronthead bushing which accommodates a 1 in. Hex. x 4-1/4 in. long (25mm Hex. x 108mm long) paving breaker shank, and also includes a muffler.

# **NOTICE**

**PB35AS-OPT-A Paving Breaker is for European customers.**

**PAVING BREAKER COMBINATIONS FOR PB50A & PB50AS.**

The following lists the model and part number for all PB50A & PB50AS Paving Breakers combinations:

**1) Standard:**

a. **PB50A-STD (52085552)**. This paving breaker includes a fronthead bushing which accommodates a 1-1/4 in. Hex. x 6 in. long (28mm Hex. x 152mm long) paving breaker shank.

b. **PB50A-STD-F (52085602)**. This paving breaker includes flex handles and a fronthead bushing which accommodates a 1-1/4 in. Hex. x 6 in. long (28 mm Hex. x 152mm long) paving breaker shank.

c. **PB50AS-STD (52085578)**. This paving breaker includes a fronthead bushing which accommodates a 1-1/4 in. Hex. x 6 in. long (28mm Hex. x 152mm long) paving breaker shank, and also includes a muffler.

d. **PB50AS-STD-F (52085628)**. This paving breaker includes flex handles and a fronthead bushing which accommodates a 1-1/4 in. Hex. x 6 in. long (28 mm Hex. x 152mm long) paving breaker shank, also includes a muffler.

**2) Optional:**

a. **PB50A-OPT-A (52085560)**. This paving breaker includes a fronthead bushing which accommodates a 1-1/8 in. Hex. x 6 in. long (32mm Hex. x 152mm long) paving breaker shank.

b. **PB50A-OPT-AF (52085610)**. This paving breaker includes flex handles and a fronthead bushing which accommodates a 1-1/8 in. Hex. x 6 in. long (32mm Hex. x 152mm long) paving breaker shank.

c. **PB50AS-OPT-A (52085586)**. This paving breaker includes a fronthead bushing which accommodates a 1-1/8 in. Hex. x 6 in. long (32mm Hex. x 152mm long) paving breaker shank, and also includes a muffler.

d. **PB50AS-OPT-AF (52085636)**. This paving breaker includes flex handles and a fronthead bushing which accommodates a 1-1/8 in. Hex. x 6 in. long (32mm Hex. x 152mm long) paving breaker shank, and also includes a muffler.

e. **PB50AS-OPT-B (52085594)**. This paving breaker includes a fronthead which accommodates a 1 in. Hex. x 4-1/4 in. long (25mm Hex. x 108mm long) paving breaker shank, and also includes a muffler.

f. **PB50AS-OPT-BF (51940450)**. This Paving Breaker includes a flex handle and a fronthead which accommodates a 1 in. hex x 4-1/4 in. long (25mm hex x 108mm long) paving breaker shank and includes a muffler.

**OPTIONAL MUFFLER KIT.**

An add-on muffler kit (for paving breakers without a muffler) is available and will be furnished when specially ordered. The muffler reduces paving breaker noise lev-

els without hindering breaker performance. Refer to Section 2, Page 3 for part numbers of the available muffler kits.

## **LUBRICATION.**

A high-quality rock drill oil conforming to the physical and chemical properties outlined in the instruction manual, must be added to the operating air supply to lubricate the moving parts of the paving breakers. The method of lubrication depends on actual operating conditions and customer preference:

**NOTE: While the PB50 series breaker have a built in oil reservoir, the PB35 series breakers Do Not. They are lubricated by using a constant feed air line lubricator.**

### **▲CAUTION**

THE LUBRICATING OIL RESERVOIR BUILT INTO THE PAVING BREAKER HOUSING PLUG MUST BE CHECKED EVERY TWO HOURS AND REFILLED AS NECESSARY.

NEVER ALLOW THE LUBRICATOR TO BECOME EMPTY AS THE PARTS WILL BE DAMAGED IF THE PAVING BREAKER IS OPERATED WITHOUT LUBRICATION.

a. The oil reservoir built into the PB50 series breaker housing plug will provide proper lubrication. **It must be checked every two hours and refilled as necessary.**

b. For intermittent operation with an air supply hose no longer than 50 ft. (15 m), a compressor-mounted lubricator may be used.

c. For continuous operation during an eight hour shift, an Ingersoll-Rand® air line lubricator, or other constant-feed air line lubricator, should be installed in the air-supply line about 11.5 ft. (3.5 m) from the paving breaker.

The lubricator listed in the parts list has a capacity of 1 U.S. pint (0.47 liters) and will be furnished when it is specially ordered. To adjust an air line lubricator initially:

1 Turn the lubricator needle valve clockwise until it is completely closed, and then turn the valve counter-clockwise about 3/4 of a turn off its seat.

2 Almost immediately after starting the paving breaker, check for the presence of oil at the exhaust ports and on the paving breaker tool. When checking the paving breaker for proper lubrication, always put the tool against the work.

3 Fine-tune the lubricator needle valve to provide a light film of oil on the paving breaker tool and a fine oil mist coming from the exhaust ports. If there is blue smoke coming from the exhaust port or oil running down the tool, the paving breaker is getting too much oil. Adjust the lubricator for proper rate of feed.

d. Regardless of the method of lubrication, the lubricating oil reservoir must be filled with the correct grade of rock drill oil as frequently as is necessary to prevent any possibility of the paving breaker running dry.

e. The supply of lubricant in the housing plug reservoir should be checked every two hours of operating time.

f. The oil level in the air line lubricator should be checked at the beginning of each eight-hour shift and once during the shift.

g. Every effort must be made to avoid oil contamination from dirt or other impurities. Oil should be kept in covered containers and stored in an area that is relatively dust free.

h. Before filling the air line lubricator, the area around the filler plug should be wiped clean.



# INDEX

---

## E

EQUIPMENT, OPTIONAL, 3-1  
EQUIPMENT, STANDARD, 3-1

## G

GENERAL INFORMATION, 3-1

## I

ILLUSTRATION—FLEX HANDLE,  
PB50A—STD—F, PB50A—OPT—AF,  
PB50AS—STD—F, PB50AS—OPT—AF, 2-2  
ILLUSTRATIONS, 2-1, 2-2  
PB35A, PB35AS, PB50A, PB50AS, 2-1

## L

LUBRICATION, 3-3

## M

MUFFLER KIT, OPTIONAL, 3-2

## P

PAVING BREAKER COMBINATIONS, 3-1

## S

SAFETY, 1-1



—

PAVING BREAKER MODELS:

PB35A, PB35AS, PB50A, PB50AS

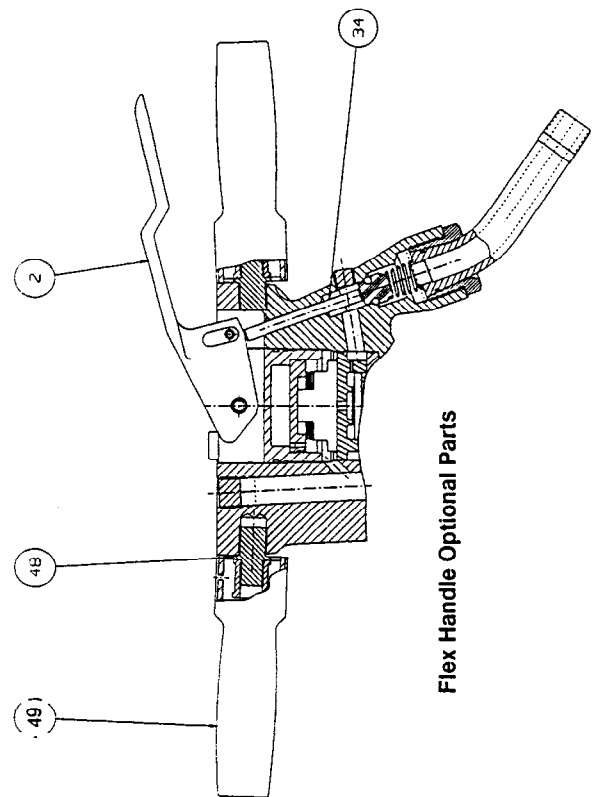

Flex Handle Optional Parts

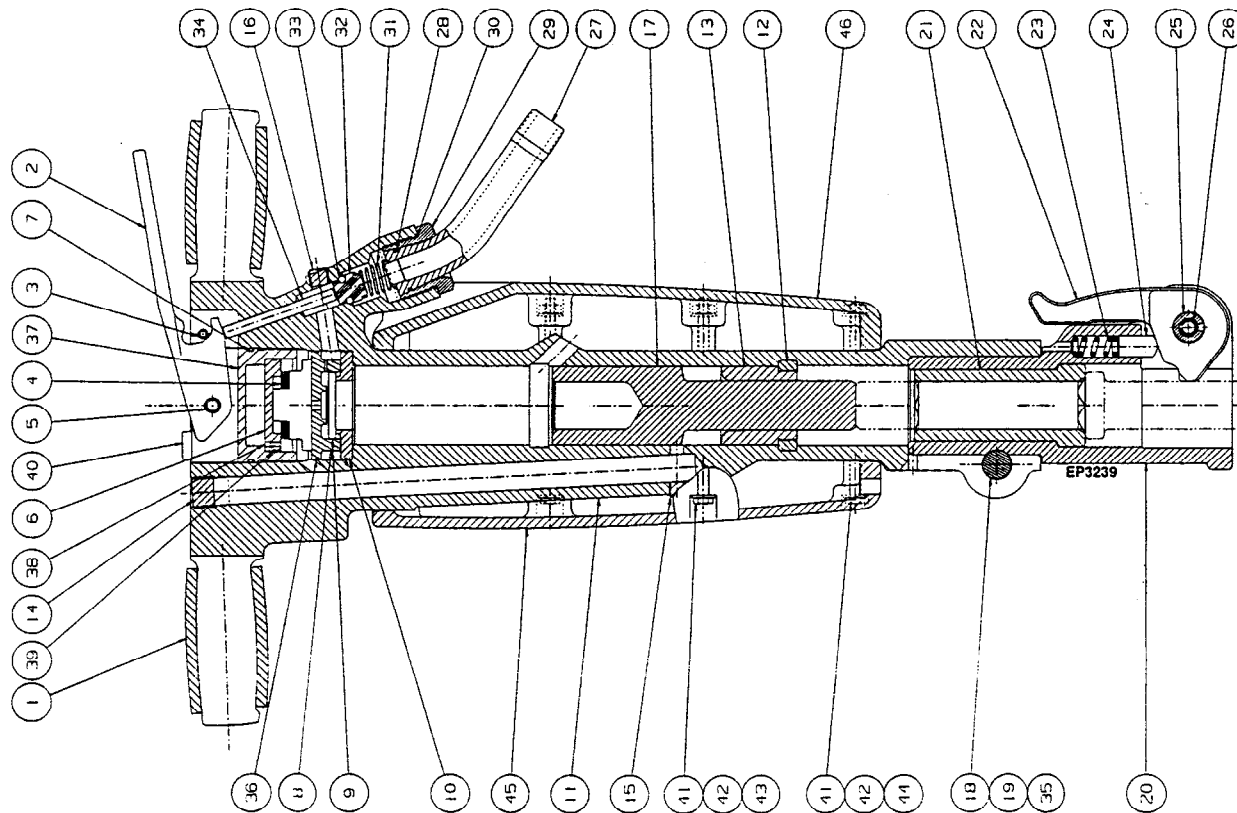

SECTIONAL ILLUSTRATION







PARTS LIST PAVING BREAKERS

REF NO	QTY	NAME OF PART	UNITED STATES		EUROPEAN COMMUNITIES										REMARKS
			PB35A 51296358	PB35AS 51357176	PB35A- OPT-A 51308609	PB35AS- OPT-A 51363687	PB50A- STD 52085552	PB50A- OPT-A 52085560	PB50AS- STD 52085578	PB50AS- OPT-A 52085586	PB50AS- OPT-B 52085594	PB50A- STD-F 52085602	PB50A- OPT-AF 52085610	PB50AS- STD-F 52085628	
37	1	HOUSING PLUG	51291375	X	X	X	51900736	X	X	X	X	X	X	X	CONVERTER KIT (PB35A)
38	1	FILTER	-	-	-	-	51905156	X	X	X	X	X	X	X	CONVERTER KIT (PB35A)
39	1	O-RING	-	-	-	-	95097754	X	X	X	X	X	X	X	CONVERTER KIT (PB35A)
40	1	OILER FILL PLUG	-	-	-	-	51919173	X	X	X	X	X	X	X	CONVERTER KIT (PB35A)
41	16	WASHER	-	95064655	-	95064655	-	-	95064655	X	X	-	-	95064655	INC. IN MUFFLER KIT
42	8	NUT	-	95467924	-	95467924	-	-	95467924	X	X	-	-	95467924	INC. IN MUFFLER KIT
43	6	SCREW	-	95838926	-	95838926	-	-	95838926	X	X	-	-	95838926	INC. IN MUFFLER KIT
44	2	SCREW	-	95673992	-	95673992	-	-	95673992	X	X	-	-	95673992	INC. IN MUFFLER KIT
45	1	RIGHT SIDE MUFFLER	NSS	X	X	X	X	X	X	X	X	X	X	X	INC. IN MUFFLER KIT
46	1	LEFT SIDE MUFFLER	NSS	X	X	X	X	X	X	X	X	X	X	X	INC. IN MUFFLER KIT
47	2	FLEX HANDLE	-	-	-	-	-	-	-	-	52084936	X	X	X	FLEX HANDLE OPTION
48	2	FLEX HANDLE STUD	-	-	-	-	-	-	-	-	51913440	X	X	X	FLEX HANDLE OPTION
49	1	HANDLE GRIP	-	-	-	-	-	-	-	-	52084902	X	X	X	FLEX HANDLE OPTION
50	1	WASHER	-	-	-	-	-	-	-	-	51948016	X	X	X	FLEX HANDLE OPTION
51	1	NUT	-	-	-	-	-	-	-	-	95914404	X	X	X	FLEX HANDLE OPTION
52	1	HANDLE	-	-	-	-	-	-	-	-	52082658	X	X	X	FLEX HANDLE OPTION
53	1	BUSHING	-	-	-	-	-	-	-	-	52091105	X	X	X	FLEX HANDLE OPTION
54	1	RETAINING RING	-	-	-	-	-	-	-	-	95955829	X	X	X	FLEX HANDLE OPTION
		<b>OPTIONS</b>													
1		FRONTHEAD ASSEMBLY	51303956	X	51304137	X	51307361	51307379	51307361	51307379	51716959	51307361	51307379	51307361	51307379
		LUBRICATOR	35364322	X	X	X	X	X	X	X	X	X	X	X	
		<b>AVAILABLE KITS (Furnished only when specially ordered)</b>													
1		TUNE-UP KIT	51310498	X	X	X	X	X	X	X	X	X	X	X	
1		STEEL RETAINER KIT	51310506	X	X	X	51358281	X	X	X	X	X	X	X	
1		MUFFLER KIT	-	51362648	-	X	-	-	X	X	X	-	-	X	X
		CONVERTER KIT PB35A CAN BE CONVERTED TO USE THE NEW STYLE OILER USING THIS OIL KIT	51955573	X	X	X	-	-	-	-	-	-	-	-	
		<b>LUBRICATION (Furnished only when specially ordered)</b>													
		1 gal	51378701	X	X	X	X	X	X	X	X	X	X	X	ROCK DRILL OIL (LIGHT)
		5 gal	51378727	X	X	X	X	X	X	X	X	X	X	X	ROCK DRILL OIL (LIGHT)
		55 gal	51378743	X	X	X	X	X	X	X	X	X	X	X	ROCK DRILL OIL (LIGHT)
		1 gal	51378693	X	X	X	X	X	X	X	X	X	X	X	ROCK DRILL OIL (MEDIUM)
		5 gal	51378719	X	X	X	X	X	X	X	X	X	X	X	ROCK DRILL OIL (MEDIUM)
		55 gal	51378735	X	X	X	X	X	X	X	X	X	X	X	ROCK DRILL OIL (MEDIUM)

(For Sectional Illustration Refer To Page 1)



NOTE: - BLANK  
X SAME AS THE NUMBER TO THE LEFT

PARTS LIST PAVING BREAKERS



		UNITED STATES		EUROPEAN COMMUNITIES												REMARKS
REF NO.	QTY	NAME OF PART	PB35A-51293358	PB35A6-51357176	PB35A-OPT-A-51306608	PB35A6-OPT-A-51363687	PB50A-STD-52085552	PB50A-OPT-A-52085560	PB50A6-STD-52085578	PB50A6-OPT-A-52085586	PB50A6-OPT-B-52085584	PB50A-STD-F-52085602	PB50A-OPT-AF-52085610	PB50A6-STD-F-52085628	PB50A6-OPT-AF-52085636	
1	2	HANDLE SLEEVE	51299212	X	X	X	51952869	X	X	X	X	-	-	-	-	
2	1	THROTTLE LEVER	51942175	X	X	X	X	X	X	X	X	-	-	-	-	STANDARD FLEX HANDLE
3	1	ROLL PIN	95034005	X	X	X	X	X	X	X	X	X	X	X	X	INC. IN TUNE-UP KIT
4	3	WASHER	51293041	X	X	X	X	X	X	X	X	X	X	X	X	INC. IN TUNE-UP KIT
5	1	ROLL PIN	95098711	X	X	X	X	X	X	X	X	X	X	X	X	INC. IN TUNE-UP KIT
6	1	OILER PLATE	-	-	-	-	51900975	X	X	X	X	X	X	X	X	CONVERTER KIT (PB35A)
7	1	O-RING	-	-	-	-	95086211	X	X	X	X	X	X	X	X	INC. IN TUNE-UP KIT CONVERTER KIT (PB35A)
8	1	VALVE CHEST	51291342	X	X	X	X	X	X	X	X	X	X	X	X	INC. IN TUNE-UP KIT CONVERTER KIT (PB35A)
9	1	VALVE	NSS	X	X	X	X	X	X	X	X	X	X	X	X	
10	1	VALVE COVER	51291359	X	X	X	X	X	X	X	X	X	X	X	X	INC. IN TUNE-UP KIT
11	1	BREAKER HOUSING	NSS	X	X	X	X	X	X	X	X	X	X	X	X	
12	1	RETAINING BUSHING	NSS	X	X	X	X	X	X	X	X	X	X	X	X	NOT SOLD SEPARATELY
13	1	PISTON SEAT	NSS	X	X	X	X	X	X	X	X	X	X	X	X	NOT SOLD SEPARATELY
14	1	PIPE PLUG	95078655	X	X	X	X	X	X	X	X	X	X	X	X	NOT SOLD SEPARATELY
15	1	PIPE PLUG	95033353	X	X	X	X	X	X	X	X	X	X	X	X	
16	1	PIPE PLUG	95033361	X	X	X	X	X	X	X	X	X	X	X	X	
17	1	PISTON	51376499	X	X	X	51381242	X	X	X	51727105	51381242	X	X	X	
18	1	BOLT	95105482	X	X	X	51356947	X	X	X	X	X	X	X	X	
19	1	NUT	95322541	X	X	X	95227112	X	X	X	X	X	X	X	X	
20	1	FRONTHEAD	51919728	X	X	X	51917532	X	X	X	51716959	51917532	X	X	X	
21	1	FRONTHEAD BUSHING	51291425	X	X	X	51306967	51307387	51306967	51307387	-	51306967	51307387	51306967	51307387	
22	1	STEEL RETAINING LEVER	NSS	X	X	X	X	X	X	X	X	X	X	X	X	INC. STEEL RETAINER KIT
23	1	SPRING	51952836	X	X	X	X	X	X	X	X	X	X	X	X	INC. STEEL RETAINER KIT
24	1	STEEL RET. LEVER PLUNGER	50019728	X	X	X	X	X	X	X	X	X	X	X	X	INC. STEEL RETAINER KIT
25	1	ROLL PIN KIT	51792794	X	X	X	51792802	X	X	X	X	X	X	X	X	INC. STEEL RETAINER KIT
26	1	ROLL PIN	NSS	X	X	X	X	X	X	X	X	X	X	X	X	NOT SOLD SEPARATELY
27	1	CONNECTION	51361855	X	X	X	51609295	X	X	X	X	X	X	X	X	NOT SOLD SEPARATELY
28	1	O-RING	95086161	X	X	X	X	X	X	X	X	X	X	X	X	
29	1	AIR CONNECTION CAP	51361798	X	X	X	X	X	X	X	X	X	X	X	X	INC. IN TUNE-UP KIT
30	1	O-RING	95086112	X	X	X	X	X	X	X	X	X	X	X	X	
31	1	SPRING	50250539	X	X	X	X	X	X	X	X	X	X	X	X	INC. IN TUNE-UP KIT
32	1	VALVE ASSEMBLY	51719615	X	X	X	X	X	X	X	X	X	X	X	X	INC. IN TUNE-UP KIT
33	1	VALVE	NSS	X	X	X	X	X	X	X	X	X	X	X	X	INC. IN TUNE-UP KIT
34	1	O-RING	NSS	X	X	X	X	X	X	X	X	X	X	X	X	NOT SOLD SEPARATELY
35	1	THROTTLE PIN	51716975	X	X	X	X	X	X	X	X	51716983	X	X	X	STD. INC. IN TUNE-UP KIT FLEX HANDLE INC. IN TUNE-UP KIT
36	1	WASHER	51948016	X	X	X	51369171	X	X	X	X	X	X	X	X	

(For Sectional Illustration Refer To Page 1)

NOTE: - BLANK  
X SAME AS THE NUMBER TO THE LEFT