

**MAINTENANCE SECTION COVERING
DAM-K48 MOUNTING PLATE KIT
for
SERIES DAA AND DAM TORQUE CONTROL WRENCHES
(use this form in conjunction with Forms P7235 and 7281)**

PART NUMBER FOR ORDERING

1	Threaded Mounting Plate Kit	DAM-K48
2	Mounting Plate Pinch Bolt	SRA010A1-69
3	Pinch Bolt Lock Washer	4U-58
4	Alignment Set Screw (3)	4UA9-561
5	Tool Retaining Ring	19915

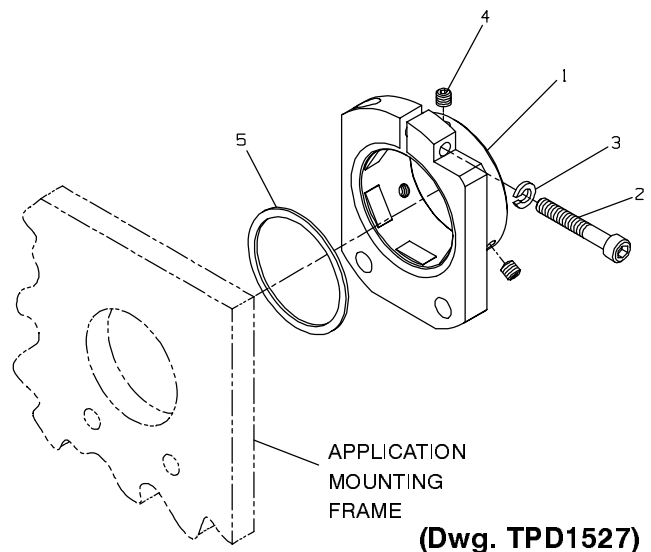

INSTALLATION

⚠ WARNING

When installing or removing a Mounting Plate Kit on a tool, **ALWAYS** hold the tool by the hex on the Gear Case while tightening the Coupling Nut. **NEVER** grasp the composite tool body or handle in vise jaws to restrain the tightening torque of the Coupling Nut. Such a practice will result in damage to the tool and with electric models will cause wire leads to malfunction creating an electric shock hazard.

NOTICE

In this first step, the Coupling Nut has a left-hand thread.

- When attaching the Mounting Plate Kit to the tool, loosen the tool Coupling Nut and separate the Spindle Housing Assembly or Angle Housing Assembly from the Gear Case Assembly of the power unit.
- Insert the Gear Case Assembly and power unit into the hub part of the Mounting Plate (1) from the counterbored end. Align and engage the hex surfaces on the Gear Case with the hex surfaces inside the hub.
- From the opposite side of the Plate, install the Tool Retaining Ring (3) over the spindle or angle housing end of the Gear Case.
- Loosely bolt the Mounting Plate in position to the application mounting frame and couple the spindle Housing Assembly or Angle housing Assembly to the Gear Case capturing the Retaining Ring between the Gear Case and Coupling Nut.
- Push the hub of the Mounting Plate forward against the Retaining Ring and snug the three Alignment Set Screws (4) against the gear Case. Alternately tighten each Screw between 25 and 30 in-lb (2.8 and 3.4 Nm) torque.
- Orient the tool to the desired position on the application mounting frame by rotating the Gear Case and Mounting Plate hub. Lock the tool in position by tightening the Mounting Plate Pinch Bolt (2) between 30 and 40 in-lb (3.4 and 4.5 Nm) torque. Also tighten the fasteners holding the Mounting Plate Kit on the application mounting frame.

Refer All Communications to the Nearest
Ingersoll-Rand Office or Distributor.

© Ingersoll-Rand Company 1996

Printed in U.S.A.

INGERSOLL-RAND®
PROFESSIONAL TOOLS