

SERIES IRBP3 PARALLEL ARM WORKSTATIONS for AIR AND ELECTRIC TOOLS

⚠ WARNING

When attaching the air line to the Workstation, the Arm could raise quickly, causing injury.
When used with electric tools, all pertinent electrical safety regulations for the tool must be adhered to when installing these Workstations.

⚠ CAUTION

Be sure the tool is assembled to the Workstation before the air line is attached.

NOTICE

Apply tape or sealant to ALL pipe threads when assembling these Workstations.

NOTICE

The use of other than genuine Ingersoll-Rand replacement parts may result in decreased tool performance and increased maintenance, and may invalidate all warranties.

Ingersoll-Rand is not responsible for customer modification of tools for applications on which Ingersoll-Rand was not consulted.

Repairs should be made only by authorized trained personnel. Consult your nearest Ingersoll-Rand Authorized Servicenter.

Specific test data, when applicable, can be found in the Special Instructions Section of this manual.

It is the responsibility of the employer to place the information in this manual into the hands of the operator.

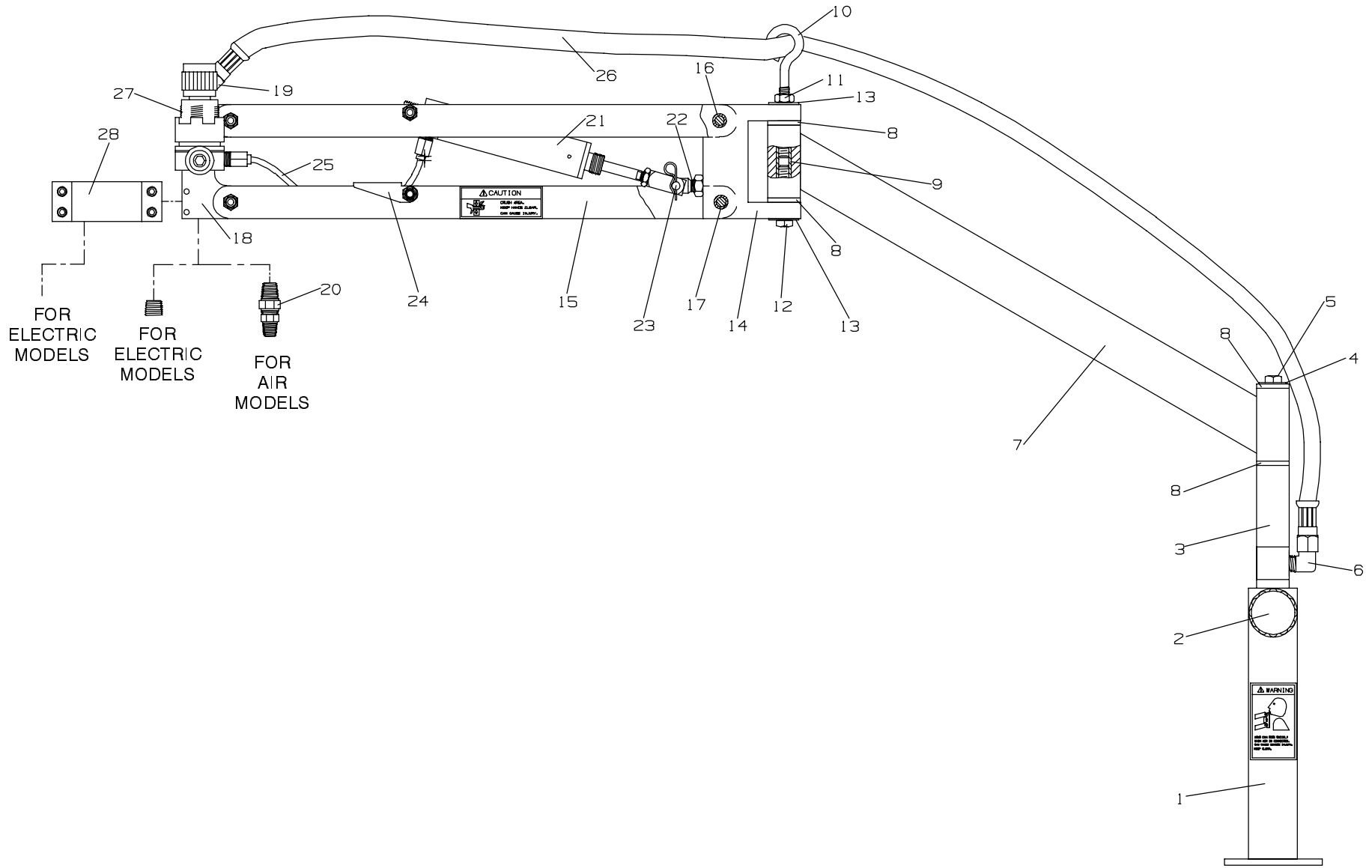

(Dwg. TPA1348)

PART NUMBER FOR ORDERING

PART NUMBER FOR ORDERING

1	Lower Post Assembly	IR49081	18	Tool Mounting Block	IR49052
2	Upper Post Locking Knob	IR48715-1	19	Air Hose Fitting (45 degree)	IR49078
3	Upper Post Assembly	IR49084	20	Pipe Nipple	---
4	Swing Arm Clamp Washer	IR49064		Cylinder Assembly	IR49082-A3
5	Swing Arm Clamp Bolt	IR49068	21	Cylinder	IR49080
6	Brass Elbow (90 degree)	IR49072		Clevis Package (includes clevis, two jam nuts, two nylon spacers and hairpin retainer)	IR49077-A1
7	Swing Arm Assembly	IR49083	22	Latch Bolt	IR49070
8	Swing Arm Bushing (4)	IR48743-1	23	Clevis Pin	IR49079
	Torque Arm Assembly	IR49082	24	Stop Latch	IR49057
	Torque Arm Attachment	IR49082-A1	25	Cylinder Hose	IR48766-2
9	Arm Mounting Bushing	IR49056	26	Air Hose Assembly	IR49092
10	Arm Upper Mounting Bolt	IR49071	27	Mini-Regulator	IR49374
+	Upper Mounting Bolt Jam Nut	---	28	Electric Tool Clamp Assembly	IR49091
+	Arm Lower Mounting Bolt	---	*	Mounting Screw and Nut Package (includes four bolts, lock nuts and threaded plug)	IR49731
+	Mounting Bolt Washer (2)	---	*	Wire Cord Holder (2)	IR48710-1
14	Link Arm Mounting Block	IR49053	*	Wire Cord Tie (2)	IR48712-1
15	Link Arm (4)	IR49055	*	Table Clamp Assembly	48732-1
*	Bushing and Spacer Package (includes spacers, bolts and nuts keeping the Link Arm joined together)	IR49082-A2			
16	Upper Block Bushing (2)	IR49054-3			
17	Lower Block Bushing (2)	IR49054-2			

* Not Illustrated.

+ Indicates parts included in the Bushing and Spacer Package (Part Number IR49082-A2).

ASSEMBLY OF THE WORKSTATION

NOTICE

Apply tape or sealant to ALL pipe threads when assembling these Workstations.

1. Bolt or clamp the Lower Post Assembly (1) to the bench top with the Upper Post Locking Knob (2) oriented toward the tool operator. The ported manifold block located on the Upper Post Assembly (3) should be oriented away from the tool operator.
2. Thread the Brass Elbow (6) into the right side port of the manifold block and tighten it so the open end is upward.
3. Remove the Swing Arm Clamp Bolt (5) and Washer (4) from the top of the Upper Post Assembly. Position the Swing Arm Assembly (7) on the shaft of the Upper Post (with the Ingersoll-Rand label right side up) and secure it with the Washer and Bolt.
4. Remove the Arm Upper Mounting Bolt (10), the Arm Lower Mounting Bolt (12), and Washers (13) from the Arm Mounting Bushing (9) in the connecting joint at the opposite end of the Swing Arm. Assemble the Torque Arm Attachment to the Swing Arm by positioning the the swing arm joint into the Link Arm Mounting Block (14) at the end of the Link Arms (15). Fasten the Block to the joint by installing the Arm Upper Mounting Bolt with a Washer and Jam Nut (11) at the top of the Arm and the Arm Lower Mounting Bolt and a Washer at the bottom of the Arm. Orient the eye of the Arm Upper Mounting Bolt so it is in line with the Link Arms, then tighten the Jam Nut.
5. Thread a 1/8" pipe nipple into the right side of the Tool Mounting Block (18). Attach the Mini-Regulator (27) so that the adjustment knob of the regulator is upward and the included hose connector is toward the Cylinder (21).
6. Push one end of the Cylinder Hose (25) onto the Mini-Regulator hose connector and the other end onto the hose connector under the Cylinder. To avoid kinking the Hose during operation of the Workstation, run the Hose between the bottom two Link Arms to the Mini-Regulator.
7. Install the 45 degree Air Hose Fitting (19) in the top of the Tool Mounting Block (18) and tighten it with the unattached end pointing toward the eye of the Arm Upper Mounting Bolt.
8. Insert one end of the Air Hose Assembly (26) through the eye of the Bolt and attach it to the Hose Fitting in the Tool Mounting Block. Attach the other end of the Hose Assembly to the 90 degree Brass Elbow in the Upper Post Assembly and tighten both connections securely.
9. Attach the tool to the Tool Mounting Block.
If the tool is an air tool, thread the tool directly onto the Pipe Nipple (20) in the Tool Mounting Block.
If the tool is an electric tool, remove the Pipe Nipple (20) and install the pipe plug furnished with the Electric Tool Clamp Assembly (28) in its place. Attach the Tool Clamp to the Block and run the tool cord through the Wire Cord Holders to the electrical supply.
10. Connect the air supply to the manifold block in the Upper Post Assembly opposite the 90 degree Elbow. We strongly urge the use of a quick disconnect coupler system when attaching the air supply.

⚠ WARNING

When attaching the air line to the Workstation, the arm could raise quickly, causing injury.