

SERIES MOO2R MULTI-VANE[®]

AIR MOTORS

Always operate, inspect and maintain this tool in accordance with American National Standards Institute Safety Code for Portable Air Tools (ANSI B186.1) and any other applicable safety codes and regulations.

⚠ WARNING

Always turn off the air supply and disconnect the air supply hose before installing, removing or adjusting any accessory on this tool, or before performing any maintenance on this tool. Failure to do so could result in injury.

FOR TOP PERFORMANCE AND MAXIMUM DURABILITY OF PARTS, OPERATE THIS TOOL AT 90 psig (6.2 bar/620 kPa) AIR PRESSURE WITH 1/4" (6 mm) AIR SUPPLY HOSE.

LUBRICATION

Oil: Ingersoll-Rand No. 10 Lubricant.

Grease: Ingersoll-Rand No. 28 Lubricant.

We recommend the use of an air line lubricator in the air supply line. Attach the unit as close to the tool as practical. Where the lubricator cannot be permanently mounted, we recommend using an Ingersoll-Rand No. NL-4 Lubricator. For permanent installations, we recommend using an Ingersoll-Rand C11-02-G00 Filter-Lubricator-Regulator unit. These units have 1/4" pipe tap inlet and outlet and 5/16 pint (148 ml) oil capacity. Larger capacity units may be used, but do not use a unit having less than a 1/4" pipe tap inlet and outlet. Adjust the lubricator so there is a slight oil mist in the exhaust.

After each forty hours of operation, or as experience indicates, remove the Gear Case Grease Screw (16) and inject 1.5 cc of the recommended grease into the opening. Do not grease excessively. Too much grease in the Gear Case (15) will cause heating. Grease leakage from the spindle end is also an indication that an excessive amount of grease has accumulated within the Gear Case.

Whenever the gear end of the Motor is disassembled, lubricate the gear train as follows:

For single reduction Motors, work approximately 15 cc of the recommended grease into the gearing and around the Bearings (31) on the Spindle (26).

For double reduction Motors, work approximately 19 cc of the recommended grease into the gear train and around the Bearings (31) on the Spindle (26).

For triple reduction Motors, work approximately 22 cc of the recommended grease into the gear train and around the Bearings (31) on the Spindle (26).

NOTICE

The use of other than genuine Ingersoll-Rand replacement parts may result in decreased Motor performance and increased maintenance, and may invalidate all warranties.

For additional repair service information, request Service Bulletin S6839 from your Ingersoll-Rand Distributor or Sales Office.

Refer All Communications to the Nearest
Ingersoll-Rand Office or Distributor.

© Ingersoll-Rand Company 1988
Printed in U.S.A.

INGERSOLL-RAND[®]
AIR MOTORS

**P
A
R
T
S

B
U
L
L
E
T
I
N**

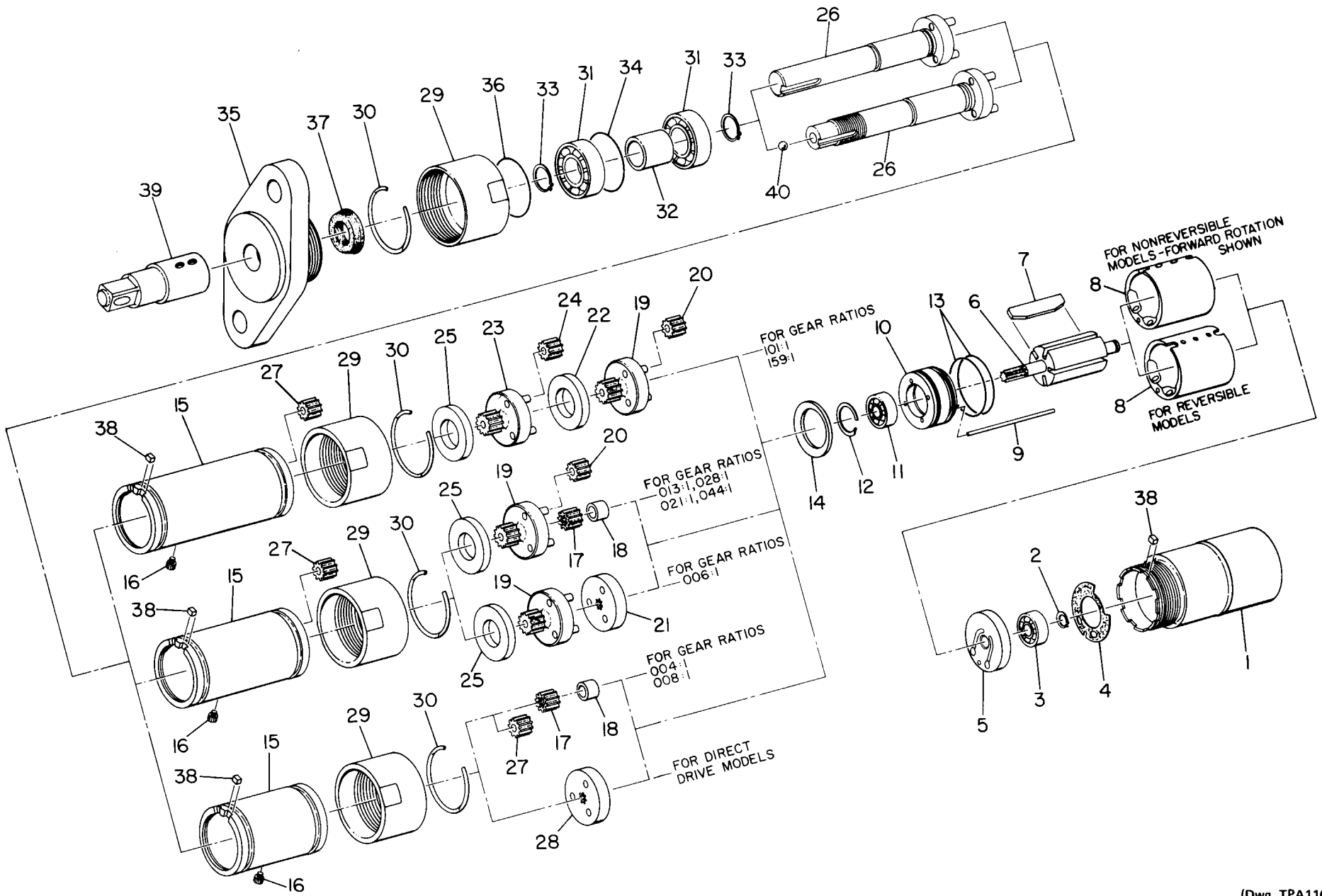

1	Motor Housing for reversible models for nonreversible models	M002-R40 M002-N40	24	Intermediate Gear Head Planet Gear (3) (for models M002RHR101AR3, M002RHR159AR3, M002RVR101AR3, M002RVR159AR3 and M002RVR159AS3) (14 teeth)	3RLM-10
2	Rear Rotor Bearing Retainer	8SL-305			
3	Rear Rotor Bearing	DG10-22			
4	Rear End Plate Gasket	3RL-739	25	Gear Head Spacer (for models M002RHR021AR3, M002RVR028AR3, M002RHR021AR3, M002RHR028AR3, M002RHR044AR3, M002RHR101AR3, M002RHR159AR3, M002RVR006AR3, M002RVR013AR3, M002RVR021AR3, M002RVR028AR3, M002RVR044AR3, M002RVR101AR3, M002RVR159AR3 and M002RVR159AS3)	3RL-80
5	Rear End Plate	M002-12			
6	Rotor	3RL-53			
7	Vane Packet (set of 5 Vanes)	3RL-42-5			
8	Cylinder for reversible models for nonreversible models	M002-R3 M002-N3			
9	Cylinder Dowel	3RL-98			
	Front End Plate Assembly	M002-A11			
10	Front End Plate	M002-11	26	Spindle for model M002RHR008AS3 for model M002RVR159AS3 for models M002RHR000AR3, M002RHR004AR3, M002RVR000AR3 and M002RVR004AR3 for models M002RHR008AR3 and M002RVR008AR3 for models M002RHR013AR3, M002RHR028AR3, M002RHR101AR3, M002RVR013AR3, M002RVR028AR3 and M002RVR101AR3 for models M002RHR006AR3, M002RHR021AR3, M002RHR044AR3, M002RHR159AR3, M002RVR006AR3, M002RVR021AR3, M002RVR044AR3 and M002RVR159AR3	M002-8-008 M002-8-0211 M002-108-004 M002-108-008 M002-108-013 M002-108-021
11	Front Rotor Bearing	DG10-22			
12	Front Rotor Bearing Retainer	3RL-13			
13	Front End Plate Seal (2)	M002-210			
14	Motor Clamp Washer	M002-207			
15	Gear Case for models M002RHR000AR3, M002RHR004AR3, M002RHR008AR3, M002RHR008AS3, M002RVR000AR3, M002RVR004AR3 and M002RVR008AR3 for models M002RHR006AR3, M002RHR013AR3, M002RHR021AR3, M002RHR028AR3, M002RHR044AR3, M002RVR006AR3, M002RVR013AR3, M002RVR021AR3, M002RVR028AR3 and M002RVR044AR3 for models M002RHR101AR3, M002RHR159AR3, M002RVR101AR3, M002RVR159AR3 and M002RVR159AS3	M002-37 M002-137 M002-237	27	Spindle Planet Gear (3) for models M002RHR008AR3, M002RVR008AR3 and M002RHR008AS3 (19 teeth) for models M002RHR004AR3, M002RHR013AR3, M002RHR028AR3, M002RHR101AR3, M002RVR004AR3, M002RVR013AR3, M002RVR028AR3 and M002RVR101AR3 (14 teeth) for models M002RHR006AR3, M002RHR021AR3, M002RHR044AR3, M002RHR159AR3, M002RVR006AR3, M002RVR021AR3, M002RVR044AR3, M002RVR159AR3 and M002RVR159AS3 (17 teeth)	M002-108-004 M002-108-008 M002-108-013 M002-108-021
16	Gear Case Grease Screw	M002-95			
17	Rotor Pinion (for models M002RHR004AR3, M002RHR013AR3, M002RHR021AR3, M002RVR004AR3, M002RVR013AR3 and M002RVR021AR3) (18 teeth)	3RLM-17			
18	Rotor Pinion Spacer (for models M002RHR004AR3, M002RHR013AR3, M002RHR021AR3, M002RVR004AR3, M002RVR013AR3 and M002RVR021AR3)	M002-80			
19	Gear Head for models M002RHR006AR3, M002RHR021AR3, M002RVR006AR3 and M002RVR021AR3 (10 teeth) for models M002RHR013AR3 and M002RVR013AR3 (18 teeth) for models M002RHR028AR3, M002RHR101AR3, M002RHR159AR3, M002RVR028AR3, M002RVR101AR3 M002RVR159AR3 and M002RVR159AS3 (18 teeth) for models M002RHR044AR3 and M002RVR044AR3 (10 teeth)	3RLN-216 3RLM-216 M002-216-028 M002-216-044	28	Spindle Drive Plate (for models M002RHR000AR3 and M002RVR000AR3)	M002-171 M002-27 M002-29 WFS182-24 M002-111 3RL-6 M002-159 M002-A580 M002-580 M002-159 M002-271 M002-561
20	Gear Head Planet Gear (3) for models M002RHR013AR3, M002RHR021AR3, M002RVR013AR3 and M002RVR021AR3 (14 teeth) for models M002RHR028AR3, M002RHR044AR3, M002RHR101AR3, M002RHR159AR3, M002RVR028AR3, M002RVR044AR3, M002RVR101AR3 M002RVR159AR3 and M002RVR159AS3 (19 teeth)	3RLM-10 3RLM-10	29	Coupling Nut (2)	M002-171
21	Gear Head Drive Plate (for models M002RHR006AR3 and M002RVR006AR3)	M002-171	30	Coupling Nut Retainer (2)	M002-27
22	Gear Head Spacer (for models M002RHR101AR3, M002RHR159AR3, M002RVR101AR3, M002RVR159AR3 and M002RVR159AS3	3RL-80	31	Spindle Bearing (2)	WFS182-24
23	Intermediate Gear Head for models M002RHR101AR3 and M002RVR101AR3 (18 teeth) for models M002RHR159AR3, M002RVR159AR3 and M002RVR159AS3 (10 teeth)	M002-216-101 M002-216-159	32	Spindle Bearing Spacer	M002-111
			33	Spindle Retaining Ring (2)	3RL-6
			34	Gear Case Seal	M002-159
			35	Flange Assembly	M002-A580
			36	Flange	M002-580
			37	Flange Seal	M002-159
			38	Spindle Seal	M002-271
			39	Flange Key (2)	M002-561
			40	Spindle Socket Adapter for M002RHR008AS3 for M002RVR159AS3	R000B2J2-212-1 R1440-212-1
				Socket Adapter Ball (for models M002RHR008AS3 and M002RVR159AS3) (as required) 1/8" diameter 9/64" diameter 5/32" diameter 3/16" diameter 7/32" diameter 9/32" diameter	AV1-255 RX1-629 2U-696 4U-31 2U-722 8U-722
			*	Shaft Key	501-410

* Not illustrated.