

**Genuine**

# Ingersoll-Rand Replacement Parts

## ST700P -TK7 TUNE-UP KIT (Pre-engaged Models)

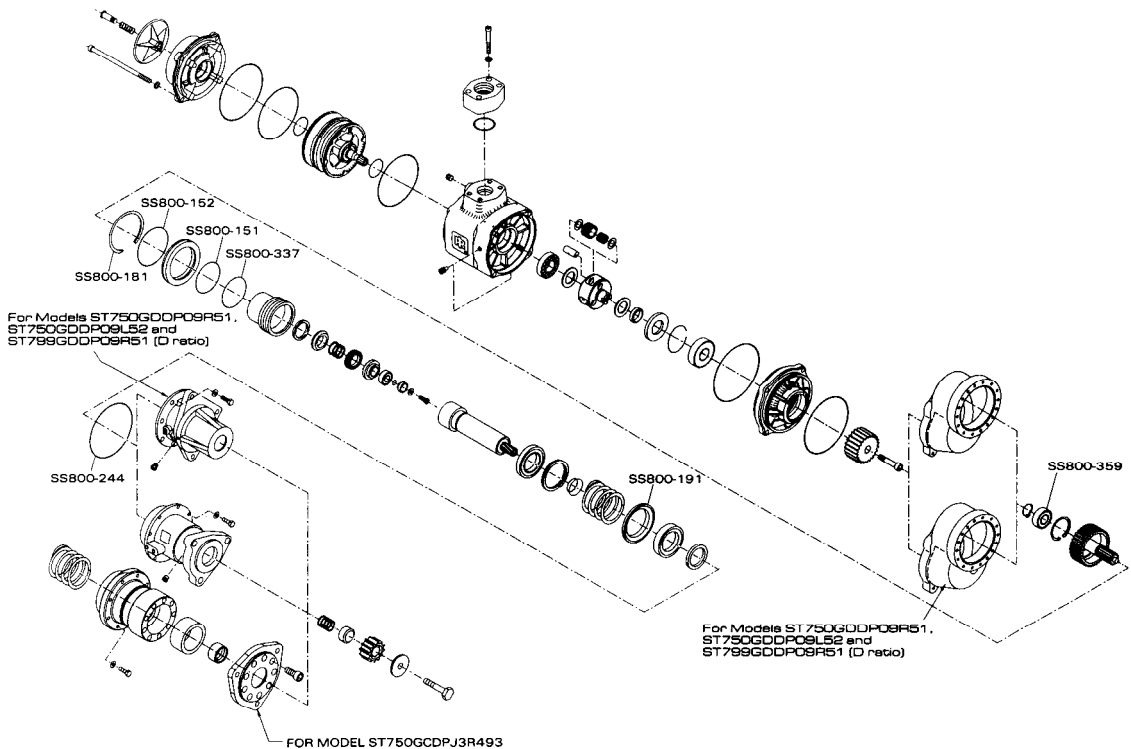

(Dwg. TPA1426)

This GENUINE Ingersoll-Rand Tune-up Kit contains the following parts:

PART NUMBER	PART NAME (Description)	QUANTITY
SS800-359	Drive Gear Bearing	1
SS800-244	Drive Housing O-ring	1
SS800-152	Outer Bulkhead O-ring	1
SS800-181	Bulkhead Retainer	1
SS800-151	Inner Bulkhead O-ring	1
SS800-337	Piston O-ring	1
SS800-191	Seat	1

For further information, refer to the following form:

Starter Model	ST700
Parts Bulletin	P6921

**INGERSOLL-RAND®**  
ENGINE STARTING SYSTEMS

Form K700P-7  
Edition 1  
03540291  
January, 1994