

**Genuine**

# Ingersoll-Rand Replacement Parts

## 150LFG-TK1 TUNE-UP KIT

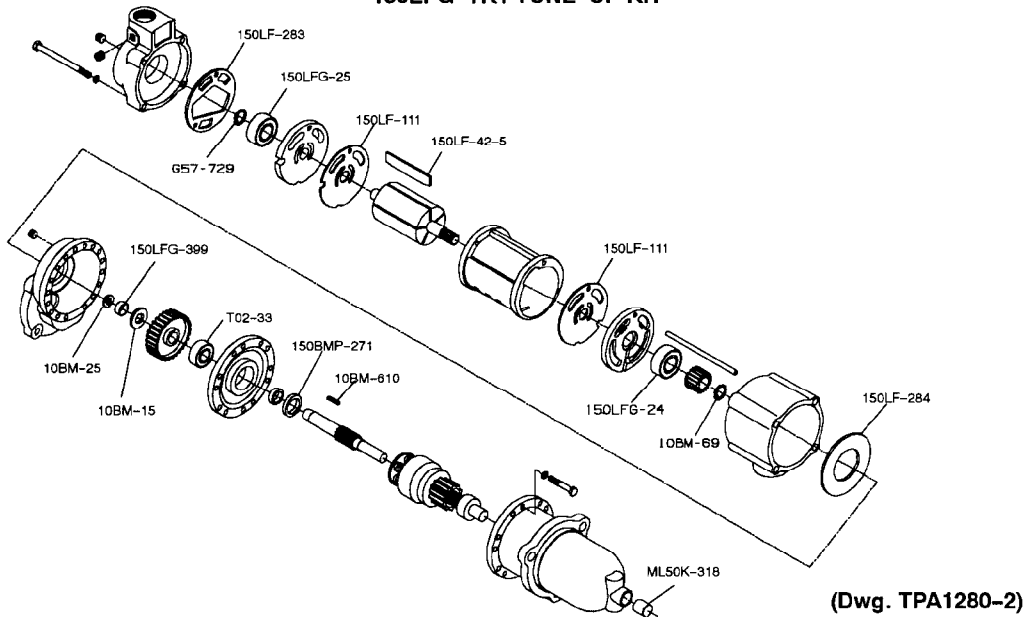

(Dwg. TPA1280-2)

This GENUINE Ingersoll-Rand Tune-up Kit contains the following parts:

PART NUMBER	PART NAME (Description)	QTY
10BM-25	Bearing Ejecting Washer (threaded washer)	1
G57-729	Rear Rotor Bearing (snap ring)	1
+ 150LFG-25	Rear Rotor Bearing (5/8" x 1-7/8" shielded bearing contains special lubricant)	1
+ 150LFG-24	Front Rotor Bearing (3/4" x 2-1/16" shielded bearing contains special lubricant)	1
150LF-283	Motor Housing Cover Gasket (perforated cork gasket)	1
150LF-42	Vane	5
150LF-111	End Plate Face	2
150LF-284	Gear Case Gasket (plain cork gasket)	1
10BM-69	Rotor Pinion Retainer ("C" ring)	1
+ 150LFG-399	Drive Shaft Rear Bearing (3/4" I.D. x 1" O.D. x 5/8" lg roller bearing contains special lubricant)	1
10BM-15	Drive Gear Thrust Washer (fiber thrust washer)	1
10BM-610	Drive Gear Key (1/4" x 1/4" x 5/8" key)	1
T02-33	Drive Shaft Front Bearing (3/4" x 1-7/8")	1
150BMP-271	Drive Shaft Grease Seal (Garlock seal)	1
ML50K-318	Drive Housing Bearing (3/4" I.D. x 1" O.D. x 3/4" lg roller bearing)	1
150BMP-283	Gasket	2
150BMP-284	Gasket	1
* SMB-431	Plastic Gasket	1

\* Not Illustrated.

+ See Form P6903 for correct disassembly and assembly of these bearings.

For further information refer to the following form.

Starter Model	150LF	150LFG
Installation and Maintenance Manual	P6904	P6904

**INGERSOLL-RAND®**  
**ENGINE STARTING SYSTEMS**

Form K6904  
Edition 4  
03537396  
March, 1998