

Genuine

Ingersoll-Rand Replacement Parts

SS800-TK2 TUNE-UP KIT

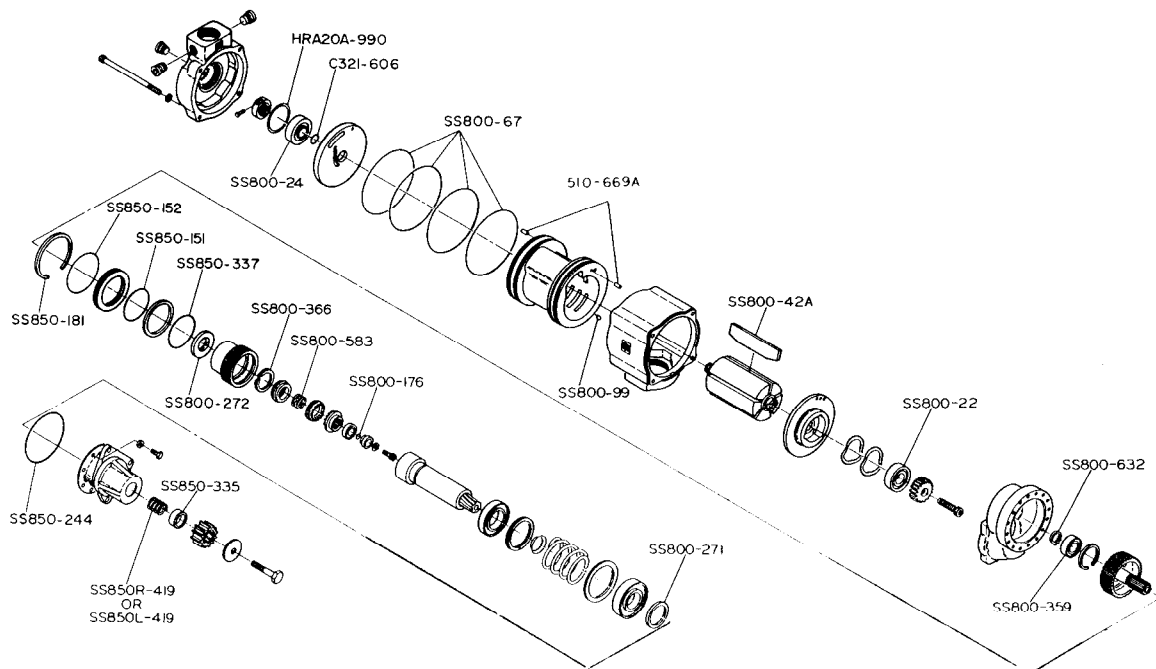

(Dwg. TPA818-2)

This GENUINE Ingersoll-Rand Tune-up Kit contains the following parts:

PART NUMBER	PART NAME (Description)	QUANTITY
HRA20A-990	Large Rear Rotor Bearing O-ring (3-5/8" dia.)	1
C321-606	Small Rear Rotor Bearing O-ring (1" dia.)	1
SS800-67	Cylinder O-ring (5-3/4" dia.)	4
SS800-244	Drive Housing O-ring (4-3/4" dia.)	1
SS800-337	Piston O-ring (3-1/4" dia.)	1
SS800-152	Outer Bulkhead O-ring (3-15/16" dia.)	1
SS800-151	Inner Bulkhead O-ring (3" dia.)	1
SS800-181	Bulkhead Retainer (4-1/2" dia. metal)	1
SS800-272	Piston Seal (2-3/8" dia. metal)	1
SS800-42A	Vane	5
SS800-99	Cylinder Alignment Pin (5/16" long)	1
SS800-359	Rear Drive Gear Bearing	1
SS800-24	Rear Rotor Bearing	1
SS800-22	Front Rotor Bearing	1
SS800-632	Drive Gear Shaft Bearing Retainer	1
SS800R-419	Pinion Spring	1
SS800L-419	Pinion Spring	1
510-669A	End Plate Alignment Pin	2
SS800-176	Drive Gear Screw O-ring	1
SS800-366	Clutch Spring Cup Retainer	1
SS800-583	Clutch Spring	1
SS800-271	Drive Housing Seal	1
SS800-335	Pinion Spring Sleeve	1

For further information refer to the following form:

Starter Model	SS800
Installation and Maintenance Manual	P6567

INGERSOLL-RAND®
ENGINE STARTING SYSTEMS

© Ingersoll-Rand Company 1993
Printed in U.S.A.

Form K6514
Edition 6
03536927
June, 1993