

Genuine

Ingersoll-Rand Replacement Parts

SM450B-TK2 TUNE-UP KIT

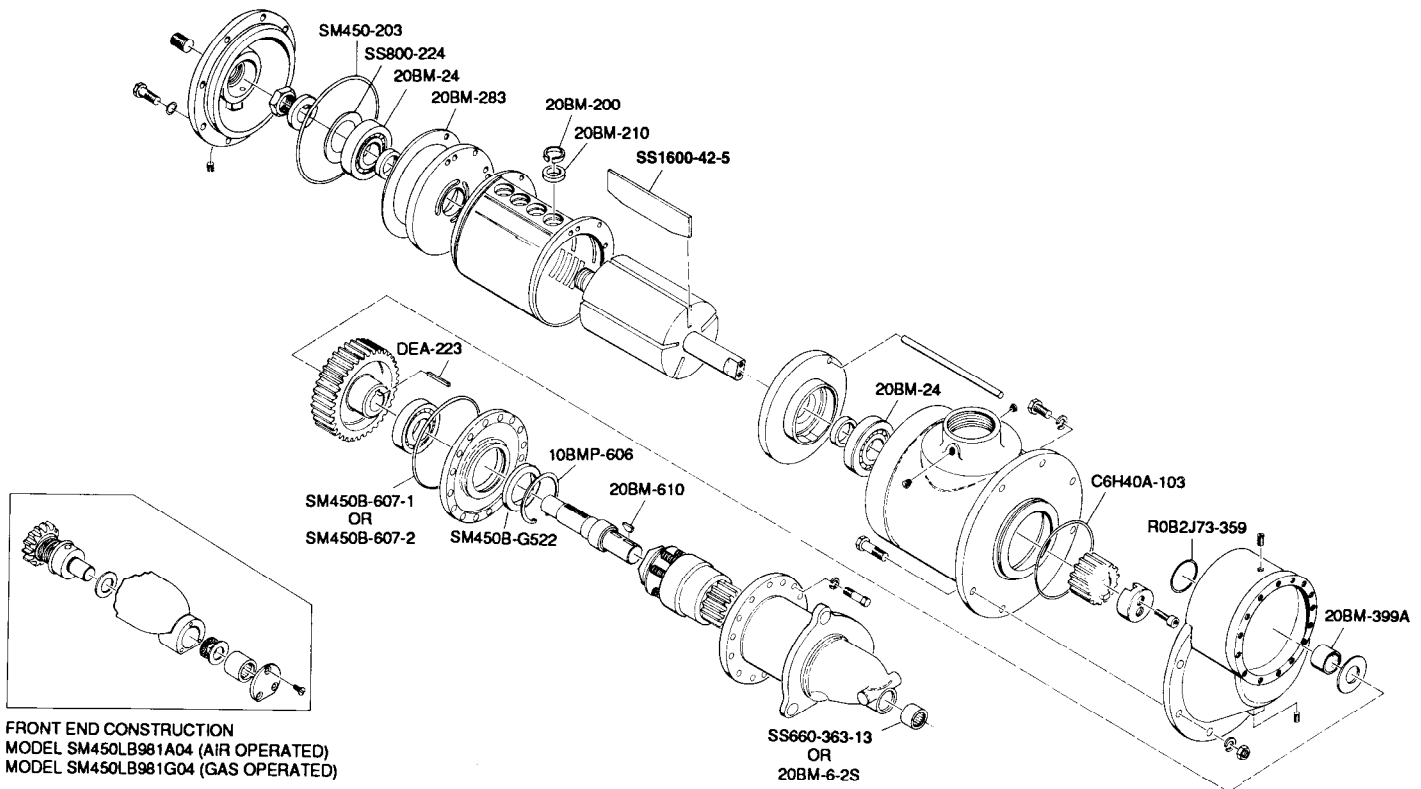

(Dwg. TPA686-5)

This GENUINE Ingersoll-Rand Tune-up Kit contains the following parts:

PART NUMBER	PART NAME (Description)	QUANTITY
SS800-224	Rear Rotor Bearing Spring Washer (2-3/4" dia. wave washer)	1
20BM-24	Rotor Bearing (1-3/16" I.D. x 2-27/32" O.D. single shielded)	2
20BM-283	Housing Cover Gasket (round cork gasket)	1
SS1600-42-5	Vane Packet	1
SM450B-607-2	Gear Case Cover Seal (6-1/4" O.D. O-ring)	1
SM450B-607-1	Gear Case Cover Seal (5-1/64" O.D. O-ring)	1
20BM-399A	Drive Shaft Rear Bearing (1" I.D. x 1-1/4" O.D. x 1" long roller type)	1
DEA-223	Drive Gear Key (1/4" x 1/4 x 1-1/2" long)	1
SM450B-G522	Drive Shaft Grease Seal (Garlock)	1
10BMP-606	Drive Shaft Grease Seal Retainer (snap ring)	1
20BM-610	Drive Shaft Key (7/8" long x 3/8" high Woodruff)	2
20BM-210	Air Port Gasket (1" O.D. x 11/16" I.D. rubber seal)	4
20BM-200	Gasket Retaining Spring (1" I.D. steel band)	4
SM450-203	Housing Cover Seal (6-17/64" O.D. O-ring)	1
C6H40A-103	Motor Housing Seal (4-1/8" O.D. O-ring)	1
ROB2J73-359	Gear Case Seal (1 7/8" O. D. O-ring)	1
20BM-6-2S	Drive Housing Bushing (bronze)	1
SS660-363-13	Drive Housing Bearing (13/16" I.D. x 1-1/16" O.D. x 1" lg roller type)	1

For further information, refer to the following form:

Starter Model	SS450B
Parts Bulletin	P6111