

PARTS LIST

MODEL 8006-A
 "000" SERIES POWER MOTOR
 64:1 REDUCTION 300 R.P.M.

FORM 3286-2

4-1-88

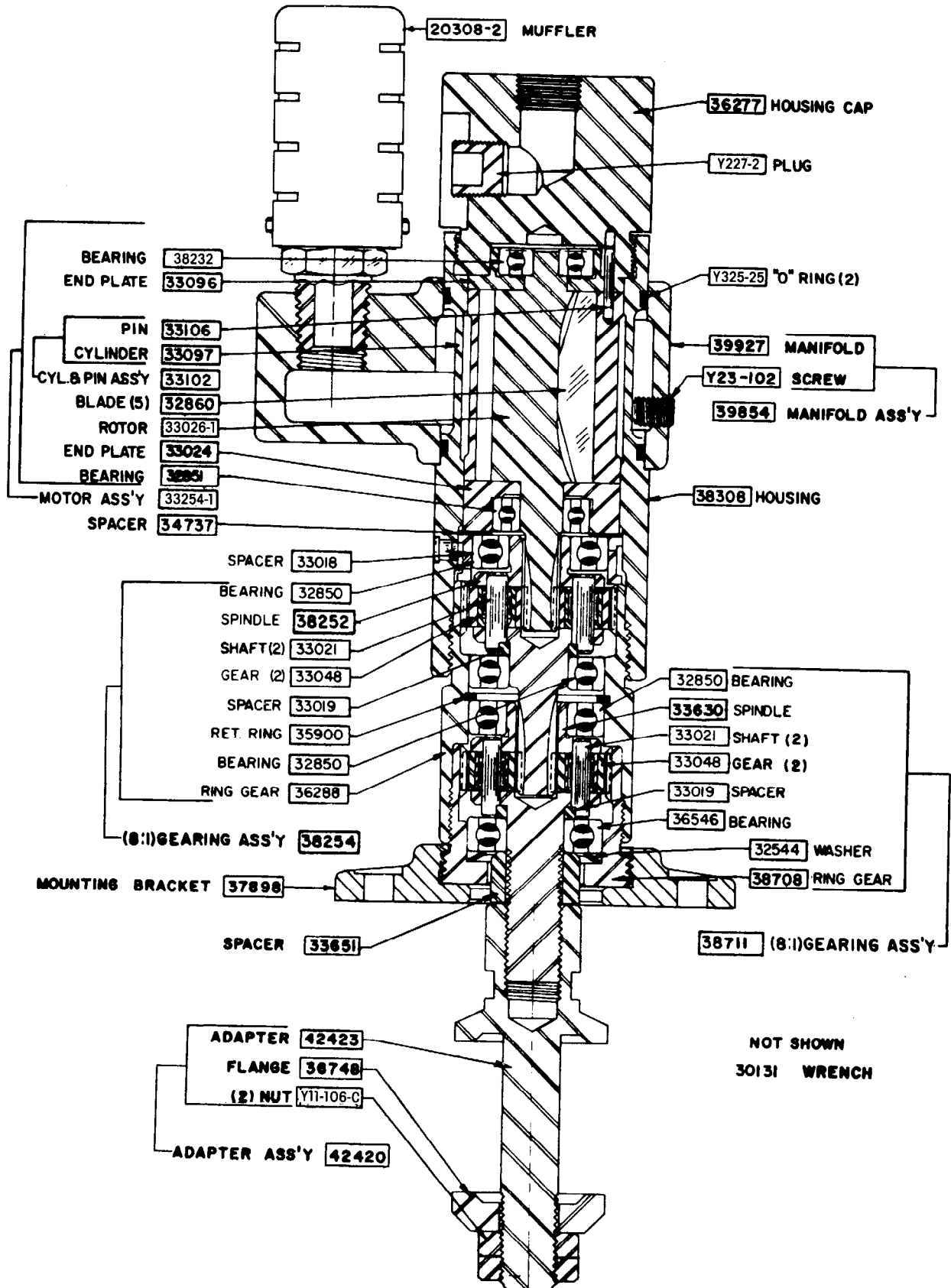

NOT SHOWN
 30131 WRENCH

AIR AND LUBE REQUIREMENTS

AIR PRESSURE OF 90 p.s.i.g. (6 bar) at the air inlet of the tool is required for maximum motor efficiency. If necessary, an air regulator should be installed to maintain this pressure when tool is in operation.

FILTERED AND OILED AIR will allow the tool to operate more efficiently and yield a longer life to operating parts and mechanisms. A line filter capable of filtering particles larger than 50 microns should be used with a line oiler.

FILTER-REGULATOR-LUBRICATOR (F-R-L) assembly model 128231-800 is recommended for use with this air tool. The capacity of this F-R-L is adequate to provide clean (40 micron) oiled and regulated air for the tool.

FLUSH TOOL with a solution of three parts cleaning solvent and one

part light oil after each 40 hours of operation. After flushing, apply a small amount of spindle oil in air inlet and run free for one minute to insure proper lubrication.

GEARING should be grease lubricated a minimum of once a month.

CAUTION: An excessive amount of lubricant in a tool will affect the speed and power. Each set of planetary gearing should contain approximately 1/16 oz. (1.8 g) of grease.

RECOMMENDED HOSE SIZE: 5/16" (8mm) nominal inside diameter.

RECOMMENDED LUBRICANTS: Spindle Oil 29665, 1 qt. (.9 liter) container for oiler and air inlet; Grease 33153, 5 lb. (2.3 kg) can for gears and bearings; "O" Ring Lubricant 36460, 4 oz. (113 g) tube for lubrication and installation of "O" rings.

MAINTENANCE

DISCONNECT AIR SUPPLY from tool or shut off air supply line to tool and exhaust (drain) air line to tool of compressed air BEFORE performing maintenance or service to tool.

AIR TOOLS are made of precision parts and should be handled with reasonable care when servicing. Excessive pressure exerted by a holding device may cause distortion of a part. Apply pressure evenly when disassembling (or assembling) parts which have a press fit. When removing or installing bearings, apply pressure to the bearing race that will be the press fit to the mating part; if this is not practiced, Brinelling of the bearing races may occur making replacement necessary. It is important that the correct tools and fixtures are used when servicing this air tool.

DISASSEMBLY should be done on a clean work bench with a clean cloth spread to prevent the loss of small parts. After disassembly is complete, all parts should be thoroughly washed in a clean solvent,

blown dry with air and inspected for wear levels, abuse and contamination. Double sealed or shielded bearings should never be placed in solvent unless a good method of re-lubricating the bearing is available. Open bearings may be washed but should not be allowed to spin while being blown dry. When REPLACEMENT PARTS are necessary, consult drawing containing the part for identification.

BEFORE REASSEMBLING, lubricate parts where required. Use 33153 grease, or equivalent, in bearings. Use 36460 lubricant for "O" ring assembly. When assembling "O" rings, or parts adjacent "O" rings, care must be exercised to prevent damage to the rubber sealing surfaces. A small amount of grease will usually hold steel balls and other small parts in place while assembling.

WHEN ORDERING PARTS, be sure to list PART NUMBER, PART NAME, MODEL NUMBER AND SERIAL NUMBER OF TOOL. USE ONLY GENUINE ARO® REPLACEMENT PARTS.

DISASSEMBLY AND REASSEMBLY OF TOOLS

DISASSEMBLY

GEARING — Both the drive and auxiliary gearing are disassembled in a similar manner. Remove adapter assembly from spindle and remove gearing from tool. Tap drive end of spindle with a non-metallic hammer to remove spindle and attached parts from ring gear. Remove bearing and shafts to remove gears from spindle.

MOTOR — Remove motor assembly from tool. Grasp cylinder in one hand and tap drive end of rotor with a non-metallic hammer; motor will come apart.

REASSEMBLY

GEARING — Assemble spacer and gears to spindle and secure with

shafts. Assemble bearings to spindle and assemble to ring gear. Assemble spacer (33018) to auxiliary gearing and spacer (33651) to drive gearing and assemble gearing to tool.

NOTE: Each set of gearing should contain approximately 1/16 oz. grease.

MOTOR — Assemble bearings into end plates and assemble end plate (33096) to rotor. Assemble cylinder over rotor to end plate. Assemble blades to rotor and assemble end plate (33024) to rotor and cylinder. Insure that motor does not bind and assemble to head and housing, aligning pin in cylinder with hole provided in head. Assemble spacer (34737) into housing.