

SALES AND ENGINEERING DATA

2200 SERIES SIDE MOUNT MILLING MOTOR MODELS 7800-4B thru 7805-4B COLLET TYPE

49999-073
Edition 2
10584928
March 2000

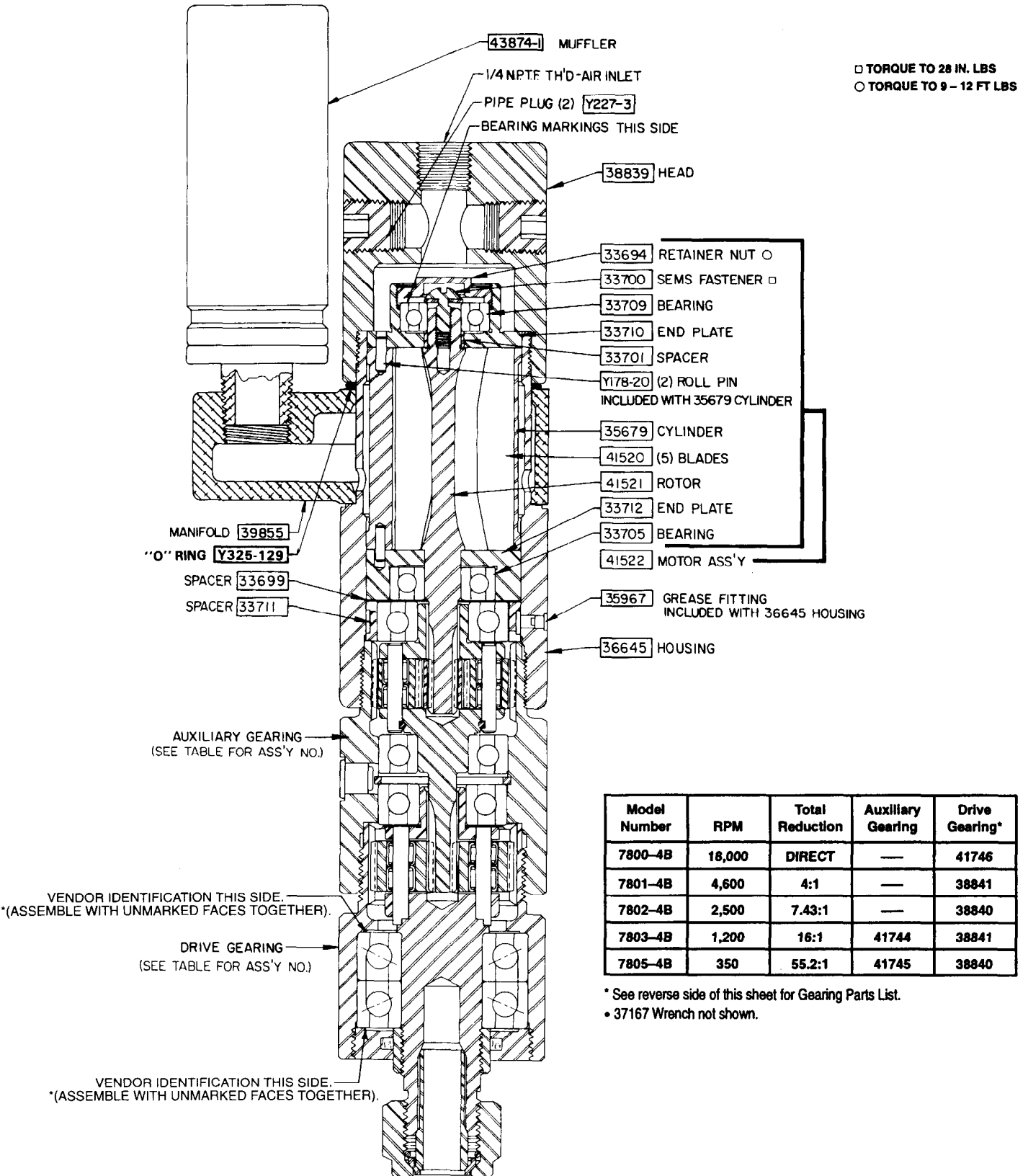

Model Number	RPM	Total Reduction	Auxiliary Gearing	Drive Gearing*
7800-4B	18,000	DIRECT	—	41746
7801-4B	4,600	4:1	—	38841
7802-4B	2,500	7.43:1	—	38840
7803-4B	1,200	16:1	41744	38841
7805-4B	350	55.2:1	41745	38840

* See reverse side of this sheet for Gearing Parts List.
• 37167 Wrench not shown.

For parts and service information, contact your local ARO distributor, or the Customer Service Dept. of the Ingersoll-Rand Distribution Center, White House, TN at PH: (615) 672-0321, FAX: (615) 672-0601.

ARO Tool & Hoist Products

Ingersoll-Rand Company
1725 U.S. No. 1 North • P.O. Box 8000 • Southern Pines, NC 28388-8000
©2000 Ingersoll-Rand Company • PRINTED IN U.S.A.

INGERSOLL-RAND
PRODUCTION EQUIPMENT

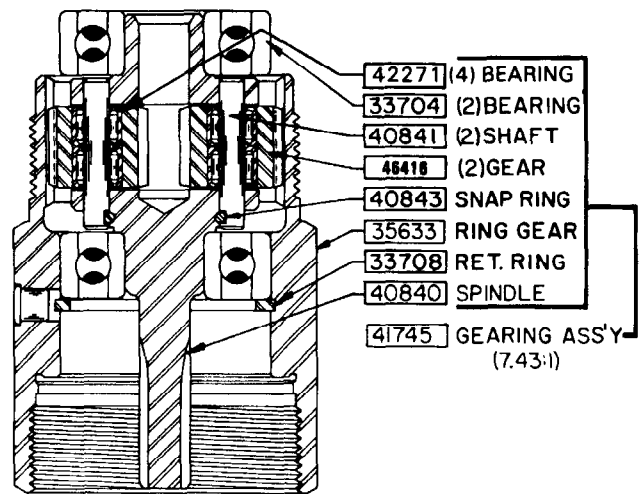
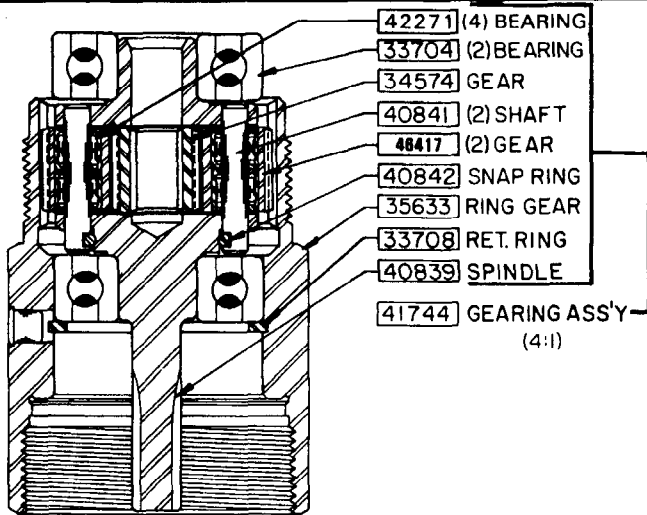

VENDOR IDENTIFICATION THIS SIDE. *(ASSEMBLE WITH UNMARKED FACES TOGETHER).

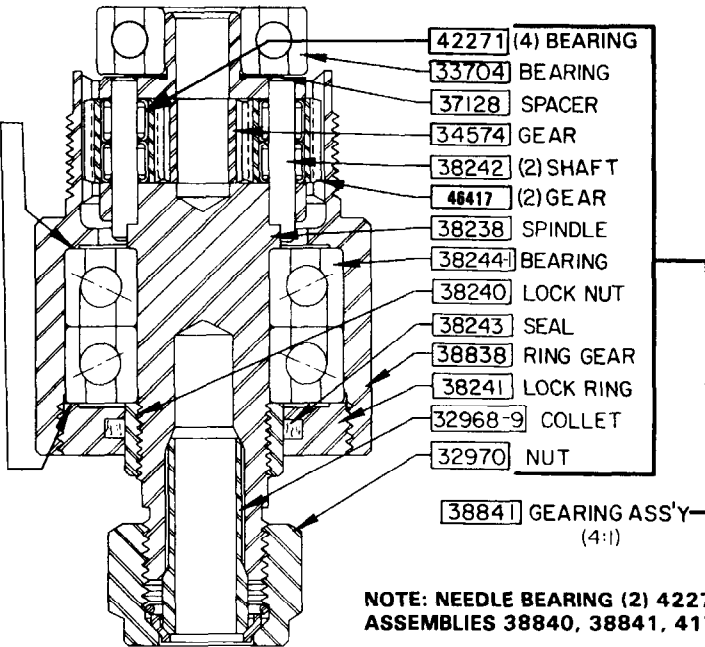

NOTE: NEEDLE BEARING (2) 42271 INCLUDED WITH GEARING ASSEMBLIES 38840, 38841, 41744 AND 41745.

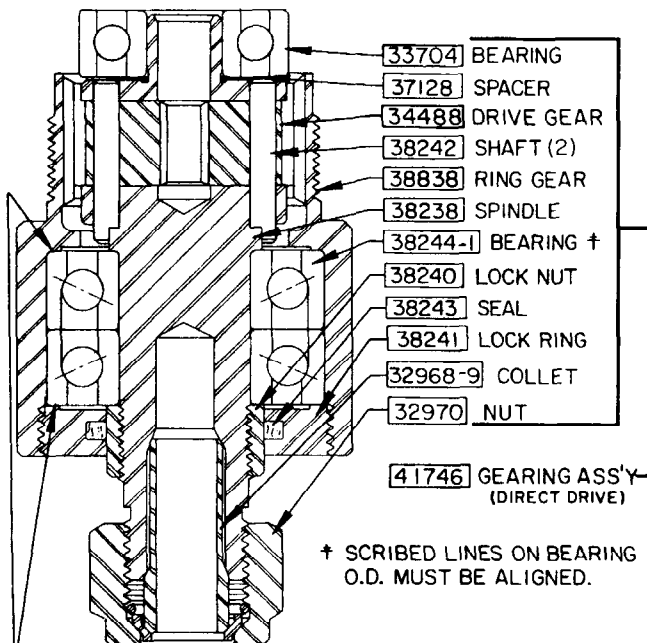

† SCRIBED LINES ON BEARING O.D. MUST BE ALIGNED.

VENDOR IDENTIFICATION THIS SIDE. *(ASSEMBLE WITH UNMARKED FACES TOGETHER).

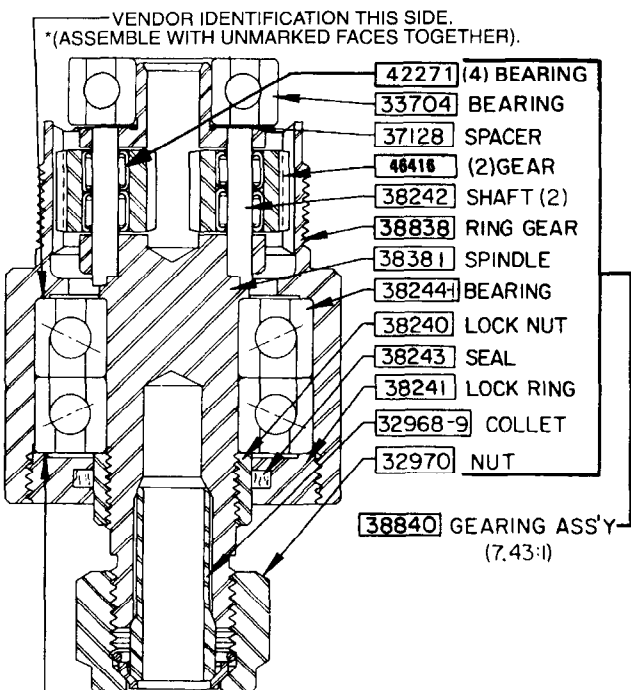

VENDOR IDENTIFICATION THIS SIDE. *(ASSEMBLE WITH UNMARKED FACES TOGETHER).