

SALES AND ENGINEERING DATA

2200 SERIES STRADDLE MILLING MOTORS MODELS 7801-3B thru 7805-3B KEYED SPINDLE

49999-031
Edition 2
10584936
March 2000

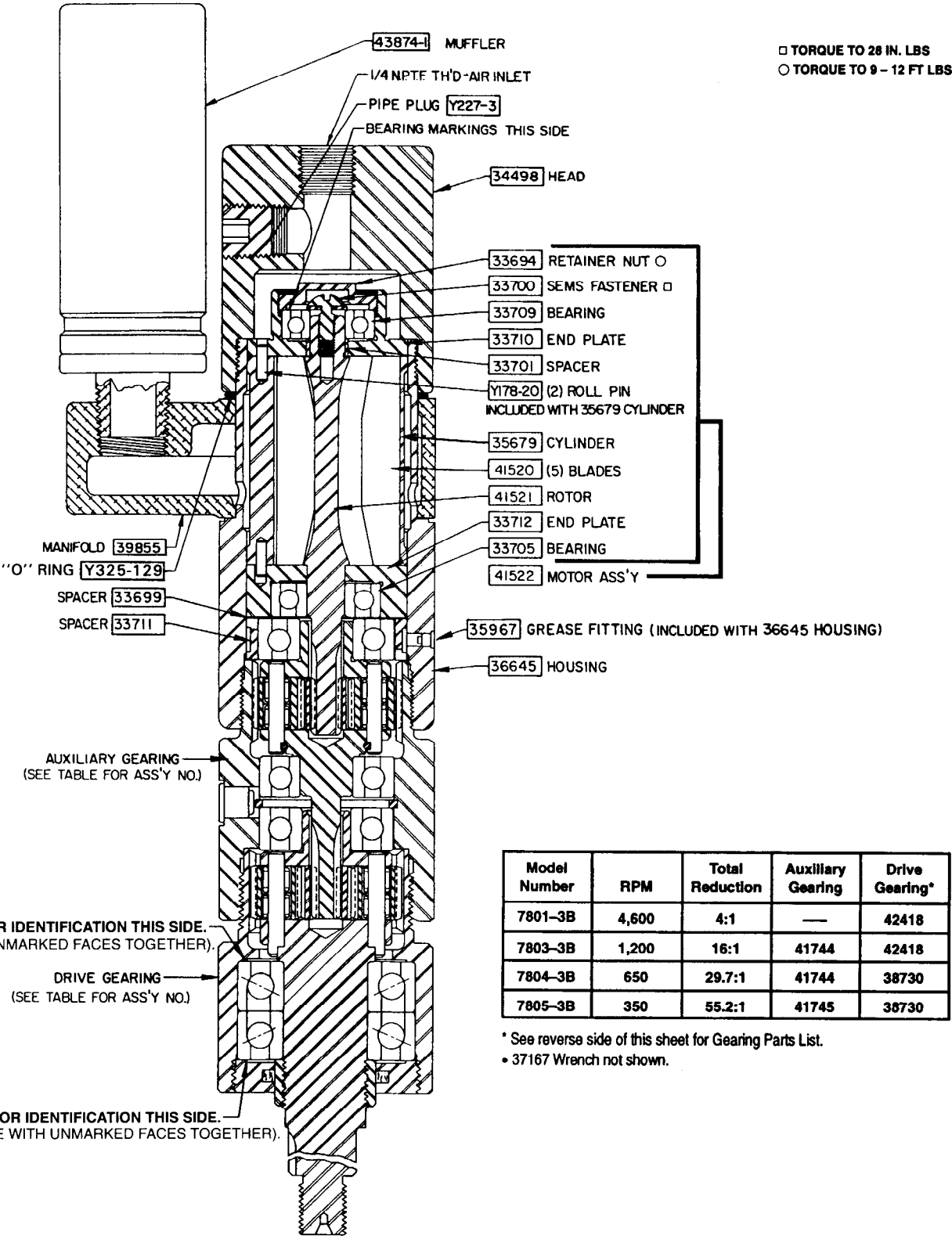

□ TORQUE TO 28 IN. LBS
○ TORQUE TO 9 - 12 FT LBS

Model Number	RPM	Total Reduction	Auxiliary Gearing	Drive Gearing*
7801-3B	4,600	4:1	—	42418
7803-3B	1,200	16:1	41744	42418
7804-3B	650	29.7:1	41744	38730
7805-3B	350	55.2:1	41745	38730

* See reverse side of this sheet for Gearing Parts List.
• 37167 Wrench not shown.

For parts and service information, contact your local ARO distributor, or the Customer Service Dept. of the Ingersoll-Rand Distribution Center, White House, TN at PH: (615) 672-0321, FAX: (615) 672-0601.

ARO Tool & Hoist Products

Ingersoll-Rand Company
1725 U.S. No. 1 North • P.O. Box 8000 • Southern Pines, NC 28388-8000
©2000 Ingersoll-Rand Company • PRINTED IN U.S.A.

INGERSOLL-RAND
PRODUCTION EQUIPMENT

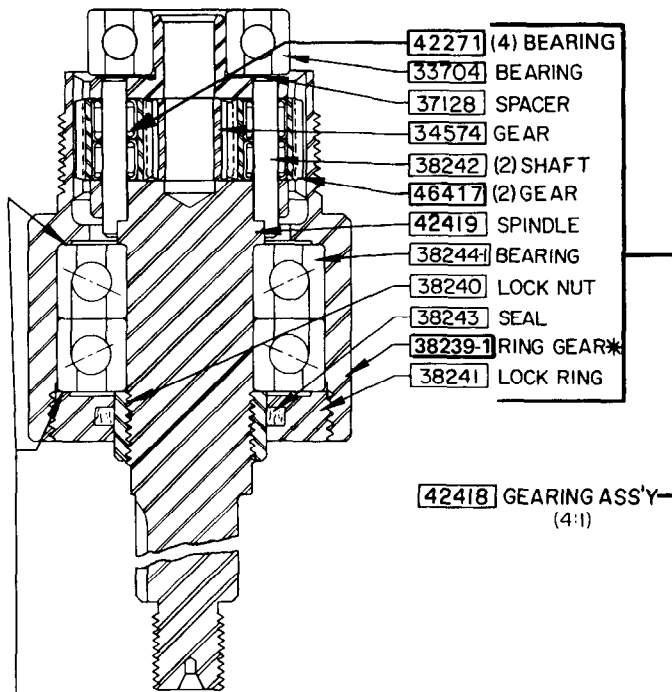
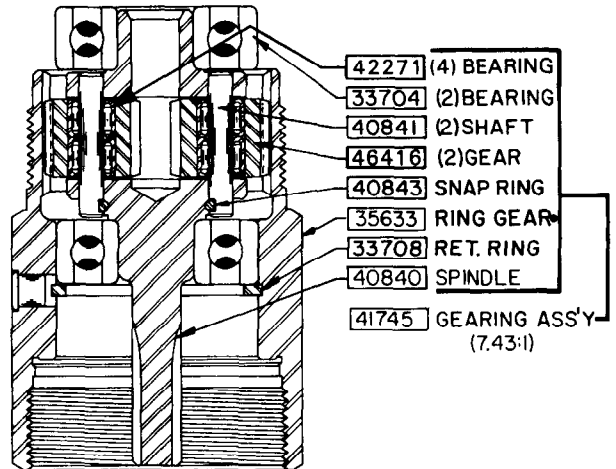
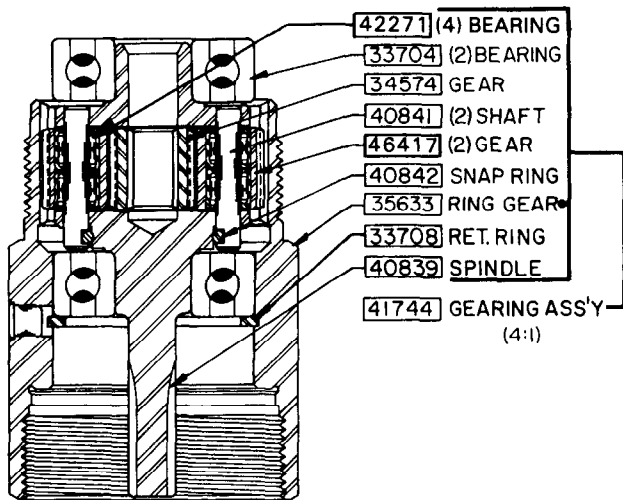

VENDOR IDENTIFICATION THIS SIDE.
 *(ASSEMBLE WITH UNMARKED
 FACES TOGETHER).

VENDOR IDENTIFICATION THIS SIDE.
 *(ASSEMBLE WITH UNMARKED FACES TOGETHER).

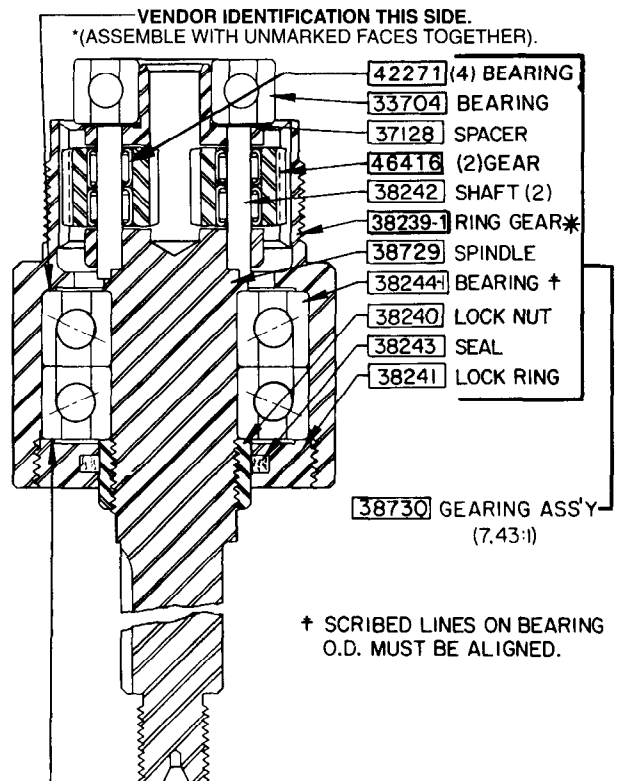

† SCRIBED LINES ON BEARING
 O.D. MUST BE ALIGNED.

VENDOR IDENTIFICATION THIS SIDE.
 *(ASSEMBLE WITH UNMARKED FACES TOGETHER).

- INCLUDES 35631 GREASE FITTING
- * INCLUDES 35967 GREASE FITTING