

Genuine

Ingersoll-Rand Replacement Parts

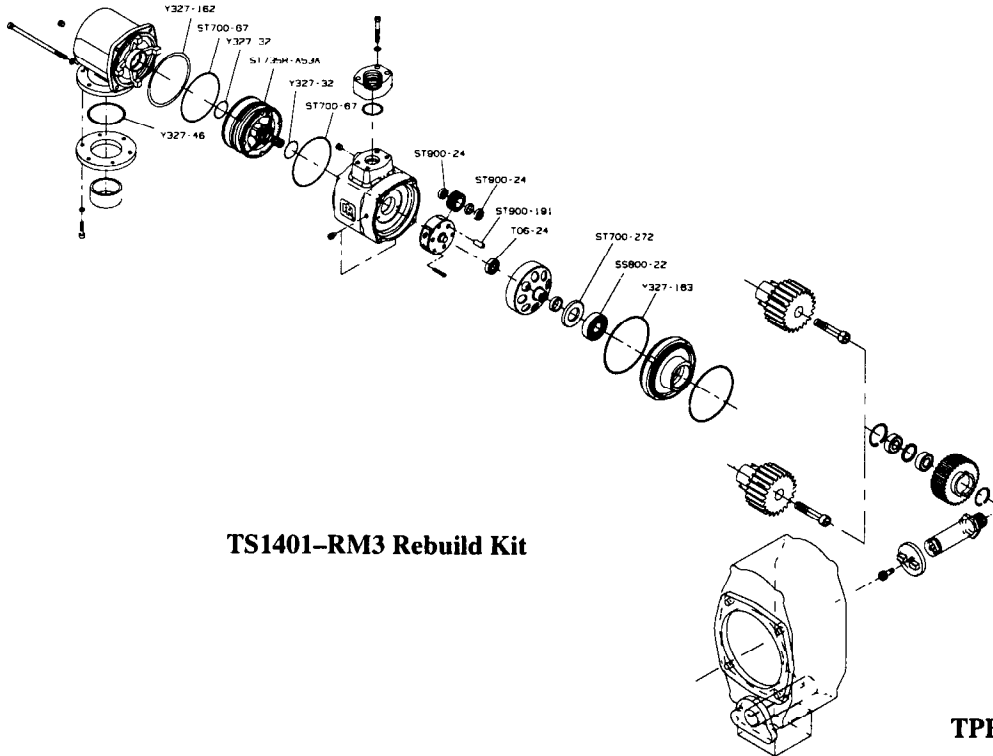

TS1401-RM3 Rebuild Kit

TPE_1012

This **GENUINE** Ingersoll-Rand Rebuild Kit contains the following parts:

PART NUMBER	PART NAME (Description)	QTY
* SMB-441	Sealant	1
SS800-22	Bearing	2
ST700-272	Seal	2
ST700-67	Cylinder O-ring Seal (5-1/2" I.D.)	4
ST735R-A53A	Motor Assembly	2
ST900-191	Idler Gear Shaft	6
ST900-24	Idler Gear Bearing	12
T06-24	Gear Frame Bearing	2
Y327-162	Exhaust Cover Seal (5-3/4" I.D.)	2
Y327-163	Rear Gear Case O-Ring (6" I.D.)	2
Y327-32	Housing O-Ring Seal (1-7/8" I.D.)	4
Y327-46	Exhaust Adapter Seal (4-1/4" I.D.)	2

* Not Illustrated.

For further information refer to the following form.

Starter Model	TS1401
Installation and Maintenance Manual	P7166

INGERSOLL-RAND®
ENGINE STARTING SYSTEMS

04657995
May, 1998